

# ANA-LPV DIAGRAM

## HOUMA - TERREBONNE AIRPORT, HOUMA, LOUISIANA

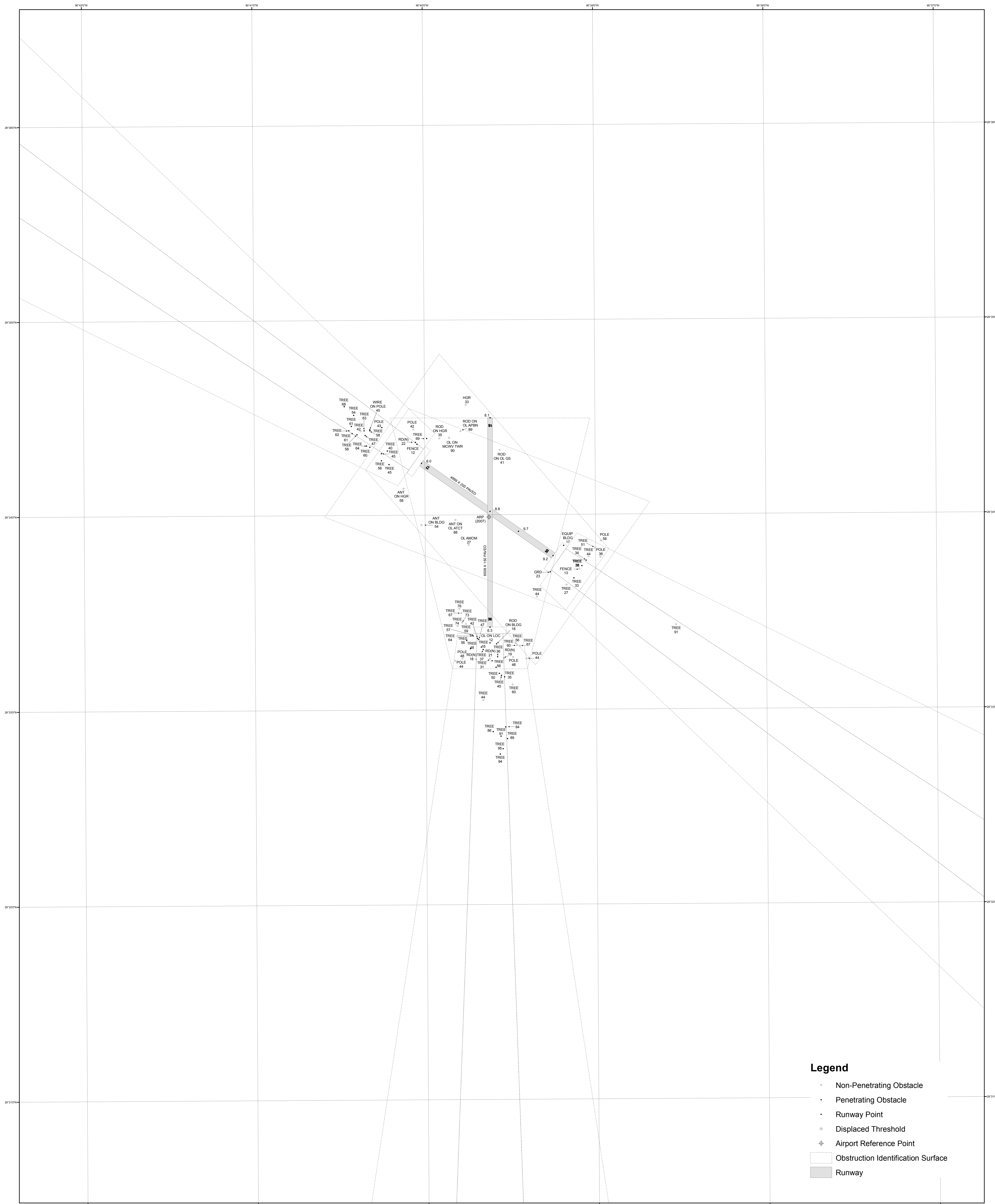

### Legend

- Non-Penetrating Obstacle
- Penetrating Obstacle
- Runway Point
- ⊖ Displaced Threshold
- ⊕ Airport Reference Point
- ▭ Obstruction Identification Surface
- ▬ Runway

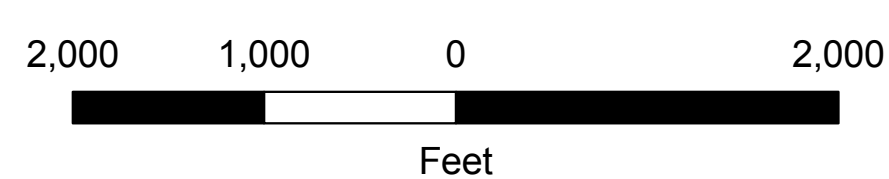

**1:12,000 SCALE**



Surveyed and compiled by the National Oceanic and Atmospheric Administration (NOAA), U.S. Department of Commerce in accordance with specifications and standards of accuracy of the Federal Aviation Administration, Department of Transportation and NOAA. This product was generated from geospatial vector files that adhered to the Data Content Standard for Airport Obstruction Chart. For more information refer to: <http://www.ngs.noaa.gov/>

Field Survey: April 17, 2007  
Date of Imagery: October 28, 2006  
Date of Release: September, 2007  
Layout Version: 1.0

ANA - LPV Diagram data is available on the Internet in the Universal Data Delivery Format at <http://www.ngs.noaa.gov>

HORIZONTAL DATUM ..... North American Datum of 1983  
VERTICAL DATUM ..... North American Vertical Datum of 1988  
PROJECTION ..... Lambert Conformal Conic  
GRID SYSTEM ..... Louisiana State Grid, South Zone  
MAGNETIC DECLINATION ..... 0.8° East

**HOUMA - TERREBONNE AIRPORT**  
**HOUMA, LOUISIANA**  
**AL 5037**