

# PARTIALLY SURVEYED TOWNSHIP 8 NORTH RANGE 10 EAST OF THE WILLAMETTE MERIDIAN, WASHINGTON

Protraction Diagram No 8 effective 08/15/1965  
File No 17, Amdt 01/13/1998

SPOKANE DISTRICT - WENATCHEE RA

STATUS OF PUBLIC DOMAIN  
LAND AND MINERAL TITLES

## MT/USE PLAT

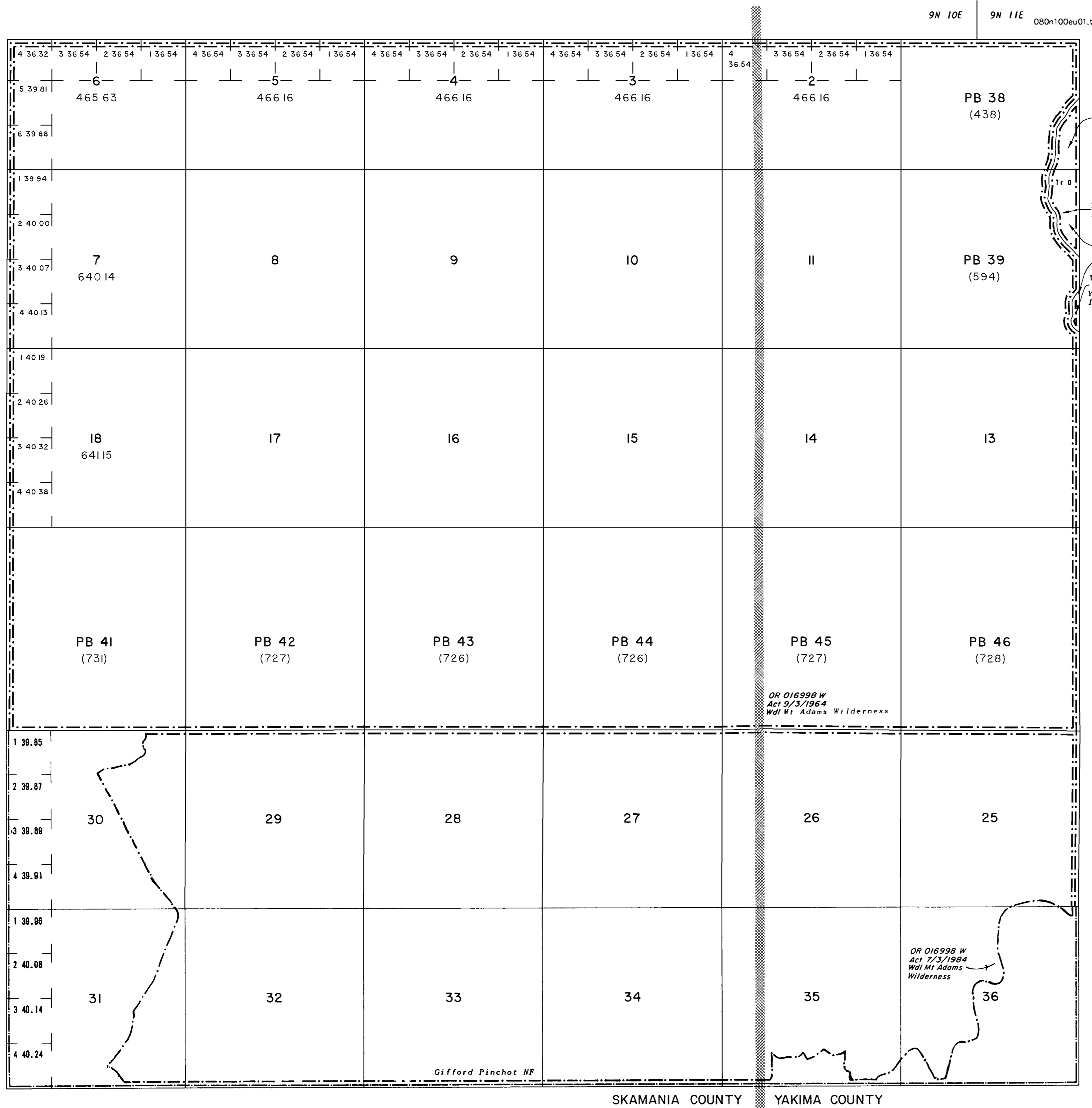

| INDEX TO SEGREGATED TRACTS |   |                 |     |             |
|----------------------------|---|-----------------|-----|-------------|
| RESURVEY                   |   | ORIGINAL SURVEY |     |             |
| TRACT NO                   | T | R               | SEC | SUBDIVISION |
|                            |   |                 |     |             |
|                            |   |                 |     |             |
|                            |   |                 |     |             |
|                            |   |                 |     |             |
|                            |   |                 |     |             |
|                            |   |                 |     |             |
|                            |   |                 |     |             |
|                            |   |                 |     |             |
|                            |   |                 |     |             |
|                            |   |                 |     |             |

FOR ORDERS AFFECTING DISPOSAL OR USE OF  
UNIDENTIFIED LANDS WITHDRAWN FOR CLASSIFICATION,  
MINERAL, WATER AND/OR OTHER PUBLIC PURPOSES,  
REFER TO INDEX OF MISCELLANEOUS DOCUMENTS

Refer to HI for PL 167, R/W, Esmt, on all lands,  
see MTP and HI for US rights on private land

|  |                                    |
|--|------------------------------------|
| FILE REF 080n100eu01.tif   | AutoCAD MAP 2000/GTX RasterCAD 6.0 |
| CONVERT JPEG 06/12/2000  | BY H GISCH                         |
| CONVERT PROTRACTION 12/24/2003   | BY D LEAVENWORTH                   |
| LAST UPDATE 12/29/2003   | BY D LEAVENWORTH                   |
| POSTED TO PUBLIC RECORDS 12/29/2003  |                                    |
| PARTIALLY SURVEYED TOWNSHIP<br>PROTRACTED COORDINATE SOURCE Cadastre ACAD Dwg<br>APD NAD 83 APPROVED 01/13/1998  |                                    |
| SURVEYED COORDINATE SOURCE<br>GCDB NAD 83 CURRENT TO N/A<br>IMAGE SOURCE SCANNED ORIGINAL MTP<br>OTHER N/A<br>PROJECTION N/A<br>COORDINATE ELEVATION N/A<br>SOURCE FOR METES & BOUNDS ORIGINAL MTP |                                    |
| NOTES  |                                    |
| USE PLAT 600   |                                    |

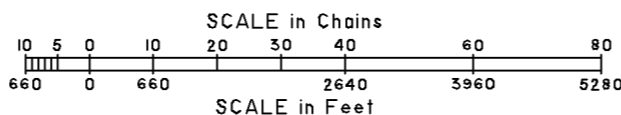

WARNING STATEMENT  
This plot is the Bureau's Record of Title, and should be used only as a graphic display of the township survey data. Records hereon do not reflect title changes which may have been affected by lateral movements of rivers or other bodies of water. Refer to the cadastral surveys for official survey information.

T 8 N  
R 10 E