



GE
159 Plastics Avenue
Pittsfield, MA 01201
USA

Transmitted Via Overnight Courier

July 20, 2007

Mr. Richard Fisher
U.S. Environmental Protection Agency
EPA - New England
One Congress Street, Suite 1100
Boston, Massachusetts 02114-2023

**Re: GE Pittsfield/Housatonic River Site
Groundwater Management Area 1 (GECD310)
Addendum to Plant Site 1 Groundwater Management Area 1
NAPL Monitoring Report for Fall 2006**

Dear Mr. Fisher:

In accordance with the General Electric Company's (GE's) approved *Baseline Monitoring Program Proposal for Plant Site 1 Groundwater Management Area* (September 2000), GE submitted a report entitled *Plant Site 1 Groundwater Management Area NAPL Monitoring Report for Fall 2006* (Report) to the U.S. Environmental Protection Agency (EPA) on February 27, 2007. That report summarized and presented the results of activities performed from July through December 2006, related to the monitoring and recovery of non-aqueous phase liquid (NAPL) at the Plant Site 1 Groundwater Management Area (GMA 1) and discussed proposed modifications to certain NAPL monitoring activities. The Report was conditionally approved by EPA in a letter to GE dated May 22, 2007. In response to requests for additional information contained in that letter, GE has prepared this Addendum to the Report, which addresses the relevant EPA conditions and, where necessary, provides revised tables and figures.

Response to EPA Conditions

EPA's May 22, 2007 conditional approval letter contained four conditions, three of which requested that additional information be submitted by GE. The first condition (Condition 1) does not require a response. GE's responses to the remaining conditions are provided below.

Condition 2

Condition 2 requests information relating to anomalous groundwater elevation data previously collected from well HR-G3-MW-1, which resulted in an apparent hydraulic depression at that location compared to other nearby wells. In addition, EPA noted a discrepancy between the groundwater elevation data presented in Table 6 (Groundwater Elevation and NAPL Thickness – Fall 2006 Monitoring Round) and the data shown in Figure 13 (Detailed Former Scrapyard Area Water Table Contour Map - Fall 2006).

As stated in the Report, well HR-G3-MW-1 was resurveyed in fall 2006 and the anomalous groundwater elevation data was attributed to usage of an incorrect measuring point elevation in the calculation of groundwater elevations. The data presented in Table 6 was not updated to take into account the corrected elevations. GE has revised that table and has attached a corrected version to this Addendum. In addition, the corrected data is included in the attached revisions of Table 1 (Monitoring Well Construction Summary),

Table 5 (Seasonal Groundwater Elevation Data and Monitoring Well Usage Summary), and Table 7 (Groundwater Elevation and NAPL Monitoring/Recovery Summary). A new version of Figure 13 is not attached, as the figure was prepared utilizing the proper groundwater elevation data, which shows that there is no hydraulic depression in that area.

Conditions 3 and 4

These conditions each discuss anomalous groundwater elevation data from certain wells at the Newell Street Area II Removal Action Area (Newell Street Area II) within GMA 1. The issues involved have been discussed in, and the results were incorporated into, GE's June 29, 2007 letter to EPA containing its Groundwater Elevation Assessment for Newell Street Area II Removal Action Area.

In Condition 3, EPA noted that Figure 14 (Detailed Newell Street Area II Water Table Contour Map – Fall 2006) displays two locations for well N2SC-09S and that the groundwater elevation data from that well is described as anomalous and subject to re-survey. EPA requested that GE evaluate the anomaly, inspect and re-survey the well, if necessary, and submit a revised figure and data tables illustrating the corrected data. Similarly, Condition 4 noted an anomaly in the groundwater elevation data with respect to well NS-10, and specified that, if necessary to address that anomaly, GE should inspect and re-survey the well.

As discussed in its June 29, 2007 letter, GE re-surveyed each of the wells and found that their measuring point elevations had changed significantly due to modifications made to the above-ground sections of the casings of these wells during Removal Actions which took place in Newell Street Area II in 2006. As requested by EPA, a revised version of Figure 14 is provided as an attachment to this letter. The corrected data are also included in the revised versions of Tables 1, 5, 6, and 7.

Upcoming Activities

GE will continue to perform its routine NAPL monitoring and recovery activities in accordance with the EPA-approved monitoring program at GMA 1. As discussed above, on June 29, 2007, GE submitted a letter report presenting the results of quarterly groundwater elevation monitoring conducted in 2006 and 2007 at Newell Street Area II. In that letter, GE proposed to revert to the prior groundwater elevation and NAPL monitoring schedule for the Newell Street Area II wells that were included in this assessment, with the exception that no additional monitoring was proposed at wells NS-9 and NS-16, which no longer exist and cannot be replaced due to the presence of an engineered barrier at those locations.

GE is currently initiating its plans to install recovery well RW-4 within the scrapyard portion of East Street Area 2–South. Field work is scheduled to be initiated during the week of July 23, 2007. Following installation, the well will be monitored on a weekly basis until the automated recovery system is installed in the well. Any recoverable NAPL that is observed will be manually removed during those monitoring events.

GE will submit the Spring 2007 NAPL Monitoring Report for GMA 1 by August 31, 2007, in accordance with the previously approved reporting schedule. That report will present the NAPL monitoring and recovery data for the period of January 2007 through June 2007, including the results of the spring 2007 semi-annual monitoring event that was conducted in April 2007.

GE plans to install replacement monitoring well O-RR and modify the casing elevations of selected monitoring wells within the 20s and 30s Complexes following completion of PEDAs grading activities in this area. Although GE had expected to install well O-RR prior to the spring 2007 semi-annual NAPL monitoring event, that installation has been delayed pending completion of PEDAs work in this area. Prior to performance of these activities, GE will provide EPA with 7 days notice to allow the assignment of field oversight personnel.

GE will continue to provide the results of ongoing NAPL monitoring and recovery efforts at GMA 1 in its monthly reports on overall activities at the GE-Pittsfield/Housatonic River Site.

Please call Andrew Silfer or me if you have any questions regarding this Addendum.

Sincerely,



Richard W. Gates
Remediation Project Manager

Attachments

cc: D. Tagliaferro, EPA
T. Conway, EPA*
H. Inglis, EPA (CD-ROM)
R. Howell, EPA*
K.C. Mitkevicius, USACE (CD-ROM)
L. Palmieri, Weston (2 hard copies & CD-ROM)
A. Symington, MDEP*
J. Rothchild, MDEP*
S. Steenstrup, MDEP (2 hard copies)
T. Angus, MDEP*
J. Ruberto, Mayor, City of Pittsfield
Pittsfield Commissioner of Public Health
T. Hickey, Director, PEDA
J. Bernstein, BCK Law
T. Bowers, Gradient
N. E. Harper, MA AG
D. Young, MA EOEA

M. Carroll, GE*
A. Silfer, GE (CD-ROM)
R. McLaren, GE*
J. Nuss, ARCADIS BBL
J. Bieke, Goodwin Procter
J. Ciampa, SPECTRA
J. Porter, Mintz, Levin
R. Nasman, Berkshire Gas
M. Booher, Leboeuf, Lamb, Greene &
MacRae, L.L.P.
I. Murarka, Ish, Inc.
K. Hylton, KHES, LLC
D. Mauro, META
Public Information Repositories
GE Internal Repositories

* cover letter only

Attachments

**Table 1
Monitoring Well Construction Summary**

**Addendum to NAPL Monitoring Report For Fall 2006
Plant Site 1 Groundwater Management Area
General Electric Company-Pittsfield, Massachusetts**

Well ID	Survey Coordinates		Ground Elevation (Feet AMSL)	Measuring Point Elevation (Feet AMSL)	Depth to Top of Screen (Feet bgs)	Screen Length (Feet)	Top of Screen Elevation (Feet AMSL)	Base of Screen Elevation (Feet AMSL)	Average Depth to Groundwater (Feet bgs)	Average Groundwater Elevation (Feet AMSL)	Till/Silt Elevation (Approximate) (Feet AMSL)
	Northing	Easting									
20s Complex											
CC	534251.19	132927.20	998.8	998.84	16.8	15	982.0	967.0	18.9	979.9	972
EE	534244.32	133101.21	1,004.5	1004.27	20	15	984.5	969.5	24.4	980.1	974
FF	534236.98	133165.10	1,005.7	1005.70	20	15	985.7	970.7	23.8	981.9	969
GG	534237.47	133226.06	1,007.4	1007.40	20	15	987.4	972.4	25.0	982.4	973
II	534294.74	132437.51	1,007.3	1007.26	20	15	987.3	972.3	26.7	980.6	973
JJ	534286.40	132524.77	1,006.4	1006.38	23	15	983.4	968.4	26.2	980.2	968
LL-R	534257.60	133170.00	1,007.7	1010.59	18	15	989.7	974.7	25.9	981.8	977
O-R	534098.79	132518.74	1,000.7	1000.42	N/A	N/A	N/A	N/A	16.0	984.7	965
P-R	534101.50	132615.40	1,003.0	1005.01	16.2	10	986.8	976.8	23.6	979.4	961
QQ-R	534174.50	132893.90	998.6	998.32	13	15	985.6	970.6	19.1	979.5	967
U	534111.32	132740.27	998.9	998.89	4	25	994.9	969.9	19.6	979.3	965
Y	534233.56	132692.64	1,002.9	1002.86	6	30	996.9	966.9	23.3	979.6	966
30s Complex											
95-15	534225.37	131091.35	986.6	986.38	7	10	979.6	969.6	8.3	978.3	966
95-16	534082.14	131773.76	1,007.9	1007.65	14	10	993.9	983.9	15.9	992.0	988
ES2-19	534344.32	131781.79	1,007.6	1,007.22	11.5	8	996.1	988.1	14.0	993.6	1,000
GMA1-10	533752.30	131312.70	985.1	984.86	5.21	15	979.9	964.9	7.7	977.4	965
GMA1-12	534218.00	131263.10	989.3	992.26	9.38	10	979.9	969.9	12.9	976.4	977
RF-02	533507.30	131111.20	983.4	982.43	3	15	980.4	965.4	6.6	976.8	965
RF-03	533872.30	131153.90	985.6	985.40	3	15	982.6	967.6	9.4	976.2	965
RF-03D	533879.30	131154.60	985.5	985.31	30.6	5	954.9	949.9	7.9	977.7	965
RF-16R	534210.60	130924.90	987.1	986.77	7.5	10	979.6	969.6	8.5	978.6	967
40s Complex											
95-17	534481.50	130679.10	1,007.6	1,007.67	20	10	987.6	977.6	22.9	984.7	983
RF-04	534714.97	130997.69	1,012.2	1,011.99	10	15	1,002.2	987.2	16.4	995.5	988
East Street Area 1-North											
25	534255.49	134362.69	1,000.7	1000.70	2	15	998.7	983.7	5.7	995.0	991
49	534248.57	134406.54	999.9	999.90	2	20	997.9	977.9	5.4	994.5	991
ESA1-52	534253.80	134565.90	999.7	999.26	2	20	997.7	977.7	5.6	994.1	990
60R	534263.60	133932.60	1,000.6	1004.03	5.41	10	995.2	985.2	7.5	993.1	985
105	534272.77	134057.88	1,002.9	1002.85	2	15	1,000.9	985.9	7.5	995.4	985
106	534277.70	134109.40	1,003.1	1004.06	3	20	1,000.1	980.1	7.1	996.0	985
107	534282.78	134160.80	1,003.9	1,003.86	2	15	1,001.9	986.9	6.8	997.1	986
108A	534336.66	134174.14	1,007.8	1,007.79	5	15	1,002.8	987.8	10.1	997.7	992

Table 1
Monitoring Well Construction Summary

Addendum to NAPL Monitoring Report For Fall 2006
Plant Site 1 Groundwater Management Area
General Electric Company-Pittsfield, Massachusetts

Well ID	Survey Coordinates		Ground Elevation (Feet AMSL)	Measuring Point Elevation (Feet AMSL)	Depth to Top of Screen (Feet bgs)	Screen Length (Feet)	Top of Screen Elevation (Feet AMSL)	Base of Screen Elevation (Feet AMSL)	Average Depth to Groundwater (Feet bgs)	Average Groundwater Elevation (Feet AMSL)	Till/Silt Elevation (Approximate) (Feet AMSL)
	Northing	Easting									
109A	534317.23	134068.87	1,005.5	1,005.43	5	15	1,000.5	985.5	8.2	997.3	988
118	534363.96	134345.23	1,001.5	1,001.50	2	8	999.5	991.5	4.3	997.2	993
120	534283.01	134356.93	1,001.3	1,001.30	2	13	999.3	986.3	5.9	995.4	992
128	534262.27	134443.76	1,001.4	1,001.41	1	14	1,000.4	986.4	6.7	994.7	991
131	534334.97	134401.77	1,001.3	1001.18	3	5	998.3	993.3	4.5	996.8	993
140	534238.61	134022.06	1,000.3	1,000.30	2	15	998.3	983.3	7.3	993.0	988
ES1-8	534257.78	134216.20	1,001.2	1,000.85	5	10	996.2	986.2	5.8	995.4	987
North Caisson	534248.54	134125.96	998.0	997.84	7.5	11	990.5	979.5	17.9	980.1	990
East Street Area 1-South											
31R	534143.90	134059.50	1,000.5	1000.23	5.5	10	995.0	985.0	9.2	991.3	991
33	534197.32	134184.99	999.5	999.50	3	20	996.5	976.5	5.6	993.9	982
34	534204.90	134261.79	999.9	999.90	3	20	996.9	976.9	5.8	994.1	983
35	534216.67	134377.60	1,000.2	1000.15	3	20	997.2	977.2	5.7	994.5	990
37R	533949.60	133932.60	989.0	988.79	7.77	10	981.3	971.3	10.2	978.8	966
45	534220.26	134405.22	1,000.1	1000.10	2	20	998.1	978.1	5.7	994.4	990
46	534223.35	134455.17	999.8	999.80	2	20	997.8	977.8	5.9	993.9	990
72	534191.24	134257.11	1,000.6	1000.62	3	20	997.6	977.6	6.6	994.0	983
72R	534196.10	134234.60	1,001.2	1000.92	4	10	997.2	987.2	6.5	994.7	988
75	534188.71	134334.44	1,000.7	1000.65	3	20	997.7	977.7	6.5	994.2	990
76	534194.27	134426.76	1,000.5	1000.45	3	20	997.5	977.5	6.9	993.6	988
78	534076.98	134253.66	997.6	997.61	2	20	995.6	975.6	3.1	994.5	982
80	134085.01	533984.21	990.00	989.98	6.5	25	983.5	958.5	5.0	985.0	N/A
89	534032.28	134341.86	993.9	993.89	1	10	992.9	982.9	2.7	991.2	984
90	134105.31	533864.14	987.70	987.65	2	13	985.7	972.7	5.8	981.9	N/A
139R	533841.60	135011.00	987.39	986.91	6	10	981.4	971.4	10.6	976.8	N/A
ES1-13	534209.68	134576.80	1,000.0	999.93	4	10	996.0	986.0	7.1	992.9	987
ES1-23R	533883.20	134539.90	987.9	989.94	4	10	983.9	973.9	2.4	985.5	<974
ES1-24	533837.41	134748.85	990.41	990.61	4	10	986.4	976.4	8.2	982.2	N/A
GMA1-6	534084.30	134455.50	1,000.7	1,000.44	5	10	995.7	985.7	8.4	992.3	985
GMA1-7	533766.80	134345.00	986.1	985.81	5.4	10	980.7	970.7	12.0	974.1	964
GMA1-18	534221.00	134872.50	998.52	998.29	4	10	994.5	984.5	6.4	991.7	N/A
South Caisson	534173.43	134432.12	1,000.5	1001.11	4	12	996.5	984.5	13.0	987.5	987

**Table 1
Monitoring Well Construction Summary**

**Addendum to NAPL Monitoring Report For Fall 2006
Plant Site 1 Groundwater Management Area
General Electric Company-Pittsfield, Massachusetts**

Well ID	Survey Coordinates		Ground Elevation (Feet AMSL)	Measuring Point Elevation (Feet AMSL)	Depth to Top of Screen (Feet bgs)	Screen Length (Feet)	Top of Screen Elevation (Feet AMSL)	Base of Screen Elevation (Feet AMSL)	Average Depth to Groundwater (Feet bgs)	Average Groundwater Elevation (Feet AMSL)	Till/Silt Elevation (Approximate) (Feet AMSL)
	Northing	Easting									
East Street Area 2-North											
05-N	534367.44	133101.83	1,009.5	1,009.23	18	10	991.5	981.5	24.6	984.9	985
11-N	534386.95	132639.74	1,011.5	1010.85	30	10	981.5	971.5	30.7	980.8	972
14-N	534368.48	133215.75	1,010.7	1010.53	24	10	986.7	976.7	23.6	987.1	988
16-N	534382.34	132782.39	1,011.0	1010.65	30	10	981.0	971.0	30.8	980.3	972
17-N	534404.43	132702.02	1,010.6	1010.49	30	10	980.6	970.6	30.2	980.4	975
17A	535187.45	132107.05	1,024.2	1,023.86	5	15	1,019.2	1,004.2	8.2	1,016.0	1,014
19-N	534406.01	132514.18	1,011.1	1010.68	30	10	981.1	971.1	30.2	980.9	977
20-N	534419.83	132465.12	1,011.2	1010.66	30	10	981.2	971.2	29.4	981.8	977
23-N	534444.85	132701.53	1,011.3	1011.13	30	10	981.3	971.3	30.7	980.6	979
24-N	534465.08	132697.89	1,011.1	1010.50	30	10	981.1	971.1	29.7	981.4	980
27-N	534625.27	132729.89	1,010.9	1010.40	25	10	985.9	975.9	25.8	985.1	987
95-12	534383.12	132689.27	1,010.4	1010.20	30	10.00	980.4	970.4	28.4	981.9	970
ES1-5	534750.38	135063.62	1,023.4	1,023.33	35	10	988.4	978.4	40.0	983.4	982
ES1-18	535027.22	133724.97	1,049.8	1,049.71	4	10	1,045.8	1,035.8	7.0	1,042.8	1,044
ES1-20	535314.82	134924.90	997.8	1,001.56	6	10	991.8	981.8	11.0	986.9	<981
ES1-27R	534603.10	134604.20	1,023.4	1,023.19	9.3	10	1,014.1	1,004.1	8.7	1,014.7	1,007
East Street Area 2-South											
01R	533928.73	133219.80	992.9	992.72	10	15	982.9	967.9	12.5	980.4	963
2	533902.02	133104.87	996.4	995.64	15	10	981.4	971.4	18.4	978.0	967
5	533817.68	132719.06	996.0	996.10	9	15	987.0	972.0	16.5	979.5	949
6	533799.18	132650.34	991.4	991.18	15	10	976.4	966.4	14.5	976.9	947
09R	533568.41	132434.78	987.3	986.88	5	15	982.3	967.3	13.1	974.2	950
10	533530.59	132376.71	988.3	987.95	10	10	978.3	968.3	14.5	973.8	957
13	533453.66	132080.55	991.3	990.88	10	20	981.3	961.3	17.1	974.2	964
14	533441.04	132035.29	992.4	991.61	10	20	982.4	962.4	18.0	974.4	964
15R	533418.19	131897.82	989.7	989.23	8	20	981.7	961.7	15.7	974.0	958
16R	533349.53	131807.57	987.2	987.10	5.9	20	981.3	961.3	11.7	975.5	951
19	532948.30	132198.00	984.1	983.59	10	15	974.1	959.1	10.7	973.4	947
25R	533997.60	133152.50	995.5	998.31	9	20	986.5	966.5	17.4	978.1	963
26RR	534111.70	133258.00	998.4	1,000.58	13	15	985.4	970.4	18.8	979.6	<970.4
28	533843.20	133276.14	991.5	991.86	15	10	976.5	966.5	13.4	978.1	958
29	533775.00	133278.82	992.1	991.59	17	10	975.1	965.1	18.5	973.6	955
30	533681.14	133124.29	990.0	989.34	14	10	976.0	966.0	12.8	977.2	960
31	533655.48	133114.65	991.0	990.60	15	10	976.0	966.0	13.7	977.2	960

**Table 1
Monitoring Well Construction Summary**

**Addendum to NAPL Monitoring Report For Fall 2006
Plant Site 1 Groundwater Management Area
General Electric Company-Pittsfield, Massachusetts**

Well ID	Survey Coordinates		Ground Elevation (Feet AMSL)	Measuring Point Elevation (Feet AMSL)	Depth to Top of Screen (Feet bgs)	Screen Length (Feet)	Top of Screen Elevation (Feet AMSL)	Base of Screen Elevation (Feet AMSL)	Average Depth to Groundwater (Feet bgs)	Average Groundwater Elevation (Feet AMSL)	Till/Silt Elevation (Approximate) (Feet AMSL)
	Northing	Easting									
32	533651.50	133032.33	991.0	990.81	9	10	982.0	972.0	12.8	978.1	965
34	533651.28	132726.36	982.5	982.54	5	10	977.5	967.5	6.5	976.0	950
35	533686.10	132606.52	983.0	982.81	5	10	978.0	968.0	8.0	975.0	943
36	533521.11	132657.53	983.5	983.02	5	10	978.5	968.5	8.8	974.7	950
37	533610.91	132816.39	980.5	980.37	5	10	975.5	965.5	6.0	974.5	960
38	533629.02	132922.84	981.4	980.77	5	10	976.4	966.4	5.7	975.7	967
40R	533758.52	133159.76	991.6	991.60	5	20	986.6	966.6	16.0	975.6	960
42	533615.04	133252.28	988.5	988.33	10	10	978.5	968.5	12.8	975.7	952
43	533534.56	133230.22	985.7	989.67	10	10	975.7	965.7	10.9	974.8	952
44	533554.95	133143.65	988.8	988.33	10	10	978.8	968.8	12.9	975.9	957
47	533769.03	133425.13	991.6	991.09	15	10	976.6	966.6	17.9	973.7	952
48	533661.94	133479.47	989.0	992.39	15	10	974.0	964.0	14.2	974.8	948
49R	533676.54	133574.30	989.1	988.71	5	20	984.1	964.1	15.4	973.7	948
49RR	533698.66	133560.68	990.0	989.80	10	15	980.0	965.0	16.2	973.8	948
50	533353.13	132665.31	986.0	985.79	4.5	20	981.5	961.5	10.2	975.8	953
51	533297.07	132548.81	985.3	985.38	4.5	20	980.8	960.8	11.6	973.7	942
52	533237.36	132442.30	985.5	985.18	4.2	20	981.3	961.3	11.5	974.0	942
53	533585.77	133562.47	987.2	986.90	8	20	979.2	959.2	13.4	973.8	947
54	533545.63	133474.93	986.1	985.78	7	20	979.1	959.1	13.3	972.8	947
55	533634.73	133502.84	987.5	989.45	7	20	980.5	960.5	14.0	973.5	947
57	533638.76	133262.06	990.1	989.80	8	20	982.1	962.1	12.9	977.2	952
58	533568.99	133374.44	986.3	985.79	8	20	978.3	958.3	13.2	973.1	948
59	533600.67	133366.09	986.8	986.32	8	20	978.8	958.8	14.8	972.0	948
ESA2S-64	533152.10	132820.00	985.1	984.98	7	15	978.1	963.1	11.6	973.5	964
64R	533771.64	133196.84	994.0	993.37	15.3	6	978.7	972.7	16.9	977.1	957
64S	533631.91	132677.26	983.5	984.48	3.5	25	980.0	955.0	15.0	968.5	947
64S-Caisson	533631.91	132677.26	983.5	984.40	N/A	N/A	N/A	N/A	N/A	974.5	N/A
64V	533608.93	133375.13	987.0	987.29	10	20	977.0	957.0	21.4	965.6	948
64X(N)	533549.89	133305.85	983.8	984.83	N/A	N/A	N/A	969.0	10.6	973.2	947
64X(S)	533472.53	133365.38	980.5	981.56	10	5	970.5	965.5	10.4	970.1	940
64X(W)	533440.04	133269.78	983.8	984.87	10	7.5	973.8	966.3	13.9	969.9	945
95-1	532972.02	131952.97	983.9	983.77	8	10	975.9	965.9	9.4	974.4	N/A
95-4R	533543.50	132537.60	985.80	988.36	10	10	975.8	965.8	11.0	974.8	N/A
95-5	533509.14	132456.06	986.8	989.45	8	10	978.8	968.8	12.1	974.7	947
95-7R	533788.30	132610.40	992.10	994.56	16.5	10	975.6	965.6	16.1	976.0	N/A

**Table 1
Monitoring Well Construction Summary**

**Addendum to NAPL Monitoring Report For Fall 2006
Plant Site 1 Groundwater Management Area
General Electric Company-Pittsfield, Massachusetts**

Well ID	Survey Coordinates		Ground Elevation (Feet AMSL)	Measuring Point Elevation (Feet AMSL)	Depth to Top of Screen (Feet bgs)	Screen Length (Feet)	Top of Screen Elevation (Feet AMSL)	Base of Screen Elevation (Feet AMSL)	Average Depth to Groundwater (Feet bgs)	Average Groundwater Elevation (Feet AMSL)	Till/Silt Elevation (Approximate) (Feet AMSL)
	Northing	Easting									
E2SC-03I	533473.03	133392.16	980.4	982.12	34.5	10	945.9	935.9	7.8	972.7	936
E2SC-17	533516.03	133454.75	983.8	985.38	36.7	10	947.1	937.1	10.4	973.3	941
E2SC-21	533227.19	132595.20	982.3	981.70	5	10	977.3	967.3	8.7	973.6	950
E2SC-23	533344.44	133132.75	990.1	992.07	9	10	981.1	971.1	14.7	975.4	955
E2SC-24	533535.46	133544.45	986.0	987.90	9	10	977.0	967.0	12.9	973.1	940
3-6C-EB-14	532899.25	132124.98	984.7	984.20	12	9.5	972.7	963.2	11.2	973.5	950
3-6C-EB-22	532909.20	131931.76	983.3	986.94	6.7	9.8	976.6	966.8	9.1	974.2	958
3-6C-EB-25	532878.30	131758.00	982.6	986.31	11.8	9.5	970.8	961.3	9.5	973.1	958
3-6C-EB-28	532872.86	131728.32	982.8	985.79	6.9	14.5	975.9	961.4	10.0	972.8	958
ES2-01	533454.42	133267.97	985.7	985.36	25	10	960.7	950.7	12.2	973.5	945
ES2-02A	533023.60	132497.90	980.2	979.63	3	15	977.2	962.2	6.6	973.6	940
ES2-05	533324.15	132017.21	990.8	990.65	9	15	981.8	966.8	16.9	973.9	963
ES2-06	533465.77	133277.92	986.3	986.00	37.5	10	948.8	938.8	12.7	973.6	943
ES2-08	533337.75	132969.67	995.3	994.87	10	15	985.3	970.3	21.4	973.9	962
ES2-09	533782.33	132501.21	991.6	991.25	10	10	981.6	971.6	13.9	977.7	955
ES2-11	533441.48	132610.85	985.8	985.05	5	15	980.8	965.8	10.0	975.8	945
ES2-16	533463.77	132335.90	987.1	986.88	10	10	977.1	967.1	10.7	976.4	960
ES2-18	533420.31	132264.62	987.1	986.86	12	22	975.1	953.1	13.1	974.0	962
GMA1-13	533785.70	133705.20	989.5	991.41	15	10	974.5	964.5	15.3	974.2	<964
GMA1-14	534006.20	132995.20	995.3	997.29	12	10	983.3	973.3	16.1	979.2	<973
GMA1-15	533257.00	132155.00	986.6	988.59	6	10	980.6	970.6	12.3	974.3	<970
GMA1-16	533167.90	132359.90	985.1	986.82	8	10	977.1	967.1	10.6	974.5	<967
GMA1-17E	533783.10	132983.90	993.4	993.03	7.5	10	985.9	975.9	15.0	978.3	<975
GMA1-17W	533784.60	134234.60	993.3	992.63	14	10	979.3	969.3	15.0	978.3	<969
GMA1-19	533102.40	132207.90	984.63	984.28	7.59	10	977.0	967.0	10.5	974.2	N/A
GMA1-20	533023.20	132361.60	983.76	983.49	7.78	10	976.0	966.0	9.9	973.8	N/A
GMA1-21	533117.60	132435.20	983.40	985.68	7.37	10	976.0	966.0	9.4	974.0	N/A
GMA1-22	533212.20	132052.80	988.74	988.45	10	10	978.7	968.7	15.1	973.6	N/A
GMA1-23	533094.40	132083.40	986.44	986.16	7	10	979.4	969.4	12.9	973.6	N/A
GMA1-24	533009.40	132194.80	984.19	983.81	6	10	978.2	968.2	11.1	973.1	N/A
HR-C-RW-1	N/A	N/A	N/A	N/A	N/A	N/A	N/A	N/A	N/A	N/A	N/A
HR-G1-MW-1	533112.00	132805.24	980.3	982.42	7.4	10	972.9	962.9	7.4	972.9	965
HR-G1-MW-2	533091.85	132769.58	978.0	980.23	15.5	10	962.5	952.5	5.1	972.9	960
HR-G1-MW-3	533046.00	132710.10	978.3	980.21	7	10	971.3	961.3	5.3	973.0	955
HR-G2-MW-1	532985.08	132603.74	979.1	982.60	3.4	10	975.7	965.7	6.2	972.9	953

Table 1
Monitoring Well Construction Summary

Addendum to NAPL Monitoring Report For Fall 2006
Plant Site 1 Groundwater Management Area
General Electric Company-Pittsfield, Massachusetts

Well ID	Survey Coordinates		Ground Elevation (Feet AMSL)	Measuring Point Elevation (Feet AMSL)	Depth to Top of Screen (Feet bgs)	Screen Length (Feet)	Top of Screen Elevation (Feet AMSL)	Base of Screen Elevation (Feet AMSL)	Average Depth to Groundwater (Feet bgs)	Average Groundwater Elevation (Feet AMSL)	Till/Silt Elevation (Approximate) (Feet AMSL)
	Northing	Easting									
HR-G2-MW-2	532962.82	132558.96	977.9	981.39	3	10	974.9	964.9	4.1	973.7	950
HR-G2-MW-3	532917.49	132477.19	984.1	987.14	8.8	10	975.3	965.3	10.8	973.2	940
HR-G2-RW-1	532955.37	132567.50	975.0	976.88	7.8	5	967.2	962.2	2.2	972.8	950
HR-G3-MW-1	532900.30	132455.10	983.7	987.10	4.1	10	979.6	969.6	10.6	973.1	940
HR-G3-MW-2	532887.95	132335.02	984.3	987.88	4.1	10	980.2	970.2	11.4	972.9	935
HR-G3-RW-1	532872.09	132399.67	976.8	977.78	7.23	2	969.6	967.6	3.6	973.2	937
HR-J1-MW-1	532859.90	131661.60	983.6	985.95	8.22	15	975.4	960.4	10.7	972.9	959
HR-J1-MW-2	532837.20	131571.10	983.7	983.56	7.92	10	975.8	965.8	10.4	973.3	952
HR-J1-MW-3	532823.10	131533.90	984.6	987.68	6.32	15	978.3	963.3	11.8	972.8	951
HR-J1-RW-1	532815.99	131580.58	975.0	975.05	12	2	963.0	961.0	2.3	972.7	952
M-R	533918.80	132612.00	995.8	998.19	15.8	10	980.0	970.0	16.1	979.7	952
P3	533662.24	133183.10	989.3	989.25	4	10	985.3	975.3	5.2	984.1	955
PZ-1S	533390.53	133214.18	990.1	989.93	13.26	5.58	976.8	971.3	17.2	972.9	950
PZ-6S	533452.92	133327.82	984.3	984.13	7.34	5.5	977.0	971.5	11.6	972.7	942
RW-1(S)	533423.56	132379.69	987.0	987.23	10	20	977.0	957.0	17.9	969.1	950
RW-1(X)	533438.75	133301.18	982.7	982.68	9	15	973.7	958.7	14.6	968.1	943
RW-2(X)	533389.37	133238.18	986.2	985.96	9	15	977.2	962.2	15.5	970.6	951
RW-3(X)	533486.57	133387.39	980.9	980.28	36	10	944.9	934.9	8.8	972.2	936
TMP-1	533798.77	133577.02	N/A	992.74	N/A	N/A	N/A	N/A	N/A	973.8	954
Lyman Street Area											
E-4	532781.86	131381.90	986.0	987.98	11.6	10	974.4	964.4	13.8	972.2	953
E-7	533184.18	131010.65	983.3	982.87	4.6	15	978.7	963.7	7.2	976.2	960
EPA-01	532404.00	130818.40	983.3	983.04	18	4	965.3	961.3	10.5	972.9	958
GMA1-5	532063.90	129887.50	979.6	979.50	3.5	10	976.1	966.1	7.4	972.2	N/A
LS-12	532544.49	130773.27	982.6	985.49	7	15	975.6	960.6	9.4	973.2	958
LS-13	532726.19	130912.04	985.1	984.65	10	15	975.1	960.1	11.3	973.8	965
LS-21	532584.70	130988.93	983.9	983.42	8	10	975.9	965.9	11.6	972.4	967
LS-24	532649.95	131080.03	986.6	986.58	10.45	11.45	976.1	964.7	13.7	972.9	961
LS-28	532643.84	130705.47	983.6	986.06	8.6	15	975.0	960.0	9.4	974.2	960
LS-29	532807.58	131047.39	988.3	988.25	24.6	10	963.7	953.7	13.1	975.2	954
LS-30	532620.97	130874.13	984.2	986.44	8.6	10	975.6	965.6	11.3	972.9	966
LS-31	532663.75	130942.01	984.9	987.09	10.6	10	974.3	964.3	11.2	973.7	965
LS-34	532547.16	130747.16	983.0	985.79	16	9.5	967.0	957.5	10.0	973.0	958
LS-38	532454.93	130852.50	984.7	986.95	12.6	10	972.1	962.1	12.3	972.4	962
LS-41	532497.23	130906.32	983.9	986.41	5.2	14.5	978.7	964.2	12.8	971.1	965

**Table 1
Monitoring Well Construction Summary**

**Addendum to NAPL Monitoring Report For Fall 2006
Plant Site 1 Groundwater Management Area
General Electric Company-Pittsfield, Massachusetts**

Well ID	Survey Coordinates		Ground Elevation (Feet AMSL)	Measuring Point Elevation (Feet AMSL)	Depth to Top of Screen (Feet bgs)	Screen Length (Feet)	Top of Screen Elevation (Feet AMSL)	Base of Screen Elevation (Feet AMSL)	Average Depth to Groundwater (Feet bgs)	Average Groundwater Elevation (Feet AMSL)	Till/Silt Elevation (Approximate) (Feet AMSL)
	Northing	Easting									
LS-43	532463.03	130718.21	981.4	981.17	16.7	9.5	964.7	955.2	7.5	973.9	956
LS-44	532395.07	130746.02	981.3	980.78	16.7	9.5	964.6	955.1	8.8	972.5	956
LSSC-06	532545.12	130828.24	983.4	984.91	8	10	975.4	965.4	10.5	972.9	965
LSSC-07	532512.42	130714.50	982.9	982.48	16	10	966.9	956.9	9.9	973.0	954
LSSC-08I	532406.30	130816.34	983.6	983.13	13	10	970.6	960.6	10.7	972.9	958
LSSC-08S	532408.89	130817.23	983.6	983.11	5	10	978.6	968.6	11.4	972.3	958
LSSC-09	532560.23	130968.42	983.4	985.06	6	10	977.4	967.4	11.2	972.1	965
LSSC-16I	532495.89	130691.87	981.6	980.88	18	10	963.6	953.6	9.2	972.4	956
LSSC-16S	532500.50	130690.30	981.5	981.37	5	10	976.5	966.5	8.6	972.9	956
LSSC-18	532664.70	131107.50	987.6	987.32	9	10	978.6	968.6	14.5	973.1	961
LSSC-32	532377.06	130590.77	980.9	980.68	26	10	954.9	944.9	8.2	972.7	949
LSSC-33	532416.27	130678.87	981.0	980.49	20	10	961.0	951.0	8.2	972.7	955
LSSC-34I	532506.10	130803.12	983.0	984.74	15	10	968.0	958.0	10.4	972.6	960
LSSC-34S	532502.63	130807.44	982.9	985.01	5	10	977.9	967.9	10.5	972.4	960
MW-3R	532488.50	130320.80	981.9	981.78	10	5	971.9	966.9	8.5	973.3	<966.9
MW-4R	532351.60	130525.40	981.2	980.82	9	5	972.2	967.2	8.2	973.0	<969.7
MW-6R	532826.50	130329.50	985.5	985.14	4	10	981.5	971.5	10.9	974.6	<971.5
RW-1	532599.66	131008.57	984.3	984.88	8	10	976.3	966.3	11.4	972.9	967
RW-1(R)	532585.81	131015.89	984.8	985.07	9.4	10	975.4	965.4	15.3	969.5	965
RW-2	532617.86	131063.93	986.0	985.92	11	10	975.0	965.0	13.7	972.3	968
RW-3	532506.39	130896.84	984.0	984.08	N/A	11	N/A	N/A	15.8	968.2	965
Newell Street Area I											
FW-16R	532907.36	132756.80	984.1	986.51	8	9.5	976.1	966.6	10.8	973.3	955
IA-9R	532749.28	132436.47	984.7	984.14	7.4	9.5	977.3	967.8	11.1	973.6	958
MM-1	532538.00	132097.40	988.3	988.04	5	10	983.3	973.3	12.2	976.2	957
Newell Street Area II											
GMA1-8	532537.20	131175.60	981.9	981.66	5.7	10	976.2	966.2	9.7	972.3	961
GMA1-9	532597.60	131346.30	979.1	982.36	7.1	10	972.0	962.0	6.3	972.8	957
GMA1-25	532475.20	131882.30	987.51	987.19	5	10	982.5	972.5	13.5	974.0	N/A
GMA1-26	532359.40	131417.30	983.73	985.53	5	10	978.7	968.7	11.9	971.8	N/A
GMA1-27	532319.70	131693.20	981.30	983.29	4	10	977.3	967.3	8.3	973.0	N/A
GMA1-28	532449.00	131306.00	981.70	983.49	4	10	977.7	967.7	10.2	971.5	N/A
MW-1D	532513.20	131501.30	984.5	987.20	21.9	14.5	962.6	948.1	11.1	973.4	950
MW-1S	532519.00	131497.20	984.6	986.60	7.9	14.5	976.7	962.2	11.1	973.5	950
N2SC-01I	532583.13	131668.56	983.60	984.99	28	7	955.6	948.6	10.9	972.7	946
N2SC-01I(R)	532577.40	131668.80	983.30	985.98	28	10	955.3	945.3	10.9	972.7	946

**Table 1
Monitoring Well Construction Summary**

**Addendum to NAPL Monitoring Report For Fall 2006
Plant Site 1 Groundwater Management Area
General Electric Company-Pittsfield, Massachusetts**

Well ID	Survey Coordinates		Ground Elevation (Feet AMSL)	Measuring Point Elevation (Feet AMSL)	Depth to Top of Screen (Feet bgs)	Screen Length (Feet)	Top of Screen Elevation (Feet AMSL)	Base of Screen Elevation (Feet AMSL)	Average Depth to Groundwater (Feet bgs)	Average Groundwater Elevation (Feet AMSL)	Till/Silt Elevation (Approximate) (Feet AMSL)
	Northing	Easting									
N2SC-02	532594.30	131592.60	983.3	985.56	26.5	10	956.8	946.8	9.7	973.6	947
N2SC-03I	532536.68	131579.89	983.53	985.33	27	10	956.5	946.5	10.3	973.3	948
N2SC-03I(R)	532538.9	131586.6	983.5	986.08	28	10	955.5	945.5	10.3	973.3	946
N2SC-07	532721.95	131582.50	982.9	984.61	25	10	957.9	947.9	10.1	972.8	948
N2SC-07S	532707.00	131599.50	983.2	982.93	8.9	10	974.3	964.3	10.3	972.9	948
N2SC-08	532481.42	131722.50	983.7	986.07	29	10	954.7	944.7	10.0	973.7	945
N2SC-09I	532443.75	131612.08	985.2	987.77	30	10	955.2	945.2	10.0	975.2	949
N2SC-09S	532438.64	131611.72	982.9	982.75	5	10	977.9	967.9	7.3	975.6	949
N2SC-13I	532549.04	131638.27	983.0	984.75	28.5	10	954.5	944.5	9.5	973.5	945
N2SC-14	532617.20	131618.23	983.40	985.06	26	10	957.4	947.4	12.6	970.8	947
NS-10	532517.43	131813.35	987.4	987.14	5	15	982.4	967.4	12.6	974.8	950
NS-15R	532699.66	131592.66	983.10	982.76	28	10	955.1	945.1	8.6	974.5	
NS-16	532561.33	131790.37	984.7	984.46	10	10	974.7	964.7	10.2	974.5	949
NS-17	532656.18	131503.34	982.0	984.64	6	10	976.0	966.0	9.5	972.5	948
NS-20	532361.30	131815.43	985.6	985.29	6	10	979.6	969.6	6.9	978.7	954
NS-32	532667.98	131618.21	983.60	986.20	28.6	9.5	955.0	945.5	9.9	973.7	946
NS-37	532786.16	132142.18	983.6	986.20	11.05	9.5	972.6	963.1	11.0	972.6	943
SILVER LAKE AREA											
SLGW-1D	534103.00	130536.10	981.2	983.13	30	5	951.2	946.2	2.6	978.6	<945.2
SLGW-1S	534100.50	130531.10	981.2	982.94	4	10	977.2	967.2	4.7	976.5	<945.2
SLGW-2D	533727.50	129779.00	983.6	985.10	30	5	953.6	948.6	5.8	977.8	<947.6
SLGW-2S	533726.00	129785.50	983.5	985.39	4	10	979.5	969.5	5.8	977.7	<947.5
SLGW-3D	533471.80	129332.90	977.2	979.14	26	5	951.2	946.2	-0.8	978.0	<945.2
SLGW-3S	533477.60	129331.10	977.6	981.21	1.5	10	976.1	966.1	1.2	976.4	<945.6
SLGW-4D	533121.90	129350.50	981.8	983.51	30	5	951.8	946.8	4.2	977.6	<945.8
SLGW-4S	533117.20	129348.30	982.0	984.02	4	10	978.0	968.0	5.7	976.3	<946
SLGW-5D	533005.60	130016.30	979.6	979.30	29	5	950.6	945.6	3.5	976.1	<945.64
SLGW-5S	533003.70	130023.50	979.8	979.12	2	10	977.78	967.78	3.7	976.1	<945.78
SLGW-6D	533313.70	131019.30	982.2	981.63	30	5	952.16	947.16	5.7	976.4	<946.16
SLGW-6S	533308.00	131017.30	982.2	981.66	4	10	978.2	968.2	5.8	976.4	<946.2

NOTES:

1. This table replaces the version contained in the Plant Site 1 Groundwater Management Area NAPL Monitoring Report for Fall 2006 .
2. The listed wells were utilized during fall 2006 for groundwater elevation/NAPL monitoring.
3. Feet AMSL: Feet above mean sea level
4. Feet bgs: Feet below ground surface
5. N/A: Information not available.

Table 5
Seasonal Groundwater Elevation Data And Monitoring Well Usage Summary

Addendum to NAPL Monitoring Report For Fall 2006
Plant Site 1 Groundwater Management Area
General Electric Company - Pittsfield, Massachusetts

Well ID	Ground Elevation (Feet AMSL)	Top of Screen Elevation (Feet AMSL)	Base of Screen Elevation (Feet AMSL)	Overall Average Groundwater Elevation (Feet AMSL)	Average Low Groundwater Elevation (Feet AMSL)	Average High Groundwater Elevation (Feet AMSL)	Till/Silt Elevation (Approximate) (Feet AMSL)	Type of Monitoring Applicable to Well in Fall 2006		
								Water Table	LNAPL	DNAPL
20s Complex										
CC	998.8	982.0	967.0	979.9	979.2	980.5	972	X	X	X
EE	1,004.5	984.5	969.5	980.1	979.5	980.7	974	X	X	X
FF	1,005.7	985.7	970.7	981.9	980.7	983.1	969	X	X	---
GG	1,007.4	987.4	972.4	982.4	982.0	982.9	973	X	X	X
II	1,007.3	987.3	972.3	980.6	979.6	981.7	973	X	X	X
JJ	1,006.4	983.4	968.4	980.2	979.2	981.1	968	X	X	X
LL-R	1,007.7	989.7	974.7	981.8	981.4	982.1	977	X	X	X
O-R	1,000.7	N/A	N/A	984.7	984.1	985.3	965	X	---	---
P-R	1,003.0	986.8	976.8	979.4	979.0	979.9	961	X	X	---
QQ-R	998.6	985.6	970.6	979.5	978.8	980.2	967	X	X	---
U	998.9	994.9	969.9	979.3	978.5	980.1	965	X	X	---
Y	1,002.9	996.9	966.9	979.6	978.7	980.4	966	X	X	X
30s Complex										
95-15	986.6	979.6	969.6	978.3	977.8	978.6	966	X	X	---
95-16	1,007.9	993.9	983.9	992.0	991.8	992.3	988	X	X	X
ES2-19	1,007.6	996.1	988.1	993.6	993.3	993.9	1,000	X	X	X
GMA1-10	985.1	979.9	964.9	977.4	977.1	977.9	965	X	X	X
GMA1-12	989.3	979.9	969.9	976.4	976.1	976.7	977	X	X	X
RF-02	983.4	980.4	965.4	976.8	976.4	977.3	965	X	X	X
RF-03	985.6	982.6	967.6	976.2	975.8	976.1	N/A	X	X	---
RF-03D	985.5	954.9	949.9	977.7	977.6	977.7	N/A	---	---	---
RF-16R	987.1	979.6	969.6	978.6	978.5	979.0	967	X	X	---
40s Complex										
RF-04	1,012.2	1,002.2	987.2	995.5	994.1	997.4	988	X	X	X
95-17	1,007.6	987.6	977.6	984.7	983.5	983.7	983	X	X	X
East Street Area 1-North										
25	1,000.7	998.7	983.7	995.0	994.7	995.1	991	X	X	X
49	999.9	997.9	977.9	994.5	994.2	994.8	991	X	X	X
ESA1N-52	999.7	997.7	977.7	994.1	994.1	994.4	990	X	X	X
60R	1,000.6	995.2	985.2	993.1	992.7	993.3	985	X	X	X
105	1,002.9	1,000.9	985.9	995.4	995.0	996.1	985	X	X	X
106	1,003.1	1,000.1	980.1	996.0	996.0	997.0	985	X	X	X
107	1,003.9	1,001.9	986.9	997.1	996.8	997.3	986	X	X	X
108A	1,007.8	1,002.8	987.8	997.7	997.7	997.8	992	X	X	X
109A	1,005.5	1,000.5	985.5	997.3	997.2	997.5	988	X	X	X
118	1,001.5	999.5	991.5	997.2	997.0	997.5	993	X	X	X

Table 5
Seasonal Groundwater Elevation Data And Monitoring Well Usage Summary

Addendum to NAPL Monitoring Report For Fall 2006
Plant Site 1 Groundwater Management Area
General Electric Company - Pittsfield, Massachusetts

Well ID	Ground Elevation (Feet AMSL)	Top of Screen Elevation (Feet AMSL)	Base of Screen Elevation (Feet AMSL)	Overall Average Groundwater Elevation (Feet AMSL)	Average Low Groundwater Elevation (Feet AMSL)	Average High Groundwater Elevation (Feet AMSL)	Till/Silt Elevation (Approximate) (Feet AMSL)	Type of Monitoring Applicable to Well in Fall 2006		
								Water Table	LNAPL	DNAPL
120	1,001.3	999.3	986.3	995.4	995.0	995.7	992	X	X	X
128	1,001.4	1,000.4	986.4	994.7	994.5	994.9	991	X	X	X
131	1,001.3	998.3	993.3	996.8	996.5	997.2	993	X	X	X
140	1,000.3	998.3	983.3	993.0	992.5	993.5	988	X	X	X
ES1-8	1,001.2	996.2	986.2	995.4	995.2	996.3	987	X	X	X
North Caisson	998.0	990.5	979.5	980.1	980.0	980.1	990	X	X	X
East Street Area 1-South										
31R	1,000.5	995.0	985.0	991.3	990.9	991.6	991	X	X	X
33	999.5	996.5	976.5	993.9	993.2	994.0	982	X	X	X
34	999.9	996.9	976.9	994.1	993.9	994.5	983	X	X	X
35	1,000.2	997.2	977.2	994.5	994.3	994.7	990	X	X	X
37R	989.0	981.3	971.3	978.8	978.5	979.3	966	X	X	---
45	1,000.1	998.1	978.1	994.4	994.2	994.6	990	X	X	X
46	999.8	997.8	977.8	993.9	993.7	994.0	990	X	X	X
72	1,000.6	997.6	977.6	994.0	993.8	994.3	983	X	X	X
72R	1,001.2	997.2	987.2	994.7	994.3	994.8	988	X	X	X
75	1,000.7	997.7	977.7	994.2	993.9	994.5	990	X	X	X
76	1,000.5	997.5	977.5	993.6	993.4	993.7	988	X	X	X
78	997.6	995.6	975.6	994.5	994.4	994.5	982	X	X	X
80	990.00	983.5	958.5	985.0	984.1	985.0	N/A	X	---	---
89	993.9	992.9	982.9	985.0	989.9	985.0	984	X	X	X
90	987.70	985.7	972.7	981.9	981.7	982.0	N/A	X	X	---
139R	987.39	981.4	971.4	976.8	975.3	976.7	N/A	X	X	---
ES1-13	1,000.0	996.0	986.0	992.9	989.9	994.0	987	X	X	X
ES1-23R	987.9	983.9	973.9	985.5	983.4	986.8	<974	X	X	X
ES1-24	990.41	986.4	976.4	982.2	978.2	986.3	N/A	X	---	---
GMA1-6	1,000.7	995.7	985.7	992.3	992.0	992.7	985	X	X	X
GMA1-7	986.1	980.7	970.7	974.1	973.6	974.8	964	X	X	---
GMA1-18	998.52	994.5	984.5	991.7	989.8	992.1	N/A	X	X	---
South Caisson	1,000.5	996.5	984.5	987.5	987.7	987.7	987	X	X	X
East Street Area 2-North										
05-N	1,009.5	991.5	981.5	984.9	984.9	985.1	985	X	X	X
11-N	1,011.5	981.5	971.5	980.8	980.0	981.6	972	X	X	X
14-N	1,010.7	986.7	976.7	987.1	986.9	987.2	988	X	X	X
16-N	1,011.0	981.0	971.0	980.3	979.6	980.9	972	X	X	X
17-N	1,010.6	980.6	970.6	980.4	979.8	981.0	975	X	X	X
17A	1,024.2	1,019.2	1,004.2	1,016.0	1,015.7	1,015.3	1,014	X	X	X
19-N	1,011.1	981.1	971.1	980.9	980.5	981.2	977	X	X	X

Table 5
Seasonal Groundwater Elevation Data And Monitoring Well Usage Summary

Addendum to NAPL Monitoring Report For Fall 2006
Plant Site 1 Groundwater Management Area
General Electric Company - Pittsfield, Massachusetts

Well ID	Ground Elevation (Feet AMSL)	Top of Screen Elevation (Feet AMSL)	Base of Screen Elevation (Feet AMSL)	Overall Average Groundwater Elevation (Feet AMSL)	Average Low Groundwater Elevation (Feet AMSL)	Average High Groundwater Elevation (Feet AMSL)	Till/Silt Elevation (Approximate) (Feet AMSL)	Type of Monitoring Applicable to Well in Fall 2006		
								Water Table	LNAPL	DNAPL
20-N	1,011.2	981.2	971.2	981.8	981.4	982.3	977	X	---	X
23-N	1,011.3	981.3	971.3	980.6	980.0	981.2	979	X	X	X
24-N	1,011.1	981.1	971.1	981.4	980.3	982.5	980	X	X	X
95-12	1,010.4	980.4	970.4	981.9	980.6	982.7	970	X	---	X
ES1-5	1,023.4	988.4	978.4	983.4	983.1	984.0	982	X	X	X
ES1-18	1,049.8	1,045.8	1,035.8	1,042.8	1,041.2	1,042.7	1,044	X	X	X
ES1-27R	1,023.4	1,014.1	1,004.1	1,014.7	1,013.9	1,015.7	1,007	X	X	X
East Street Area 2-South										
01R	992.9	982.9	967.9	980.4	980.1	980.9	963	X	X	---
2	996.4	981.4	971.4	978.0	977.7	978.9	967	X	X	---
5	996.0	987.0	972.0	979.5	979.5	981.8	949	X	X	---
6	991.4	976.4	966.4	976.9	976.8	978.3	947	X	---	---
09R	987.3	982.3	967.3	974.2	973.8	974.6	950	X	X	---
10	988.3	978.3	968.3	973.8	973.7	973.9	957	X	X	---
13	991.3	981.3	961.3	974.2	974.0	974.7	964	X	X	X
14	992.4	982.4	962.4	974.4	973.8	975.2	964	X	X	X
16R	987.2	981.3	961.3	975.5	975.0	976.0	951	X	X	---
19	984.1	974.1	959.1	973.4	972.8	973.4	947	X	X	---
25R	995.5	986.5	966.5	978.1	977.2	978.0	963	X	X	---
26RR	998.4	985.4	970.4	979.6	979.0	979.9	<970.4	X	X	---
28	991.5	976.5	966.5	978.1	977.6	978.9	958	X	---	---
29	992.1	975.1	965.1	973.6	973.4	974.4	955	X	X	---
30	990.0	976.0	966.0	977.2	977.0	977.6	960	X	---	---
31	991.0	976.0	966.0	977.2	977.0	977.6	960	X	---	---
32	991.0	982.0	972.0	978.1	977.9	978.5	965	X	X	---
34	982.5	977.5	967.5	976.0	974.6	976.1	950	X	X	---
35	983.0	978.0	968.0	975.0	974.4	975.7	943	X	X	---
36	983.5	978.5	968.5	974.7	974.2	975.6	950	X	X	---
37	980.5	975.5	965.5	974.5	974.2	975.4	960	X	X	---
38	981.4	976.4	966.4	975.7	975.6	976.8	967	X	X	X
40R	991.6	986.6	966.6	975.6	974.7	976.4	960	X	X	---
42	988.5	978.5	968.5	975.7	975.9	976.8	952	X	X	---
43	985.7	975.7	965.7	974.8	975.4	975.1	952	X	X	---
44	988.8	978.8	968.8	975.9	975.8	976.8	957	X	X	---
47	991.6	976.6	966.6	973.7	973.7	974.7	952	X	X	---
48	989.0	974.0	964.0	974.8	974.6	975.2	948	X	---	---
49R	989.1	984.1	964.1	973.7	973.2	974.5	948	X	X	---

Table 5
Seasonal Groundwater Elevation Data And Monitoring Well Usage Summary

Addendum to NAPL Monitoring Report For Fall 2006
Plant Site 1 Groundwater Management Area
General Electric Company - Pittsfield, Massachusetts

Well ID	Ground Elevation (Feet AMSL)	Top of Screen Elevation (Feet AMSL)	Base of Screen Elevation (Feet AMSL)	Overall Average Groundwater Elevation (Feet AMSL)	Average Low Groundwater Elevation (Feet AMSL)	Average High Groundwater Elevation (Feet AMSL)	Till/Silt Elevation (Approximate) (Feet AMSL)	Type of Monitoring Applicable to Well in Fall 2006		
								Water Table	LNAPL	DNAPL
49RR	990.0	980.0	965.0	973.8	973.2	974.4	948	X	X	---
50	986.0	981.5	961.5	975.8	975.4	976.5	953	X	X	---
51	985.3	980.8	960.8	973.7	973.4	974.8	942	X	X	---
52	985.5	981.3	961.3	974.0	972.9	974.5	942	X	X	---
53	987.2	979.2	959.2	973.8	972.5	975.1	947	X	X	---
54	986.1	979.1	959.1	972.8	972.0	973.8	947	X	X	---
55	987.5	980.5	960.5	973.5	973.0	974.1	947	X	X	---
57	990.1	982.1	962.1	977.2	977.2	978.3	952	X	X	---
58	986.3	978.3	958.3	973.1	972.7	973.7	948	X	X	---
59	986.8	978.8	958.8	972.0	971.4	972.6	948	X	X	---
ESA2S-64	985.1	978.1	963.1	973.5	972.7	973.7	964	X	X	X
64R	994.0	978.7	972.7	977.1	976.8	976.8	957	X	X	---
64S	983.5	980.0	955.0	968.5	966.7	969.0	947	X	X	---
64S-Caisson	983.5	--	--	974.5	974.5	N/A	N/A	X	X	---
64V	987.0	977.0	957.0	965.6	965.4	965.3	948	X	X	X
64X(N)	983.8	N/A	969.0	973.2	972.5	973.6	947	X	X	---
64X(S)	980.5	970.5	965.5	970.1	969.8	970.8	940	X	X	---
64X(W)	983.8	973.8	966.3	969.9	968.9	970.7	945	X	X	---
95-1	983.9	975.9	965.9	974.4	973.5	974.5	N/A	X	X	---
95-4R	985.8	975.8	965.8	974.8	974.2	975.0	943	X	X	---
95-5	986.8	978.8	968.8	974.7	974.6	974.8	947	X	X	---
95-7R	992.1	975.6	965.6	976.0	975.4	976.0	946	X	X	---
E2SC-03I	980.4	945.9	935.9	972.7	972.0	974.0	936	---	---	X
E2SC-17	983.8	947.1	937.1	973.3	972.7	974.0	941	---	---	X
E2SC-21	982.3	977.3	967.3	973.6	973.3	974.0	950	X	X	---
E2SC-23	990.1	981.1	971.1	975.4	974.6	976.2	955	X	X	---
E2SC-24	986.0	977.0	967.0	973.1	972.1	974.2	940	X	X	---
3-6C-EB-14	984.7	972.7	963.2	973.5	972.6	974.6	950	X	X	---
3-6C-EB-22	983.3	976.6	966.8	974.2	973.1	973.9	958	X	X	---
3-6C-EB-25	982.6	970.8	961.3	973.1	972.8	974.5	958	X	---	---
3-6C-EB-28	982.8	975.9	961.4	972.8	972.5	973.9	958	X	X	---
ES2-01	985.7	960.7	950.7	973.5	972.9	974.5	945	---	---	---
ES2-02A	980.2	977.2	962.2	973.6	973.6	974.0	940	X	X	---
ES2-05	990.8	981.8	966.8	973.9	973.5	974.9	963	X	X	---
ES2-06	986.3	948.8	938.8	973.6	973.0	974.6	943	---	---	X
ES2-08	995.3	985.3	970.3	973.9	973.6	975.2	962	X	X	---
ES2-09	991.6	981.6	971.6	977.7	977.5	977.9	955	X	X	---

Table 5
Seasonal Groundwater Elevation Data And Monitoring Well Usage Summary

Addendum to NAPL Monitoring Report For Fall 2006
Plant Site 1 Groundwater Management Area
General Electric Company - Pittsfield, Massachusetts

Well ID	Ground Elevation (Feet AMSL)	Top of Screen Elevation (Feet AMSL)	Base of Screen Elevation (Feet AMSL)	Overall Average Groundwater Elevation (Feet AMSL)	Average Low Groundwater Elevation (Feet AMSL)	Average High Groundwater Elevation (Feet AMSL)	Till/Silt Elevation (Approximate) (Feet AMSL)	Type of Monitoring Applicable to Well in Fall 2006		
								Water Table	LNAPL	DNAPL
ES2-11	985.8	980.8	965.8	975.8	974.3	975.0	945	X	X	---
ES2-16	987.1	977.1	967.1	976.4	976.4	976.3	960	X	X	---
ES2-18	987.1	975.1	953.1	974.0	973.6	974.4	962	X	X	X
GMA1-13	989.5	974.5	964.5	974.2	973.2	974.1	<964	X	X	---
GMA1-14	995.3	983.3	973.3	979.2	978.0	979.6	<973	X	X	---
GMA1-15	986.6	980.6	970.6	974.3	973.3	974.2	<970	X	X	---
GMA1-16	985.1	977.1	967.1	974.5	973.5	974.5	<967	X	X	---
GMA1-17E	993.4	985.9	975.9	978.3	977.7	978.5	N/A	X	X	---
GMA1-17W	993.3	979.3	969.3	978.3	977.4	978.3	N/A	X	X	---
GMA1-19	984.63	977.0	967.0	974.2	974.4	974.0	N/A	X	X	---
GMA1-20	983.76	976.0	966.0	973.8	973.9	973.8	N/A	X	X	---
GMA1-21	983.40	976.0	966.0	974.0	974.3	973.5	N/A	X	X	---
GMA1-22	988.74	978.7	968.7	973.6	973.6	973.6	N/A	X	X	---
GMA1-23	986.44	979.4	969.4	973.6	973.6	973.6	N/A	X	X	---
GMA1-24	984.19	978.2	968.2	973.1	973.1	973.1	N/A	X	X	---
HR-C-RW-1	N/A	N/A	N/A	NO DATA	NO DATA	NO DATA	N/A	---	---	X
HR-G1-MW-1	980.3	972.9	962.9	972.9	972.0	973.5	965	X	X	X
HR-G1-MW-2	978.0	962.5	952.5	972.9	972.2	973.6	960	---	---	X
HR-G1-MW-3	978.3	971.3	961.3	973.0	971.9	973.7	955	X	---	---
HR-G2-MW-1	979.1	975.7	965.7	972.9	971.9	973.3	953	X	X	---
HR-G2-MW-2	977.9	974.9	964.9	973.7	972.6	974.3	950	X	X	---
HR-G2-MW-3	984.1	975.3	965.3	973.2	972.4	973.2	940	X	X	---
HR-G2-RW-1	975.0	967.2	962.2	972.8	972.1	973.5	950	X	X	---
HR-G3-MW-1	983.7	979.6	969.6	973.1	972.2	973.6	940	X	X	---
HR-G3-MW-2	984.3	980.2	970.2	972.9	972.4	972.2	935	X	X	---
HR-G3-RW-1	976.8	969.6	967.6	973.2	972.5	973.9	937	X	---	---
HR-J1-MW-1	983.6	975.4	960.4	972.9	972.0	972.9	959	X	X	---
HR-J1-MW-2	983.7	975.8	965.8	973.3	972.7	973.3	952	X	X	---
HR-J1-MW-3	984.6	978.3	963.3	972.8	972.4	973.5	951	X	X	---
HR-J1-RW-1	975.0	963.0	961.0	972.7	971.9	972.9	952	---	---	---
M-R	995.8	980.0	970.0	979.7	978.2	981.1	952	X	X	---
P3	989.3	985.3	975.3	984.1	984.0	984.2	955	X	X	---
PZ-1S	990.1	976.8	971.3	972.9	972.2	974.1	950	X	X	---
PZ-6S	984.3	977.0	971.5	972.7	972.1	973.5	942	X	X	---
RW-1(S)	987.0	977.0	957.0	969.1	968.9	969.2	950	X	X	X

Table 5
Seasonal Groundwater Elevation Data And Monitoring Well Usage Summary

Addendum to NAPL Monitoring Report For Fall 2006
Plant Site 1 Groundwater Management Area
General Electric Company - Pittsfield, Massachusetts

Well ID	Ground Elevation (Feet AMSL)	Top of Screen Elevation (Feet AMSL)	Base of Screen Elevation (Feet AMSL)	Overall Average Groundwater Elevation (Feet AMSL)	Average Low Groundwater Elevation (Feet AMSL)	Average High Groundwater Elevation (Feet AMSL)	Till/Silt Elevation (Approximate) (Feet AMSL)	Type of Monitoring Applicable to Well in Fall 2006		
								Water Table	LNAPL	DNAPL
RW-1(X)	982.7	973.7	958.7	968.1	967.5	968.7	943	X	X	---
RW-2(X)	986.2	977.2	962.2	970.6	969.2	971.5	951	X	X	---
RW-3(X)	980.9	944.9	934.9	972.2	971.3	972.7	936	---	---	X
TMP-1	N/A	N/A	N/A	973.8	973.1	974.5	954	X	---	---
Lyman Street Area										
B-2	978.5	975.5	960.5	971.6	971.7	973.0	N/A	X	X	---
E-4	986.0	974.4	964.4	972.2	971.9	972.6	953	X	X	---
E-7	983.3	978.7	963.7	976.2	975.7	976.7	960	X	X	---
EPA-01	983.3	965.3	961.3	972.9	971.4	973.1	958	---	---	X
GMA1-5	979.6	976.1	966.1	972.2	971.1	972.9	N/A	X	X	---
LS-12	982.6	975.6	960.6	973.2	972.7	974.2	958	X	X	X
LS-13	985.1	975.1	960.1	973.8	973.9	974.6	965	X	X	X
LS-21	983.9	975.9	965.9	972.4	971.7	973.5	967	X	X	X
LS-24	986.6	976.1	964.7	972.9	972.1	973.3	961	X	X	---
LS-29	988.3	963.7	953.7	975.2	974.2	975.1	954	---	---	X
LS-30	984.2	975.6	965.6	972.9	972.5	973.3	966	X	X	X
LS-31	984.9	974.3	964.3	973.7	973.3	974.0	965	X	X	X
LS-34	983.0	967.0	957.5	973.0	972.4	973.7	958	---	---	X
LS-38	984.7	972.1	962.1	972.4	971.7	973.0	962	X	X	X
LS-41	983.9	978.7	964.2	971.1	970.7	971.8	965	X	X	X
LS-43	981.4	964.7	955.2	973.9	972.3	975.0	956	---	---	X
LS-44	981.3	964.6	955.1	972.5	971.8	973.1	956	---	---	X
LSSC-06	983.4	975.4	965.4	972.9	971.8	974.0	965	X	X	X
LSSC-07	982.9	966.9	956.9	973.0	972.4	973.4	954	---	---	X
LSSC-08I	983.6	970.6	960.6	972.9	971.4	973.5	958	X	---	X
LSSC-08S	983.6	978.6	968.6	972.3	971.2	972.8	958	X	X	---
LSSC-09	983.4	977.4	967.4	972.1	971.4	973.1	965	X	X	---
LSSC-16I	981.6	963.6	953.6	972.4	972.2	971.9	956	---	---	X
LSSC-16S	981.5	976.5	966.5	972.9	971.9	973.8	956	X	X	---
LSSC-18	987.6	978.6	968.6	973.1	972.1	973.5	961	X	X	---
LSSC-32	980.9	954.9	944.9	972.7	971.9	973.5	949	---	---	X
LSSC-33	981.0	961.0	951.0	972.7	971.9	973.4	955	---	---	X
LSSC-34I	983.0	968.0	958.0	972.6	971.9	973.2	960	X	---	X
LSSC-34S	982.9	977.9	967.9	972.4	971.6	973.4	960	X	X	---
MW-3R	981.9	971.9	966.9	973.3	973.0	974.6	<966.9	X	---	---
MW-4R	981.2	975.7	965.7	973.0	971.6	973.3	<969.7	X	X	--
MW-6R	985.5	981.5	971.5	974.6	974.0	975.0	<971.5	X	X	--

Table 5
Seasonal Groundwater Elevation Data And Monitoring Well Usage Summary

Addendum to NAPL Monitoring Report For Fall 2006
Plant Site 1 Groundwater Management Area
General Electric Company - Pittsfield, Massachusetts

Well ID	Ground Elevation (Feet AMSL)	Top of Screen Elevation (Feet AMSL)	Base of Screen Elevation (Feet AMSL)	Overall Average Groundwater Elevation (Feet AMSL)	Average Low Groundwater Elevation (Feet AMSL)	Average High Groundwater Elevation (Feet AMSL)	Till/Silt Elevation (Approximate) (Feet AMSL)	Type of Monitoring Applicable to Well in Fall 2006		
								Water Table	LNAPL	DNAPL
RW-1	984.3	976.3	966.3	972.9	972.0	973.2	967	X	X	X
RW-1(R)	984.8	975.4	965.4	969.5	969.3	969.1	965	X	X	X
RW-2	986.0	975.0	965.0	972.3	971.6	973.4	968	X	X	X
RW-3	984.0	N/A	N/A	968.2	967.9	968.7	965	X	X	---
Newell Street Area I										
FW-16R	984.1	976.1	966.6	973.3	972.4	974.4	955	X	X	---
IA-9R	984.7	977.3	967.8	973.6	972.5	974.3	958	X	X	---
MM-1	988.3	983.3	973.3	976.2	975.6	977.0	957	X	X	---
Newell Street Area II										
GMA1-8	981.9	976.2	966.2	972.3	971.5	973.2	961	X	X	---
GMA1-9	979.1	972.0	962.0	972.8	972.1	973.2	957	X	---	---
GMA1-25	987.5	987.5	987.5	974.0	973.3	974.4	N/A	X	---	X
GMA1-26	983.7	983.7	983.7	971.8	971.7	971.8	N/A	X	---	X
GMA1-27	981.3	981.3	981.3	973.0	973.0	973.0	N/A	X	---	X
GMA1-28	981.7	981.7	981.7	971.5	971.3	971.6	N/A	X	---	X
MW-1D	984.5	962.6	948.1	973.4	972.7	974.1	950	---	---	X
MW-1S	984.6	976.7	962.2	973.5	972.9	974.3	950	X	X	X
N2SC-01I	983.6	955.6	948.6	972.7	971.9	973.8	946	---	---	X
N2SC-01I(R)	983.3	955.3	945.3	972.7	971.9	973.8	946	---	---	X
N2SC-2	983.3	956.8	946.8	973.6	972.7	973.7	947	---	---	X
N2SC-03I	983.5	956.5	946.5	973.3	972.5	973.9	948	---	---	X
N2SC-03I(R)	983.5	955.5	945.5	973.3	972.5	973.9	946	---	---	X
N2SC-07	982.9	957.9	947.9	972.8	972.0	973.0	948	---	---	X
N2SC-07S	983.2	974.3	964.3	972.9	971.6	973.4	948	X	X	---
N2SC-08	983.7	954.7	944.7	973.7	973.4	974.0	945	---	---	X
N2SC-09I	985.2	955.2	945.2	975.2	973.4	980.3	949	---	---	X
N2SC-09S	982.9	977.9	967.9	975.6	974.1	978.1	949	X	X	---
N2SC-13I	983.0	954.5	944.5	973.5	973.1	974.4	945	---	---	X
N2SC-14	983.4	957.4	947.4	970.8	970.7	971.3	947	---	---	X
NS-10	987.4	982.4	967.4	974.8	973.7	975.6	950	X	X	---
NS-15 R	983.1	983.1	983.1	982.0	971.34	982.0	NA	X	X	---
NS-16	984.7	974.7	964.7	974.5	973.9	975.3	949	X	X	---
NS-17	982.0	976.0	966.0	972.5	971.8	973.1	948	X	X	---
NS-20	985.6	979.6	969.6	978.7	978.8	979.4	954	X	X	---
NS-32	983.6	955.0	945.5	973.7	974.1	973.3	946	---	---	X
NS-37	983.6	972.6	963.1	972.6	971.3	973.6	943	X	X	---

Table 5
Seasonal Groundwater Elevation Data And Monitoring Well Usage Summary

Addendum to NAPL Monitoring Report For Fall 2006
Plant Site 1 Groundwater Management Area
General Electric Company - Pittsfield, Massachusetts

Well ID	Ground Elevation (Feet AMSL)	Top of Screen Elevation (Feet AMSL)	Base of Screen Elevation (Feet AMSL)	Overall Average Groundwater Elevation (Feet AMSL)	Average Low Groundwater Elevation (Feet AMSL)	Average High Groundwater Elevation (Feet AMSL)	Till/Silt Elevation (Approximate) (Feet AMSL)	Type of Monitoring Applicable to Well in Fall 2006		
								Water Table	LNAPL	DNAPL
SILVER LAKE AREA										
SLGW-1D	981.2	951.2	946.2	978.6	977.7	979.0	<945.2	---	---	X
SLGW-1S	981.2	977.2	967.2	976.5	975.9	976.3	<945.2	X	X	---
SLGW-2D	983.6	953.6	948.6	977.8	976.8	978.0	<947.6	---	---	X
SLGW-2S	983.5	979.5	969.5	977.7	977.2	977.8	<947.5	X	X	---
SLGW-3D	977.2	951.2	946.2	978.0	977.5	978.3	<945.2	---	---	X
SLGW-3S	977.6	976.1	966.1	976.4	976.0	976.4	<945.6	X	X	---
SLGW-4D	981.8	951.8	946.8	977.6	977.1	977.8	<945.8	---	---	X
SLGW-4S	982.0	978.0	968.0	976.3	976.0	976.3	<946	X	X	---
SLGW-5D	979.6	950.6	945.6	976.1	975.9	976.3	<945.64	---	---	X
SLGW-5S	979.8	977.78	967.78	976.1	975.8	976.3	<945.78	X	X	---
SLGW-6D	982.2	952.16	947.16	976.4	975.7	976.5	<946.16	---	---	X
SLGW-6S	982.2	978.2	968.2	976.4	975.6	976.6	<946.2	X	X	---

NOTES:

1. This table replaces the version contained in the Plant Site 1 Groundwater Management Area NAPL Monitoring Report for Fall 2006 .
2. Feet AMSL: Feet above mean sea level
3. Feet BGS: Feet below ground surface
4. N/A: Information not available.
5. Wells are considered to be applicable for DNAPL monitoring if the base of the well screen is less than 1 foot above the till/silt elevation, or if DNAPL has been observed in the well at other depths.

Table 6
Groundwater Elevation and NAPL Thickness - Fall 2006 Monitoring Round

Addendum to NAPL Monitoring Report For Fall 2006
Plant Site 1 Groundwater Management Area
General Electric Company - Pittsfield, Massachusetts

Well ID	Groundwater Elevation (Feet AMSL)	LNAPL Thickness (Feet)	DNAPL Thickness (Feet)
20s Complex			
CC	978.76	0.03	ND
EE	978.98	ND	ND
FF	979.96	ND	ND
GG	981.80	ND	ND
II	979.44	ND	ND
JJ	979.07	ND	ND
LL-R	981.03	ND	ND
O-R	984.49	ND	ND
P-R	978.40	ND	ND
QQ-R	978.75	ND	ND
U	978.36	ND	ND
Y	978.57	0.01	ND
30s Complex			
95-15	978.08	ND	---
95-16	992.12	ND	ND
ES2-19	993.99	ND	ND
GMA1-10	977.17	ND	ND
GMA1-12	976.24	ND	ND
RF-02	976.75	ND	ND
RF-03	976.01	ND	NA
RF-03D	977.56	NA	NA
RF-16R	978.27	ND	ND
40s Complex			
95-17	997.14	ND	ND
East Street Area 1-North			
25	994.88	0.01	ND
49	994.60	ND	ND
ESA1N-52	994.39	ND	ND
60R	993.57	ND	ND
105	991.42	0.38	ND
106	996.49	0.33	ND
107	996.46	0.01	ND
108A	997.74	ND	ND
109A	997.06	ND	ND
118	997.40	0.01	ND
128	994.70	ND	ND
131	996.85	ND	ND
140	992.71	0.01	ND
ES1-8	995.60	ND	ND
North Caisson	980.84	0.01	ND

Table 6
Groundwater Elevation and NAPL Thickness - Fall 2006 Monitoring Round

Addendum to NAPL Monitoring Report For Fall 2006
Plant Site 1 Groundwater Management Area
General Electric Company - Pittsfield, Massachusetts

Well ID	Groundwater Elevation (Feet AMSL)	LNAPL Thickness (Feet)	DNAPL Thickness (Feet)
East Street Area 1-South			
31R	991.30	ND	ND
ESA1S-33	993.66	ND	ND
34	994.24	0.02	ND
35	994.55	0.01	ND
45	994.45	0.01	ND
46	993.94	ND	ND
72	994.25	0.01	ND
72R	994.81	ND	ND
75	994.41	ND	ND
76	993.64	0.20	ND
78	994.31	ND	ND
80	985.28	ND	ND
90	982.00	ND	ND
139R	977.19	ND	ND
ES1-13	993.69	ND	ND
ES1-23R	986.84	ND	ND
GMA1-6	992.65	ND	ND
GMA1-7	974.21	ND	ND
GMA1-18	992.50	ND	ND
South Caisson	987.63	0.01	ND
East Street Area 2-North			
05-N	984.76	0.01	ND
11-N	980.43	ND	ND
14-N	987.12	0.19	ND
16-N	979.67	ND	ND
17A	1,016.80	ND	ND
17-N	979.92	0.02	ND
19-N	983.57	ND	ND
20-N	981.66	0.01	ND
23-N	980.42	0.17	ND
24-N	980.70	0.01	ND
ES1-5	983.75	NA	NA
ES1-18	1,044.27	ND	ND
ES1-20	987.50	ND	ND
ES1-27R	1,002.85	ND	ND

Table 6
Groundwater Elevation and NAPL Thickness - Fall 2006 Monitoring Round

Addendum to NAPL Monitoring Report For Fall 2006
Plant Site 1 Groundwater Management Area
General Electric Company - Pittsfield, Massachusetts

Well ID	Groundwater Elevation (Feet AMSL)	LNAPL Thickness (Feet)	DNAPL Thickness (Feet)
East Street Area 2-South			
01R	980.58	ND	ND
2	977.71	ND	ND
5	981.20	ND	ND
6	975.68	ND	ND
09R	973.68	ND	ND
10	973.5	ND	ND
13	973.53	0.06	ND
14	974.15	0.08	ND
16R	974.05	ND	ND
19	973.08	ND	ND
25R	976.98	0.38	ND
26RR	977.57	0.10	ND
28	974.28	ND	ND
29	973.57	0.35	ND
30	977.37	1.70	ND
31	977.25	ND	ND
32	978.43	ND	ND
34	974.68	ND	ND
35	976.81	ND	ND
36	974.82	ND	ND
37	974.55	ND	ND
38	975.97	ND	ND
40R	972.80	ND	ND
42	976.33	ND	ND
43	975.27	ND	ND
44	975.73	ND	ND
47	973.55	0.99	ND
48	976.93	1.82	ND
49R	973.66	ND	ND
49RR	973.50	ND	ND
50	974.94	0.03	ND
51	973.73	ND	ND
ESA2S-52	973.48	ND	ND
53	973.47	ND	ND
54	972.98	ND	ND
55	973.22	0.50	ND
57	977.20	ND	ND
58	973.11	0.02	ND
59	971.92	ND	ND
ESA2S-64	972.98	ND	ND
64R	977.82	0.01	ND
64S	965.28	<0.01	ND
64S-Caisson	974.59	0.02	ND
64V	965.56	0.50	<0.01
64X(N)	973.09	0.01	ND

Table 6
Groundwater Elevation and NAPL Thickness - Fall 2006 Monitoring Round

Addendum to NAPL Monitoring Report For Fall 2006
Plant Site 1 Groundwater Management Area
General Electric Company - Pittsfield, Massachusetts

Well ID	Groundwater Elevation (Feet AMSL)	LNAPL Thickness (Feet)	DNAPL Thickness (Feet)
64X(S)	966.93	0.08	ND
64X(W)	967.10	0.01	ND
95-1	973.66	ND	ND
95-04R	974.17	0.70	ND
95-5	973.88	0.33	ND
95-07R	975.17	0.01	ND
E2SC-03I	973.22	NA	3.75
E2SC-17	974.08	NA	ND
E2SC-23	974.21	ND	ND
E2SC-24	973.10	ND	ND
3-6C-EB-22	973.44	ND	ND
3-6C-EB-25	973.10	ND	ND
3-6C-EB-28	973.29	ND	ND
ES2-01	973.61	ND	ND
ES2-02A	974.33	ND	ND
ES2-05	974.15	ND	ND
ES2-06	973.44	NA	ND
ES2-08	973.47	ND	ND
ES2-09	977.80	NA	NA
ES2-11	974.13	ND	ND
ES2-16	975.23	NA	NA
ES2-18	973.83	0.00	ND
GMA1-13	973.81	0.00	ND
GMA1-14	977.88	0.00	ND
GMA1-15	973.70	0.39	ND
GMA1-16	973.72	0.03	ND
GMA1-17E	977.28	0.02	ND
GMA1-17W	979.24	ND	ND
GMA1-19	974.14	0.63	ND
GMA1-20	973.38	ND	ND
GMA1-21	973.44	ND	ND
GMA1-22	973.80	ND	ND
GMA1-23	973.70	ND	ND
GMA1-24	973.36	ND	ND
HR-C-RW-1	NS	ND	ND
HR-G1-MW-1	972.67	ND	ND
HR-G1-MW-2	972.88	ND	ND
HR-G1-MW-3	972.51	ND	ND
HR-G2-MW-1	972.55	ND	ND
HR-G2-MW-2	973.59	ND	ND
HR-G2-MW-3	973.09	ND	ND
HR-G2-RW-1	972.88	ND	ND
HR-G3-MW-1	972.90	ND	ND
HR-G3-MW-2	973.03	ND	ND
HR-G3-RW-1	972.33	ND	ND
HR-J1-MW-3	973.18	ND	ND

Table 6
Groundwater Elevation and NAPL Thickness - Fall 2006 Monitoring Round

Addendum to NAPL Monitoring Report For Fall 2006
Plant Site 1 Groundwater Management Area
General Electric Company - Pittsfield, Massachusetts

Well ID	Groundwater Elevation (Feet AMSL)	LNAPL Thickness (Feet)	DNAPL Thickness (Feet)
HR-J1-MW-2	973.33	ND	ND
HR-J1-MW-1	972.98	ND	ND
HR-J1-RW-1	972.71	ND	ND
M-R	977.79	0.01	ND
P3	984.20	ND	ND
PZ-1S	973.18	ND	ND
PZ-6S	972.88	ND	ND
RW-1(S)	968.02	0.10	<0.01
RW-1(X)	969.08	<0.01	ND
RW-2(X)	972.68	ND	ND
RW-3(X)	971.78	ND	3.80
TMP-1	973.34	ND	ND
SG-HR-1	971.63	NA	NA
Lyman Street Area			
E-4	973.08	ND	ND
E-7	975.77	ND	ND
EPA-1	971.63	ND	ND
LS-12	972.79	ND	0.02
LS-13	974.35	ND	ND
LS-21	972.94	0.07	ND
LS-24	973.13	ND	ND
LS-29	974.23	ND	ND
LS-30	972.62	ND	0.86
LS-31	973.39	0.05	0.61
LS-34	972.46	ND	0.16
LS-38	971.95	ND	ND
LS-44	971.83	ND	ND
LSSC-06	973.81	ND	ND
LSSC-07	972.23	ND	0.28
LSSC-08S	971.57	ND	ND
LSSC-08I	974.40	ND	ND
LSSC-09	972.61	ND	ND
LSSC-16I	972.28	ND	ND
LSSC-16S	972.34	ND	ND
LSSC-18	973.22	ND	ND
LSSC-32	972.05	ND	ND
LSSC-33	972.05	ND	ND
LSSC-34I	972.06	ND	0.02
LSSC-34S	972.01	ND	ND
MW-3R	973.19	ND	ND
MW-4R	972.02	ND	ND
MW-6R	973.89	ND	ND
RW-1	972.88	ND	<0.01
RW-1(R)	969.06	ND	<0.01
RW-2	973.57	ND	ND
RW-3	967.57	0.13	ND

Table 6
Groundwater Elevation and NAPL Thickness - Fall 2006 Monitoring Round

Addendum to NAPL Monitoring Report For Fall 2006
Plant Site 1 Groundwater Management Area
General Electric Company - Pittsfield, Massachusetts

Well ID	Groundwater Elevation (Feet AMSL)	LNAPL Thickness (Feet)	DNAPL Thickness (Feet)
Newell Street Area I			
FW-16R	973.01	ND	NA
IA-9R	974.98	ND	NA
MM-1	976.19	ND	NA
Newell Street Area II			
GMA1-8	972.51	ND	ND
GMA1-9	973.10	ND	ND
GMA1-25	974.04	ND	ND
GMA1-26	973.63	ND	ND
GMA1-27	974.97	ND	ND
GMA1-28	973.36	ND	ND
MW-1D	973.98	ND	0.01
MW-1S	973.35	ND	0.08
N2SC-01I	973.47	ND	4.19
N2SC-01I(R)	974.99	ND	1.39
N2SC-02	974.99	ND	ND
N2SC-03I	976.20	ND	2.05
N2SC-03I(R)	972.58	ND	2.60
N2SC-04	969.51	NA	NA
N2SC-05	970.63	NA	NA
N2SC-07	975.26	ND	ND
N2SC-07S	972.84	ND	ND
N2SC-08	974.87	ND	2.05
N2SC-09I	973.27	ND	ND
N2SC-09S	973.50	ND	0.18
N2SC-13I	974.90	ND	0.66
N2SC-14	971.12	ND	1.40
N2SC-16	975.79	ND	ND
NS-10	974.25	0.17	ND
NS-15R	NS	ND	ND
NS-17	972.86	ND	ND
NS-20	979.15	ND	ND
NS-30	976.30	ND	0.19
NS-32	975.42	ND	0.10
NS-37	972.58	ND	ND

**Table 6
Groundwater Elevation and NAPL Thickness - Fall 2006 Monitoring Round**

**Addendum to NAPL Monitoring Report For Fall 2006
Plant Site 1 Groundwater Management Area
General Electric Company - Pittsfield, Massachusetts**

Well ID	Groundwater Elevation (Feet AMSL)	LNAPL Thickness (Feet)	DNAPL Thickness (Feet)
Silver Lake Area			
SLGW-1S	978.22	ND	NA
SLGW-1D	976.02	NA	ND
SLGW-3S	977.37	ND	NA
SLGW-3D	976.13	NA	ND
SLGW-4S	976.88	ND	NA
SLGW-4D	976.17	NA	ND
SLGW-5S	975.97	ND	NA
SLGW-5D	975.98	NA	ND
SLGW-6S	975.56	ND	NA
SLGW-6D	976.27	NA	ND

Notes:

1. This table replaces the version contained in the Plant Site 1 Groundwater Management Area NAPL Monitoring Report for Fall 2006 .
2. The listed wells were monitored during the fall 2006 groundwater elevation monitoring event.
3. Feet AMSL: Feet above mean sea level.
4. NS: Measuring point elevation not surveyed.
5. NA: Not applicable - Well not screened to monitor for either LNAPL (i.e., water level above top of well screen) or DNAPL (i.e., well screen does not intersect till or other confining unit).
6. ND: Not detected.
7. Wells RF-4 (40s Complex), 15R, E2SC-21, 3-6C-EB-14, ES2-14, ES2-15, ES2-17 (East Street Area 2-South), 27-N (East Street Area 2-North), 120, ES1-14 (East Street Area 1-North), B-2, GMA1-5, LS-43 (Lyman Street Area), NS-9, and NS-16 (Newell Street Area II) were unable to be measured during the fall 2006 monitoring event. These wells were either not located, inaccessible, or destroyed.

Table 7
Groundwater Elevation and NAPL Monitoring/Recovery
Data Summary: Fall 2006

Addendum to NAPL Monitoring Report for Fall 2006
Plant Site 1 Groundwater Management Area
General Electric Company - Pittsfield, Massachusetts

Well Name	Number of Measurements	Measuring Point Elevation (Feet AMSL)	Depth to Water		LNAPL Observations			DNAPL Observations			Manual NAPL Recovery	
			Minimum (Feet AMP)	Maximum (Feet AMP)	Times Observed	Minimum Thickness (Feet)	Maximum Thickness (Feet)	Times Observed	Minimum Thickness (Feet)	Maximum Thickness (Feet)	LNAPL Recovery (Gallons)	DNAPL Recovery (Gallons)
40s Complex												
95-17	1	1,007.67	23.94	23.94	0	---	---	0	---	---	0.000	0.000
RF-04	1	1,011.99	Buried									
30s Complex												
95-15	1	986.38	8.30	8.30	0	---	---	0	---	---	0.000	0.000
95-16	1	1,007.65	15.53	15.53	0	---	---	0	---	---	0.000	0.000
ES2-19	1	1,007.22	13.23	13.23	0	---	---	0	---	---	0.000	0.000
GMA1-10	1	984.86	7.69	7.69	0	---	---	0	---	---	0.000	0.000
GMA1-12	1	992.26	16.02	16.02	0	---	---	0	---	---	0.000	0.000
RF-02	1	982.43	5.68	5.68	0	---	---	0	---	---	0.000	0.000
RF-03	1	985.40	9.39	9.39	0	---	---	0	---	---	0.000	0.000
RF-03D	1	985.31	7.75	7.75	0	---	---	0	---	---	0.000	0.000
RF-16	1	987.91	9.64	9.64	0	---	---	0	---	---	0.000	0.000
20s Complex												
CC	2	998.84	20.11	20.25	2	0.03	0.03	0	---	---	0.005	0.000
EE	2	1,004.27	25.29	25.42	0	---	---	0	---	---	0.000	0.000
FF	1	1,005.70	25.74	25.74	0	---	---	0	---	---	0.000	0.000
GG	1	1,007.40	25.60	25.60	0	---	---	0	---	---	0.000	0.000
II	2	1,007.26	27.82	28.49	1	0.03	0.03	0	---	---	0.005	0.000
JJ	1	1,006.38	27.31	27.31	0	---	---	0	---	---	0.000	0.000
LL-R	1	1,010.39	29.36	29.36	0	---	---	0	---	---	0.000	0.000
O-R	1	1,000.42	15.93	15.93	0	---	---	0	---	---	0.000	0.000
P-R	1	1,005.01	26.61	26.61	0	---	---	0	---	---	0.000	0.000
QQ-R	1	998.32	19.57	19.57	0	---	---	0	---	---	0.000	0.000
U	1	998.89	20.53	20.53	0	---	---	0	---	---	0.000	0.000
Y	1	1,002.86	24.30	24.30	1	0.01	0.01	0	---	---	0.000	0.000

Table 7
Groundwater Elevation and NAPL Monitoring/Recovery
Data Summary: Fall 2006

Addendum to NAPL Monitoring Report for Fall 2006
Plant Site 1 Groundwater Management Area
General Electric Company - Pittsfield, Massachusetts

Well Name	Number of Measurements	Measuring Point Elevation (Feet AMSL)	Depth to Water		LNAPL Observations			DNAPL Observations			Manual NAPL Recovery	
			Minimum (Feet AMP)	Maximum (Feet AMP)	Times Observed	Minimum Thickness (Feet)	Maximum Thickness (Feet)	Times Observed	Minimum Thickness (Feet)	Maximum Thickness (Feet)	LNAPL Recovery (Gallons)	DNAPL Recovery (Gallons)
East Street Area 2 - South												
01R	1	992.72	12.14	12.14	0	---	---	0	---	---	0.000	0.000
2	2	995.64	17.93	18.60	1	0.01	0.01	0	---	---	0.002	0.000
5	2	996.10	14.90	15.58	0	---	---	0	---	---	0.000	0.000
6	1	991.18	15.50	15.50	0	---	---	0	---	---	0.000	0.000
09R	1	986.88	13.20	13.20	0	---	---	0	---	---	0.000	0.000
10	1	987.95	14.45	14.45	0	---	---	0	---	---	0.000	0.000
13	6	990.88	16.90	18.24	5	0.06	0.22	0	---	---	0.082	0.000
14	6	991.61	17.05	18.38	6	0.02	0.23	0	---	---	0.090	0.000
16R	1	987.10	13.05	13.05	0	---	---	0	---	---	0.000	0.000
19	26	983.59	9.95	11.74	0	---	---	0	---	---	0.000	0.000
25R	9	998.31	21.68	26.22	9	0.11	5.19	0	---	---	3.653	0.000
26RR	5	1,000.58	21.00	23.54	5	0.09	0.44	0	---	---	0.124	0.000
28	1	991.86	17.58	17.58	0	---	---	0	---	---	0.000	0.000
29	2	991.59	18.35	19.70	1	0.35	0.98	0	---	---	0.160	0.000
30	2	989.34	13.55	17.10	2	1.70	4.30	0	---	---	0.701	0.000
31	1	990.60	13.35	13.35	0	---	---	0	---	---	0.000	0.000
32	1	990.81	12.38	12.38	0	---	---	0	---	---	0.000	0.000
34	1	982.54	7.86	7.86	0	---	---	0	---	---	0.000	0.000
35	1	982.81	6.00	6.00	0	---	---	0	---	---	0.000	0.000
36	1	983.02	8.20	8.20	0	---	---	0	---	---	0.000	0.000
37	1	980.37	5.82	5.82	0	---	---	0	---	---	0.000	0.000
38	1	980.77	4.80	4.80	0	---	---	0	---	---	0.000	0.000
40R	16	991.60	13.92	18.80	0	---	---	0	---	---	0.000	0.000
42	2	988.33	12.00	13.89	0	---	---	0	---	---	0.000	0.000
43	2	989.67	14.40	14.69	0	---	---	0	---	---	0.000	0.000
44	1	988.33	12.60	12.60	0	---	---	0	---	---	0.000	0.000
47	2	991.09	18.46	19.58	2	0.99	1.38	0	---	---	0.225	0.000
48	6	992.39	16.20	18.40	6	1.18	2.30	0	---	---	1.507	0.000
49R	7	988.71	14.50	15.98	0	---	---	0	---	---	0.000	0.000
49RR	6	989.80	15.68	17.06	0	---	---	0	---	---	0.000	0.000
50	3	985.79	10.70	11.52	3	0.03	0.57	0	---	---	0.144	0.000
51	1	985.38	11.65	11.65	0	---	---	0	---	---	0.000	0.000

Table 7
Groundwater Elevation and NAPL Monitoring/Recovery
Data Summary: Fall 2006

Addendum to NAPL Monitoring Report for Fall 2006
Plant Site 1 Groundwater Management Area
General Electric Company - Pittsfield, Massachusetts

Well Name	Number of Measurements	Measuring Point Elevation (Feet AMSL)	Depth to Water		LNAPL Observations			DNAPL Observations			Manual NAPL Recovery	
			Minimum (Feet AMP)	Maximum (Feet AMP)	Times Observed	Minimum Thickness (Feet)	Maximum Thickness (Feet)	Times Observed	Minimum Thickness (Feet)	Maximum Thickness (Feet)	LNAPL Recovery (Gallons)	DNAPL Recovery (Gallons)
ESA2S-52	1	985.18	11.70	11.70	0	---	---	0	---	---	0.000	0.000
53	2	986.90	13.43	14.11	0	---	---	0	---	---	0.000	0.000
54	1	985.78	12.80	12.80	0	---	---	0	---	---	0.000	0.000
55	6	989.45	16.20	18.20	5	0.30	1.30	0	---	---	0.633	0.000
57	2	989.80	12.60	13.28	0	---	---	0	---	---	0.000	0.000
58	2	985.79	12.70	13.51	2	0.02	0.02	0	---	---	0.000	0.000
59	1	986.32	14.40	14.40	0	---	---	0	---	---	0.000	0.000
64	1	984.98	12.00	12.00	0	---	---	0	---	---	0.000	0.000
64R	26	993.37	15.54	16.75	16	0.01	0.04	0	---	---	0.000	0.000
64S	26	984.48	14.46	19.30	6	0.00	0.02	0	---	---	0.000	0.000
64S - Caisson	25	984.40	9.50	11.42	19	0.01	0.15	0	---	---	0.000	0.000
64V	25	987.29	21.60	22.30	25	0.10	0.50	0	---	---	0.000	0.000
64X(N)	25	984.83	10.97	13.85	20	0.01	0.03	0	---	---	0.000	0.000
64X(S)	25	981.56	13.20	16.40	25	0.02	0.20	0	---	---	0.000	0.000
64X(W)	25	984.87	16.98	19.95	22	0.01	0.05	0	---	---	0.000	0.000
95-01	6	983.77	9.52	11.03	0	---	---	0	---	---	0.000	0.000
95-04	2	988.70	16.29	16.42	2	2.00	2.13	0	---	---	0.328	0.000
95-04R	5	988.36	14.18	16.05	5	0.70	1.53	0	---	---	2.489	0.000
95-05	2	989.45	15.88	17.03	2	0.33	0.67	0	---	---	0.109	0.000
95-07	1	994.91	22.60	22.60	1	3.65	3.65	0	---	---	0.597	0.000
95-07R	5	994.56	18.30	19.72	5	0.01	0.02	0	---	---	0.031	0.000
E2SC-03I	5	982.12	8.40	10.45	0	---	---	5	3.75	8.30	0.000	3.900
E2SC-17	5	985.38	10.75	12.25	0	---	---	0	---	---	0.000	0.000
E2SC-21	1	981.70	0.00	0.00	0	---	---	0	---	---	0.000	0.000
E2SC-23	6	992.07	15.25	18.10	0	---	---	0	---	---	0.000	0.000
E2SC-24	6	987.90	14.20	15.90	0	---	---	0	---	---	0.000	0.000
3-6C-EB-22	6	986.94	12.87	14.41	0	---	---	0	---	---	0.000	0.000
3-6C-EB-25	1	986.31	12.70	12.70	0	---	---	0	---	---	0.000	0.000
3-6C-EB-28	1	985.79	12.50	12.50	0	---	---	0	---	---	0.000	0.000
ES2-01	1	985.36	11.75	11.75	0	---	---	0	---	---	0.000	0.000
ES2-02A	2	979.63	5.30	7.06	0	---	---	0	---	---	0.000	0.000

Table 7
Groundwater Elevation and NAPL Monitoring/Recovery
Data Summary: Fall 2006

Addendum to NAPL Monitoring Report for Fall 2006
Plant Site 1 Groundwater Management Area
General Electric Company - Pittsfield, Massachusetts

Well Name	Number of Measurements	Measuring Point Elevation (Feet AMSL)	Depth to Water		LNAPL Observations			DNAPL Observations			Manual NAPL Recovery	
			Minimum (Feet AMP)	Maximum (Feet AMP)	Times Observed	Minimum Thickness (Feet)	Maximum Thickness (Feet)	Times Observed	Minimum Thickness (Feet)	Maximum Thickness (Feet)	LNAPL Recovery (Gallons)	DNAPL Recovery (Gallons)
ES2-05	1	990.65	16.50	16.50	0	---	---	0	---	---	0.000	0.000
ES2-06	6	986.00	11.94	13.64	0	---	---	0	---	---	0.000	0.000
ES2-08	1	994.87	21.40	21.40	0	---	---	0	---	---	0.000	0.000
ES2-09	1	991.25	0.00	0.00	0	---	---	0	---	---	0.000	0.000
ES2-11	1	985.05	10.92	10.92	0	---	---	0	---	---	0.000	0.000
ES2-16	1	986.88	0.00	0.00	0	---	---	0	---	---	0.000	0.000
ES2-18	1	986.86	13.03	13.03	0	---	---	0	---	---	0.000	0.000
HR-C-RW-1	1	N/A	7.70	7.70	0	---	---	0	---	---	0.000	0.000
HR-G1-MW-1	2	982.42	9.75	10.50	0	---	---	0	---	---	0.000	0.000
HR-G1-MW-2	2	980.23	7.35	8.05	0	---	---	0	---	---	0.000	0.000
HR-G1-MW-3	2	980.21	7.70	8.48	0	---	---	0	---	---	0.000	0.000
HR-G2-MW-1	6	982.60	8.50	11.15	0	---	---	0	---	---	0.000	0.000
HR-G2-MW-2	6	981.39	7.20	9.05	0	---	---	0	---	---	0.000	0.000
HR-G2-MW-3	6	987.14	13.40	15.15	0	---	---	0	---	---	0.000	0.000
HR-G2-RW-1	7	976.88	4.50	6.71	0	---	---	0	---	---	0.000	0.000
HR-G3-MW-1	2	987.10	14.20	14.92	0	---	---	0	---	---	0.000	0.000
HR-G3-MW-2	2	987.88	14.85	15.50	0	---	---	0	---	---	0.000	0.000
HR-G3-RW-1	2	977.78	5.45	5.56	0	---	---	0	---	---	0.000	0.000
HR-J1-MW-1	2	985.95	12.97	13.31	0	---	---	0	---	---	0.000	0.000
HR-J1-MW-2	2	983.56	10.23	10.58	0	---	---	0	---	---	0.000	0.000
HR-J1-MW-3	2	987.68	14.50	14.86	0	---	---	0	---	---	0.000	0.000
HR-J1-RW-1	2	975.05	2.34	2.78	0	---	---	0	---	---	0.000	0.000
GMA1-13	1	991.41	17.60	17.60	0	---	---	0	---	---	0.000	0.000
GMA1-14	6	997.29	9.42	20.19	3	0.01	0.03	0	---	---	0.005	0.000
GMA1-15	18	988.59	15.00	16.60	18	0.26	0.84	0	---	---	1.671	0.000
GMA1-16	18	986.82	10.60	14.30	18	0.03	0.65	0	---	---	0.564	0.000
GMA1-17E	6	993.03	14.83	16.07	6	0.01	0.02	0	---	---	0.003	0.000
GMA1-17W	9	992.63	16.54	23.20	3	<0.01	4.20	0	---	---	0.414	0.000
GMA1-19	26	984.28	10.22	12.20	26	0.02	1.22	0	---	---	1.858	0.000
GMA1-20	25	983.49	9.70	11.30	0	---	---	0	---	---	0.000	0.000

Table 7
Groundwater Elevation and NAPL Monitoring/Recovery
Data Summary: Fall 2006

Addendum to NAPL Monitoring Report for Fall 2006
Plant Site 1 Groundwater Management Area
General Electric Company - Pittsfield, Massachusetts

Well Name	Number of Measurements	Measuring Point Elevation (Feet AMSL)	Depth to Water		LNAPL Observations			DNAPL Observations			Manual NAPL Recovery	
			Minimum (Feet AMP)	Maximum (Feet AMP)	Times Observed	Minimum Thickness (Feet)	Maximum Thickness (Feet)	Times Observed	Minimum Thickness (Feet)	Maximum Thickness (Feet)	LNAPL Recovery (Gallons)	DNAPL Recovery (Gallons)
GMA1-21	26	985.68	11.72	13.45	0	---	---	0	---	---	0.000	0.000
GMA1-22	18	988.45	13.15	15.80	0	---	---	0	---	---	0.000	0.000
GMA1-23	18	986.16	11.85	13.55	0	---	---	0	---	---	0.000	0.000
GMA1-24	20	983.81	9.90	11.64	1	0.01	0.01	0	---	---	0.002	0.000
M-R	2	998.19	20.41	20.61	2	0.01	0.01	0	---	---	0.002	0.000
P3	2	989.25	5.05	5.23	0	---	---	0	---	---	0.000	0.000
PZ-1S	2	989.93	16.75	17.80	0	---	---	0	---	---	0.000	0.000
PZ-6S	1	984.13	11.25	11.25	0	---	---	0	---	---	0.000	0.000
RW-1(S)	25	987.23	18.90	19.95	25	0.01	0.34	2	<0.01	<0.01	0.000	0.000
RW-1(X)	25	982.68	13.20	14.90	10	<0.01	0.30	0	---	---	0.000	0.000
RW-2(X)	25	985.96	12.20	15.50	1	---	---	0	---	---	0.000	0.000
RW-3(X)	25	980.28	8.10	10.80	0	---	---	25	1.40	3.80	0.000	0.000
SG-HR-1	26	990.73	16.73	19.89	0	---	---	0	---	---	0.000	0.000
TMP-1	2	992.74	19.32	19.40	0	---	---	0	---	---	0.000	0.000
East Street Area 2 - North												
05-N	2	1,009.23	24.48	24.61	1	0.01	0.01	0	---	---	0.000	0.000
11-N	1	1,010.85	30.42	30.42	0	---	---	0	---	---	0.000	0.000
14-N	2	1,010.53	23.59	23.63	2	0.13	0.19	0	---	---	0.021	0.000
16-N	2	1,010.65	30.98	31.50	0	---	---	0	---	---	0.000	0.000
17-N	2	1,010.49	30.59	31.10	2	0.02	0.05	0	---	---	0.008	0.000
17A	1	1,023.86	7.06	7.06	0	---	---	0	---	---	0.000	0.000
19-N	1	1,010.68	0.00	0.00	0	---	---	0	---	---	0.000	0.000
20-N	1	1,010.66	29.01	29.01	1	0.01	0.01	0	---	---	0.000	0.000
23-N	2	1,011.13	30.87	31.26	2	0.06	0.17	0	---	---	0.010	0.000
24-N	1	1,010.50	29.81	29.81	1	0.01	0.01	0	---	---	0.000	0.000
95-12	1	1,010.20	0.00	0.00	0	---	---	0	---	---	0.000	0.000
ES1-05	3	1,023.33	36.91	39.58	0	---	---	0	---	---	0.000	0.000
ES1-18	1	1,049.71	5.44	5.44	0	---	---	0	---	---	0.000	0.000
ES1-20	3	1,001.56	14.01	14.11	0	---	---	0	---	---	0.000	0.000
ES1-27R	1	1,023.19	20.34	20.34	0	---	---	0	---	---	0.000	0.000

Table 7
Groundwater Elevation and NAPL Monitoring/Recovery
Data Summary: Fall 2006

Addendum to NAPL Monitoring Report for Fall 2006
Plant Site 1 Groundwater Management Area
General Electric Company - Pittsfield, Massachusetts

Well Name	Number of Measurements	Measuring Point Elevation (Feet AMSL)	Depth to Water		LNAPL Observations			DNAPL Observations			Manual NAPL Recovery	
			Minimum (Feet AMP)	Maximum (Feet AMP)	Times Observed	Minimum Thickness (Feet)	Maximum Thickness (Feet)	Times Observed	Minimum Thickness (Feet)	Maximum Thickness (Feet)	LNAPL Recovery (Gallons)	DNAPL Recovery (Gallons)
East Street Area 1 - North												
25	1	1,000.70	5.83	5.83	1	0.01	0.01	0	---	---	0.000	0.000
49	2	999.90	5.30	5.72	1	0.01	0.01	0	---	---	0.002	0.000
ESA1N-52	2	999.26	4.87	4.91	0	---	---	0	---	---	0.000	0.000
60R	1	1,004.03	10.46	10.46	0	---	---	0	---	---	0.000	0.000
105	2	1,002.85	8.39	11.78	2	0.38	0.80	0	---	---	0.163	0.000
106	2	1,004.06	7.88	9.59	2	0.33	0.49	0	---	---	0.080	0.000
107	2	1,003.86	7.41	7.73	1	0.01	0.01	0	---	---	0.000	0.000
108A	1	1,007.79	10.05	10.05	0	---	---	0	---	---	0.000	0.000
109A	1	1,005.43	8.37	8.37	0	---	---	0	---	---	0.000	0.000
118	1	1,001.50	4.11	4.11	1	0.01	0.01	0	---	---	0.000	0.000
128	1	1,001.41	6.71	6.71	0	---	---	0	---	---	0.000	0.000
131	3	1,001.18	4.33	4.97	1	0.05	0.05	0	---	---	0.002	0.000
140	2	1,000.30	7.53	7.60	1	0.01	0.01	0	---	---	0.000	0.000
ES1-08	2	1,000.85	5.25	5.40	0	---	---	0	---	---	0.000	0.000
North Caisson	26	997.84	16.63	19.90	23	0.01	1.98	0	---	---	1.585	0.000
East Street Area 1 - South												
31R	6	1,000.23	8.93	8.98	0	---	---	0	---	---	0.000	0.000
33	5	999.50	5.84	6.90	0	---	---	0	---	---	0.000	0.000
34	6	999.90	5.68	6.22	6	0.01	0.03	0	---	---	0.015	0.000
35	2	1,000.15	5.61	6.00	2	0.01	0.04	0	---	---	0.007	0.000
45	2	1,000.10	5.66	6.03	2	0.01	0.09	0	---	---	0.015	0.000
46	1	999.80	5.86	5.86	0	---	---	0	---	---	0.000	0.000
72	6	1,000.62	6.38	7.03	5	0.01	0.16	0	---	---	0.034	0.000
72R	6	1,000.92	6.11	7.00	0	---	---	0	---	---	0.000	0.000
75	1	1,000.65	6.24	6.24	0	---	---	0	---	---	0.000	0.000
76	2	1,000.45	7.00	7.44	2	0.20	0.68	0	---	---	0.111	0.000
78	1	997.61	3.30	3.30	0	---	---	0	---	---	0.000	0.000
80	1	989.98	4.70	4.70	0	---	---	0	---	---	0.000	0.000
90	1	987.65	5.65	5.65	0	---	---	0	---	---	0.000	0.000
139R	1	986.91	9.72	9.72	0	---	---	0	---	---	0.000	0.000

Table 7
Groundwater Elevation and NAPL Monitoring/Recovery
Data Summary: Fall 2006

Addendum to NAPL Monitoring Report for Fall 2006
Plant Site 1 Groundwater Management Area
General Electric Company - Pittsfield, Massachusetts

Well Name	Number of Measurements	Measuring Point Elevation (Feet AMSL)	Depth to Water		LNAPL Observations			DNAPL Observations			Manual NAPL Recovery	
			Minimum (Feet AMP)	Maximum (Feet AMP)	Times Observed	Minimum Thickness (Feet)	Maximum Thickness (Feet)	Times Observed	Minimum Thickness (Feet)	Maximum Thickness (Feet)	LNAPL Recovery (Gallons)	DNAPL Recovery (Gallons)
ES1-13	1	999.93	6.24	6.24	0	---	---	0	---	---	0.000	0.000
ES1-23R	1	989.94	3.10	3.10	0	---	---	0	---	---	0.000	0.000
GMA1-6	1	1,000.44	7.79	7.79	0	---	---	0	---	---	0.000	0.000
GMA1-7	1	985.81	11.60	11.60	0	---	---	0	---	---	0.000	0.000
GMA1-18	1	998.29	5.79	5.79	0	---	---	0	---	---	0.000	0.000
South Caisson	26	1,001.11	7.60	14.63	20	0.01	0.07	0	---	---	0.000	0.000
Lyman Street Area												
E-04	1	987.98	14.90	14.90	0	---	---	0	---	---	0.000	0.000
E-07	1	982.87	7.10	7.10	0	---	---	0	---	---	0.000	0.000
EPA-01	5	983.04	11.34	12.60	0	---	---	0	---	---	0.000	0.000
LS-12	1	985.49	12.70	12.70	0	---	---	1	0.02	0.02	0.000	0.000
LS-21	1	983.42	10.55	10.55	1	0.07	0.07	0	---	---	0.000	0.000
LS-29	1	988.25	14.02	14.02	0	---	---	0	---	---	0.000	0.000
LS-30	5	986.44	13.40	14.40	0	---	---	3	0.80	2.70	0.000	0.730
LS-31	5	987.09	13.05	14.50	3	0.03	0.40	4	0.22	1.02	0.065	0.080
LS-34	2	985.79	13.33	13.94	0	---	---	2	0.16	0.98	0.000	0.160
LS-38	5	986.95	14.78	16.06	0	---	---	0	---	---	0.000	0.000
LS-44	5	980.78	8.90	10.20	0	---	---	0	---	---	0.000	0.000
LSSC-06	1	984.91	11.10	11.10	0	---	---	0	---	---	0.000	0.000
LSSC-07	23	982.48	9.90	11.60	0	---	---	17	0.23	0.43	0.000	1.172
LSSC-08I	22	983.13	11.24	13.10	0	---	---	9	<0.01	0.04	0.000	0.023
LSSC-08S	5	983.11	11.50	12.82	0	---	---	0	---	---	0.000	0.000
LSSC-09	1	985.06	12.45	12.45	0	---	---	0	---	---	0.000	0.000
LSSC-16I	5	980.88	8.32	9.65	0	---	---	1	0.02	0.02	0.000	0.003
LSSC-16S	1	981.37	9.03	9.03	0	---	---	0	---	---	0.000	0.000
LSSC-18	5	987.32	13.68	14.97	0	---	---	0	---	---	0.000	0.000
LSSC-32	5	980.68	8.28	9.77	0	---	---	0	---	---	0.000	0.000
LSSC-33	5	980.49	8.35	9.60	0	---	---	0	---	---	0.000	0.000
LSSC-34I	2	984.74	12.68	13.08	0	---	---	2	0.02	0.23	0.000	0.000
LSSC-34S	1	985.01	13.00	13.00	0	---	---	0	---	---	0.000	0.000

Table 7
Groundwater Elevation and NAPL Monitoring/Recovery
Data Summary: Fall 2006

Addendum to NAPL Monitoring Report for Fall 2006
Plant Site 1 Groundwater Management Area
General Electric Company - Pittsfield, Massachusetts

Well Name	Number of Measurements	Measuring Point Elevation (Feet AMSL)	Depth to Water		LNAPL Observations			DNAPL Observations			Manual NAPL Recovery	
			Minimum (Feet AMP)	Maximum (Feet AMP)	Times Observed	Minimum Thickness (Feet)	Maximum Thickness (Feet)	Times Observed	Minimum Thickness (Feet)	Maximum Thickness (Feet)	LNAPL Recovery (Gallons)	DNAPL Recovery (Gallons)
MW-3R	1	983.54	10.35	10.35	0	---	---	0	---	---	0.000	0.000
MW-4R	2	980.82	8.80	9.78	0	---	---	0	---	---	0.000	0.000
MW-6R	1	985.14	11.25	11.25	0	---	---	0	---	---	0.000	0.000
RW-1	22	984.88	11.47	13.50	0	---	---	19	<0.01	0.29	0.000	0.000
RW-1(R)	22	985.07	14.69	16.80	1	0.01	0.01	1	1.07	1.07	0.000	0.000
RW-2	22	987.82	13.20	15.30	0	---	---	0	---	---	0.000	0.000
RW-3	23	984.08	16.23	17.04	22	0.01	0.20	0	---	---	0.000	0.000
BM-2A	26	986.32	15.20	16.58	0	---	---	0	---	---	0.000	0.000
Newell Street Area I												
FW-16R	1	986.51	13.70	13.70	0	---	---	0	---	---	0.000	0.000
IA-9R	1	984.14	10.96	10.96	0	---	---	0	---	---	0.000	0.000
MM-1	1	988.04	11.85	11.85	0	---	---	0	---	---	0.000	0.000
Newell Street Area II												
GMA1-8	3	981.66	9.15	10.11	0	---	---	0	---	---	0.000	0.000
GMA1-9	3	987.19	9.26	10.16	0	---	---	0	---	---	0.000	0.000
GMA1-25	3	985.53	13.15	14.20	0	---	---	0	---	---	0.000	0.000
GMA1-26	3	983.29	11.90	12.72	0	---	---	0	---	---	0.000	0.000
GMA1-27	3	983.49	8.32	8.94	0	---	---	0	---	---	0.000	0.000
GMA1-28	3	981.70	10.13	11.10	0	---	---	0	---	---	0.000	0.000
MW-1D	3	987.20	13.22	14.35	0	---	---	1	0.01	0.15	0.000	0.021
MW-1S	3	986.60	11.75	14.20	0	---	---	1	0.06	0.44	0.000	0.072
N2SC-01I	24	984.99	10.60	13.55	0	---	---	11	2.60	4.19	0.000	1.336
N2SC-01I(R)	22	985.98	13.26	16.21	0	---	---	18	0.16	2.54	0.000	2.130
N2SC-02	7	985.56	10.10	12.25	0	---	---	1	0.04	0.04	0.000	0.006
N2SC-03I	24	985.33	9.50	12.92	0	---	---	8	1.35	2.68	0.000	0.676
N2SC-03I(R)	24	986.08	12.56	14.40	0	---	---	18	0.25	2.75	0.000	0.000
N2SC-04	2	981.56	10.36	11.29	0	---	---	0	---	---	0.000	0.000
N2SC-07	7	984.61	9.25	11.40	0	---	---	3	0.10	0.51	0.000	0.116
N2SC-07S	3	982.93	10.09	11.15	0	---	---	0	---	---	0.000	0.000
N2SC-08	7	986.07	10.64	12.70	0	---	---	5	2.05	2.60	0.000	1.524

Table 7
Groundwater Elevation and NAPL Monitoring/Recovery
Data Summary: Fall 2006

Addendum to NAPL Monitoring Report for Fall 2006
Plant Site 1 Groundwater Management Area
General Electric Company - Pittsfield, Massachusetts

Well Name	Number of Measurements	Measuring Point Elevation (Feet AMSL)	Depth to Water		LNAPL Observations			DNAPL Observations			Manual NAPL Recovery	
			Minimum (Feet AMP)	Maximum (Feet AMP)	Times Observed	Minimum Thickness (Feet)	Maximum Thickness (Feet)	Times Observed	Minimum Thickness (Feet)	Maximum Thickness (Feet)	LNAPL Recovery (Gallons)	DNAPL Recovery (Gallons)
N2SC-09I	3	987.77	9.50	13.30	0	---	---	2	0.06	0.09	0.000	0.000
N2SC-09S	3	982.75	9.25	9.84	0	---	---	1	0.18	0.18	0.000	0.000
N2SC-13I	3	984.75	9.85	10.70	0	---	---	2	0.66	0.82	0.000	0.010
N2SC-14	22	985.06	13.18	15.15	0	---	---	19	0.50	2.05	0.000	0.000
N2SC-16	2	985.62	9.83	10.77	0	---	---	0	---	---	0.000	0.000
NS-10	4	987.14	13.05	16.20	4	0.17	0.61	0	---	---	0.659	0.000
NS-15R	24	N/A	9.70	12.24	0	---	---	0	---	---	0.000	0.000
NS-17	3	984.64	11.78	12.78	0	---	---	0	---	---	0.000	0.000
NS-20	3	985.29	5.95	6.50	0	---	---	0	---	---	0.000	0.000
NS-30	24	985.99	9.18	11.60	0	---	---	13	0.05	1.00	0.000	0.261
NS-32	23	986.20	10.20	12.45	0	---	---	11	0.03	0.45	0.000	0.119
NS-37	1	986.20	13.62	13.62	0	---	---	0	---	---	0.000	0.000
Silver Lake Area												
SLGW-1S	1	982.94	6.92	6.92	0	---	---	0	---	---	0.000	0.000
SLGW-1D	1	983.13	4.91	4.91	0	---	---	0	---	---	0.000	0.000
SLGW-2S	1	985.39	0.00	0.00	0	---	---	0	---	---	0.000	0.000
SLGW-2D	1	985.10	0.00	0.00	0	---	---	0	---	---	0.000	0.000
SLGW-3S	1	980.21	4.08	4.08	0	---	---	0	---	---	0.000	0.000
SLGW-3D	1	979.14	1.77	1.77	0	---	---	0	---	---	0.000	0.000
SLGW-4S	1	984.02	7.85	7.85	0	---	---	0	---	---	0.000	0.000
SLGW-4D	1	983.51	6.63	6.63	0	---	---	0	---	---	0.000	0.000
SLGW-5S	1	979.12	3.14	3.14	0	---	---	0	---	---	0.000	0.000
SLGW-5D	1	979.30	3.33	3.33	0	---	---	0	---	---	0.000	0.000
SLGW-6S	1	981.66	5.39	5.39	0	---	---	0	---	---	0.000	0.000
SLGW-6D	1	981.63	6.07	6.07	0	---	---	0	---	---	0.000	0.000
Silver Lake Gauge	26	980.30	3.68	4.98	0	---	---	0	---	---	0.000	0.000

NOTES:

1. This table replaces the version contained in the Plant Site 1 Groundwater Management Area NAPL Monitoring Report for Fall 2006 .
2. Measurements collected between July 1, 2006 and December 31, 2006.
3. Feet AMSL = Feet above mean sea level.
4. Feet BMP = Feet below measuring point.
5. N/A - Not Applicable

S:\2-05-LAF BMW PCB LAYER: ON=1 OFF=PRE*
 G:\CAD\GE-CAD\GE_ACTIVE\N\20136020\FALL06\20136W03.dwg SAVED:7/20/2007 10:50 AM LAYOUT:1 PAGESETUP:DLZB-PDF PENTABLE:PLTEULLCTB PRINTED:7/20/2007 10:51 AM BY:RBASSETT
 PLOT:13X01

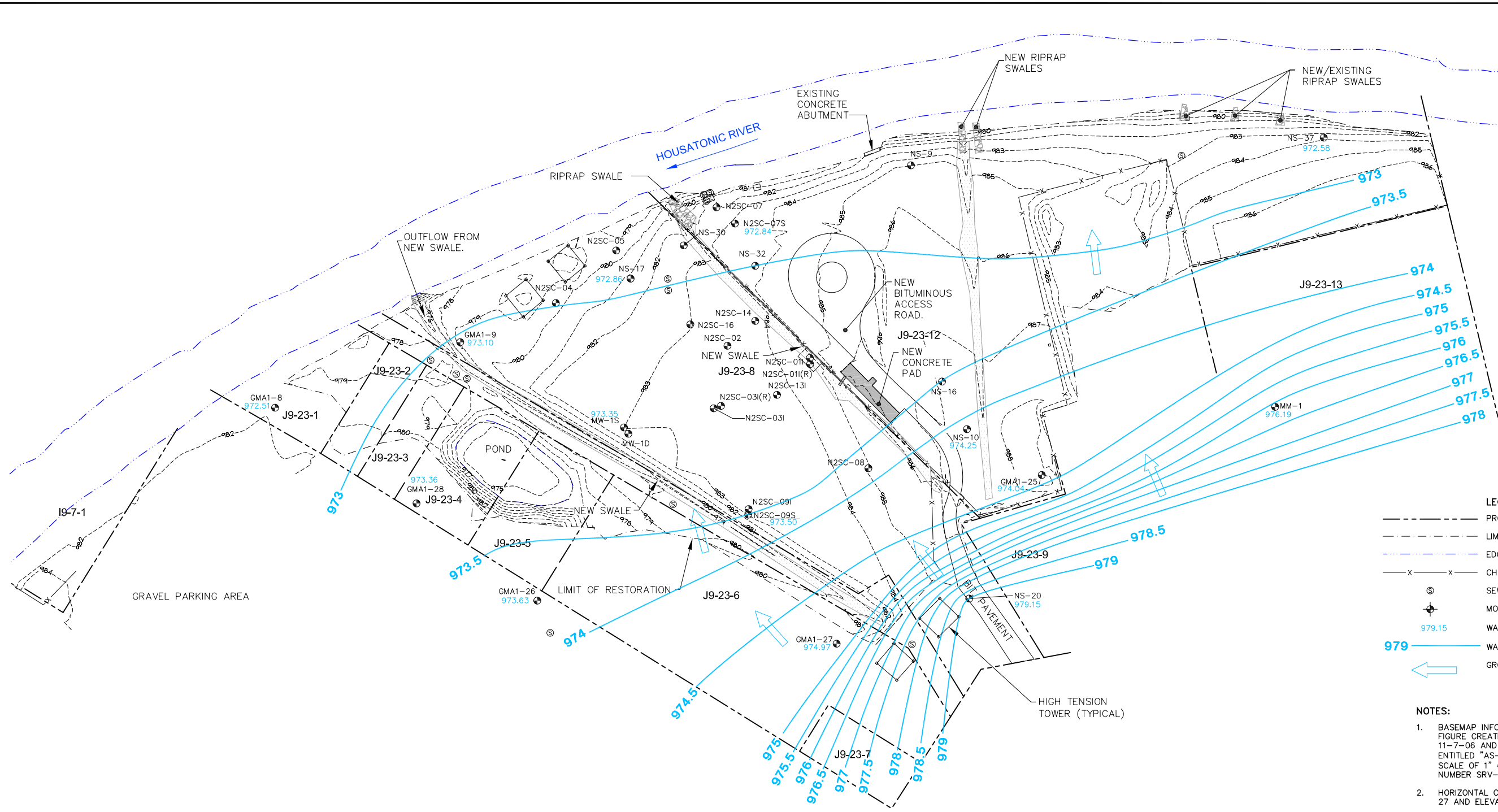

- LEGEND:**
- PROPERTY LINE
 - - - LIMIT OF AS-BUILT TOPOGRAPHIC SURVEY
 - EDGE OF WATER
 - x-x-x CHAINLINK FENCE
 - ⊙ SEWER MANHOLE
 - ⊕ MONITORING WELL
 - 979.15 WATER TABLE ELEVATION (FT.)
 - 979 WATER TABLE ELEVATION CONTOUR LINE (FT.)
 - ← GROUNDWATER FLOW DIRECTION

- NOTES:**
- BASEMAP INFORMATION OBTAINED FROM A FIGURE CREATED BY HILL ENGINEERS ON 11-7-06 AND LAST REVISED ON 1-2-07 ENTITLED "AS-BUILT SITE PLAN" AT A SCALE OF 1" = 50'. DRAWING FILE NUMBER SRV-1060-001.
 - HORIZONTAL COORDINATE SYSTEM IS NAD 27 AND ELEVATIONS ARE NGVD29.
 - GROUNDWATER ELEVATION DATA COLLECTED ON OCTOBER 23-24, 2006.



GENERAL ELECTRIC COMPANY
 PITTSFIELD, MASSACHUSETTS
GMA 1 NAPL MONITORING PROGRAM
NEWELL STREET AREA II
WATER TABLE CONTOUR MAP
FALL 2006



FIGURE
14