

**“KNOW BEFORE YOU GO”**

**FARNBOROUGH AIR SHOW 2008**



	Date	Time
Chalet Interiors:	Mon 9 June – Sat 12 July incl.	0800 hrs – 1900 hrs
Self-build Stand Interiors and Installation of Exhibits:	Mon 23 June.	0800 hrs – 1900 hrs
All works to be completed by	Sat 12 July	1900 hrs

#### Exhibition Programme

U.S. VIP Welcome Reception (U.S. Pavilion Lounge-Hall 2)	Mon 14 July	0930 hrs – 1030 hrs
U.S. Pavilion opening ceremony/ ribbon cutting (Hall 2)	Mon 14 July	1030 hrs – 1130 hrs
Media/Private Trade Day/Industry Day	Mon 14 July	1000 hrs – 1600 hrs
Private Trade Days	Tues 15 – Fri 18 July	0930 hrs – 1730 hrs
U.S. Ambassador's Reception at Winfield House	Tues 15 July	1900 hrs – 2100 hrs
	Flying Display	1415 hrs – 1645 hrs
Public Days	Sat 19 – Sun 20 July	0930 hrs – 1730 hrs
	Flying Display	1230 hrs – 1730 hrs
Dismantling	Dates	Times
Removal of exhibits, fittings, etc.	Mon 21 – Fri 25 July	0800 hrs – 1800 hrs
Site closes:	Fri 25 July	1800 hrs

# Farnborough International Airshow 2006

## Main Exhibition Complex

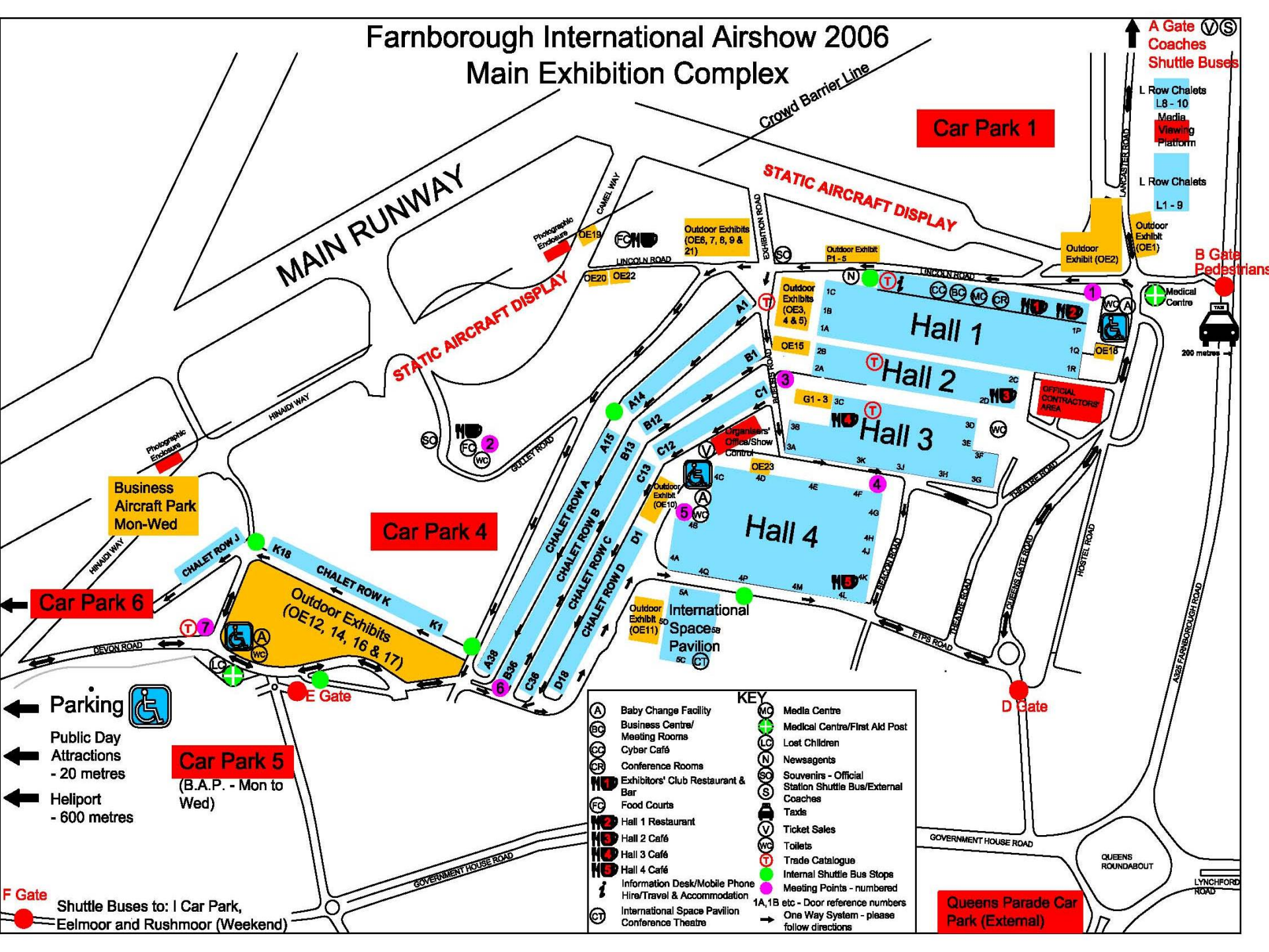

**MAIN RUNWAY**

**Crowd Barrier Line**

**Car Park 1**

**STATIC AIRCRAFT DISPLAY**

**STATIC AIRCRAFT DISPLAY**

**A Gate** (V) (S)  
Coaches  
Shuttle Buses

L Row Chalets  
L8 - 10  
Media Viewing Platform  
L Row Chalets  
L1 - 9

**B Gate**  
Pedestrians

**Car Park 4**

**Hall 1**  
**Hall 2**  
**Hall 3**

**Business Aircraft Park**  
Mon-Wed

**Car Park 6**

**CHALET ROW J**  
**CHALET ROW K**  
**Outdoor Exhibits**  
(OE12, 14, 16 & 17)

**Car Park 4**

**International Space Pavilion**

**Organisers' Office/Show Control**

**OFFICIAL CONTRACTORS' AREA**

**Car Park 5**  
(B.A.P. - Mon to Wed)

**Queens Parade Car Park (External)**

**Parking** (Wheelchair icon)

**Public Day Attractions**  
- 20 metres

**Heliport**  
- 600 metres

**F Gate**  
Shuttle Buses to: 1 Car Park, Eelmoor and Rushmoor (Weekend)

KEY	
(A)	Baby Change Facility
(BC)	Business Centre/ Meeting Rooms
(CC)	Cyber Café
(CR)	Conference Rooms
(FC)	Exhibitors' Club Restaurant & Bar
(FC)	Food Courts
(H1)	Hall 1 Restaurant
(H2)	Hall 2 Café
(H3)	Hall 3 Café
(H4)	Hall 4 Café
(I)	Information Desk/Mobile Phone Hire/Travel & Accommodation
(CT)	International Space Pavilion Conference Theatre
(MC)	Media Centre
(MCP)	Medical Centre/First Aid Post
(LC)	Lost Children
(N)	Newsagents
(SO)	Souvenirs - Official Station Shuttle Bus/External Coaches
(S)	Taxis
(V)	Ticket Sales
(WC)	Toilets
(T)	Trade Catalogue
(N)	Internal Shuttle Bus Stops
(M)	Meeting Points - numbered
(1A, 1B etc)	Door reference numbers
(→)	One Way System - please follow directions

# Location of the U.S. International Pavilion

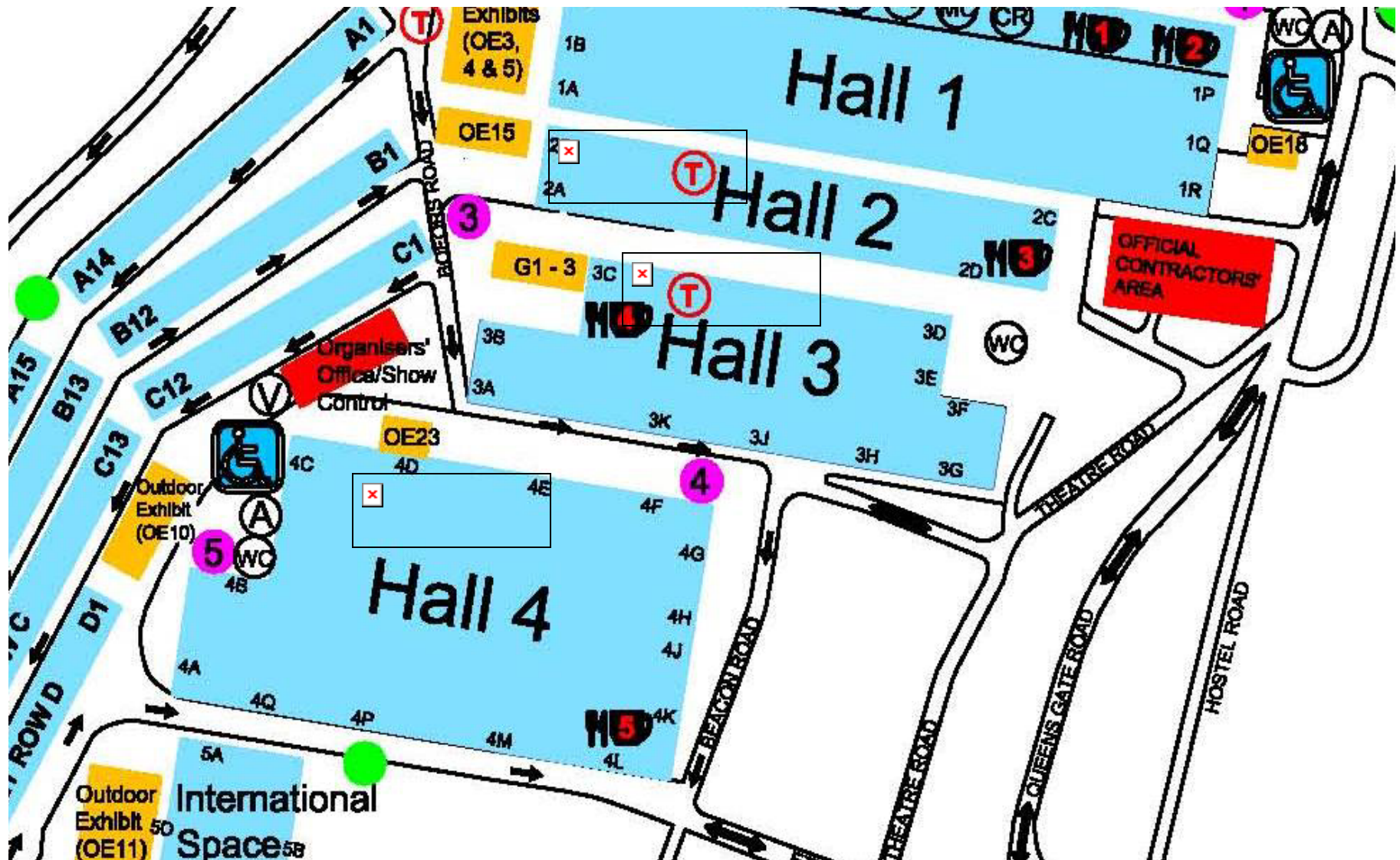

For general information on getting to/from the show visit:

[www.farnborough.com](http://www.farnborough.com)



# Farnborough International 2008 US International Pavilion Halls 2 & 3

working draft as of 05/21/08  
Floor plan subject to change

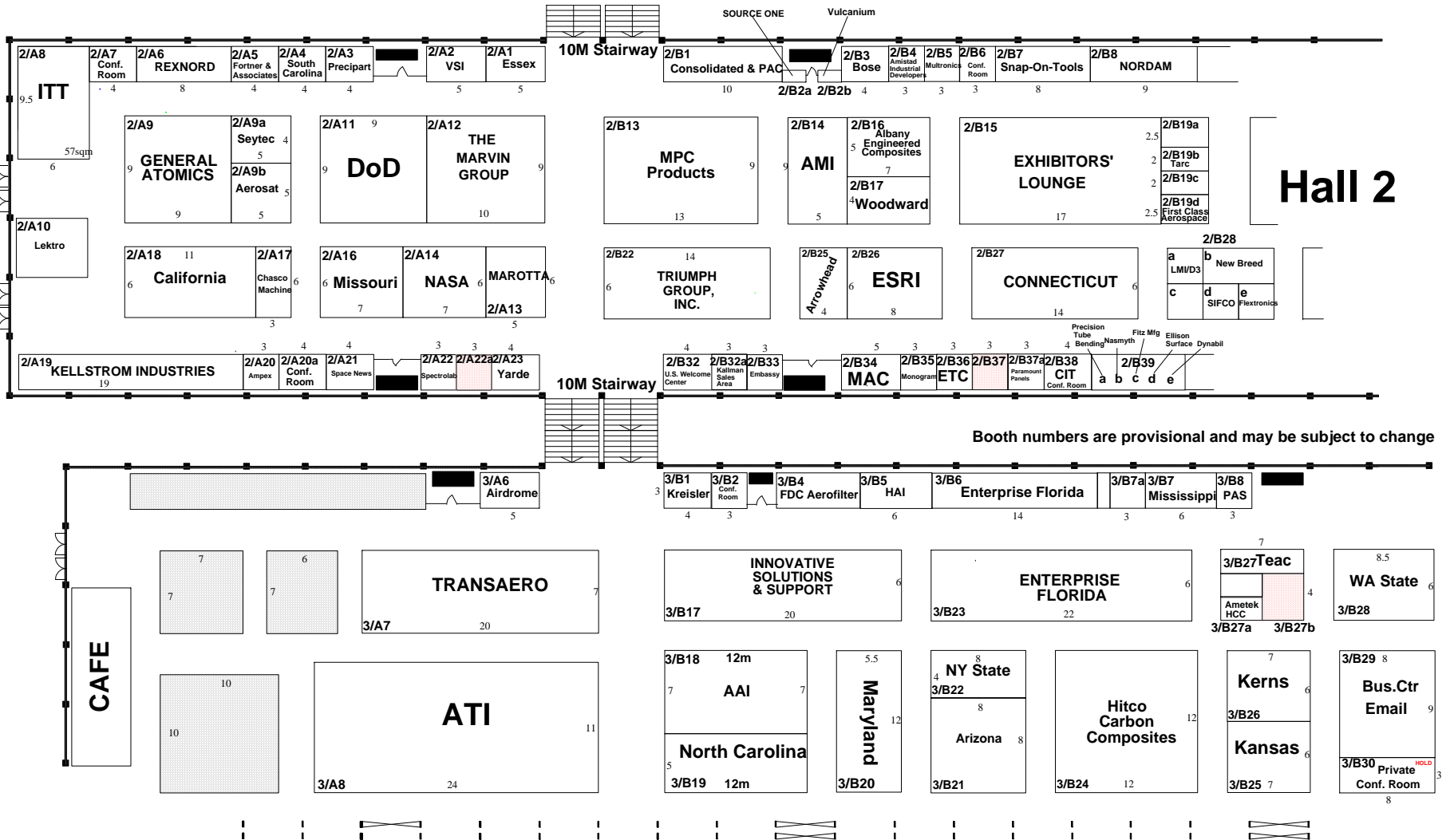

# Farnborough International 2008 US International Pavilion Hall 4

working draft as of 05/14/08

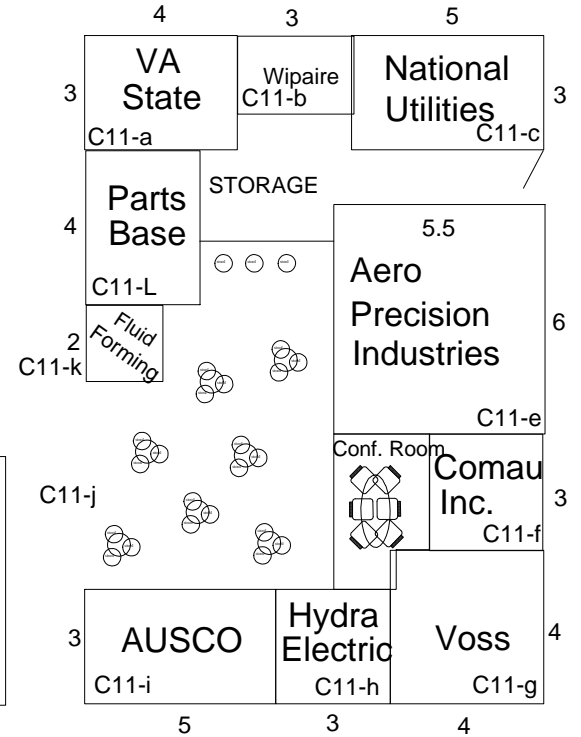
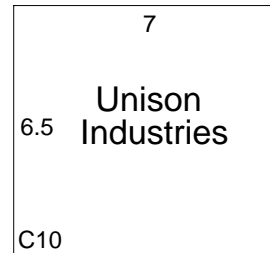
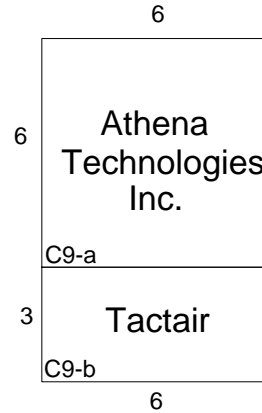
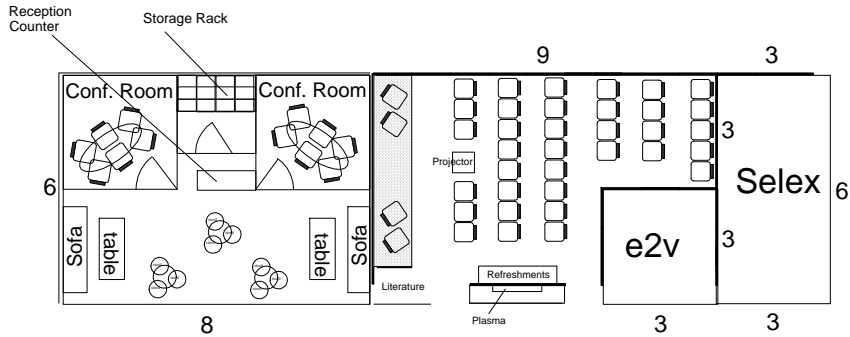

# Kallman Worldwide Key Personnel

(+1 201-251-2600)



- Tom Kallman, President & CEO
- Gerri Cozic, Aerospace & Defense Program Manager: ext 122
- Michael Petrassi, Sales Associate: ext 105
- Ann Kallman, Operations Manager: ext 124
- Rosemary Billies, Exhibitor Services: ext 111
- Dona McAvoy, Exhibitor Services: ext 112