

(Cover)



**LG BlueBAND R**  
**BHS-200**



**User Guide**

**Project No. : C51-A05133-XX**  
**(Draft Version 1 – 20-Apr-2006)**

**Contents**

LG BHS-200 Overview	2
Getting Started	3
Charging Your Earphone Normal Charging Time Talk Time, Music Play Time and Standby Time Low Battery	4-5
Turning Your Earphone On and Off	6
Pairing Your Earphone	7-8
Using Your Earphone Answering a Call Answering a Call when Listening to Stereo Audio Ending a Call Rejecting a Call Dialling from Your Mobile Handset Voice Dialling from Your Earphone Last Number Redial from Your Earphone Listening to Stereo Audio	9-10
Adjusting the Volume	11
Resetting / Removing the Pairing	11
Remote Control Function	12
Care and Maintenance	13-14
Safety Information	15
Troubleshooting	16
Declaration of Conformity (DoC)	17
Product Specifications	18

(Page 1)

## LG BHS-200 Overview

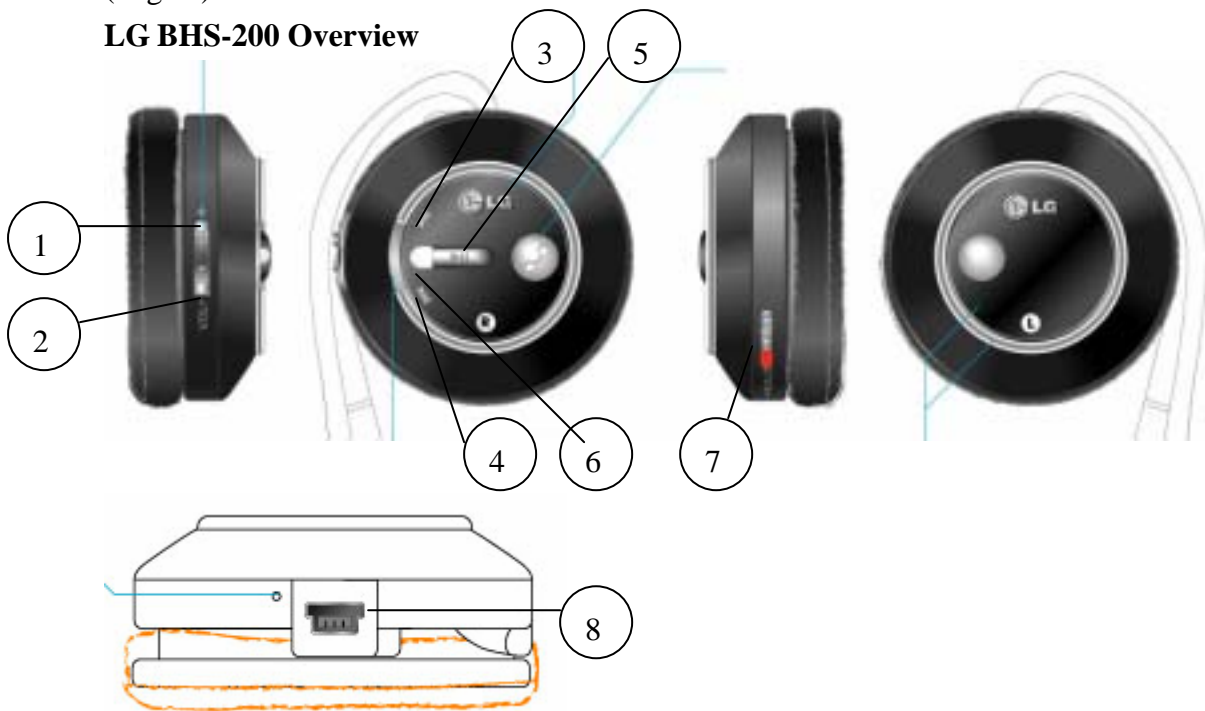

Fig. 1

- |                   |                     |
|-------------------|---------------------|
| 1. Volume Key (+) | 5. Play / Pause Key |
| 2. Volume Key (-) | 6. Status Indicator |
| 3. Forward Key    | 7. Hold Key         |
| 4. Backward Key   | 8. Charging Socket  |

### Getting Started

To use your LG BHS-200 Earphone (“Earphone”), please follow these simple steps:

- ✧ Charge your earphone
- ✧ Pair your earphone with a Bluetooth-enabled mobile handset or music player

(Page 2)

**Wearing Your LG BHS-200 Earphone**



Fig. 2 Wearing your Earphone

### Charging Your Earphone

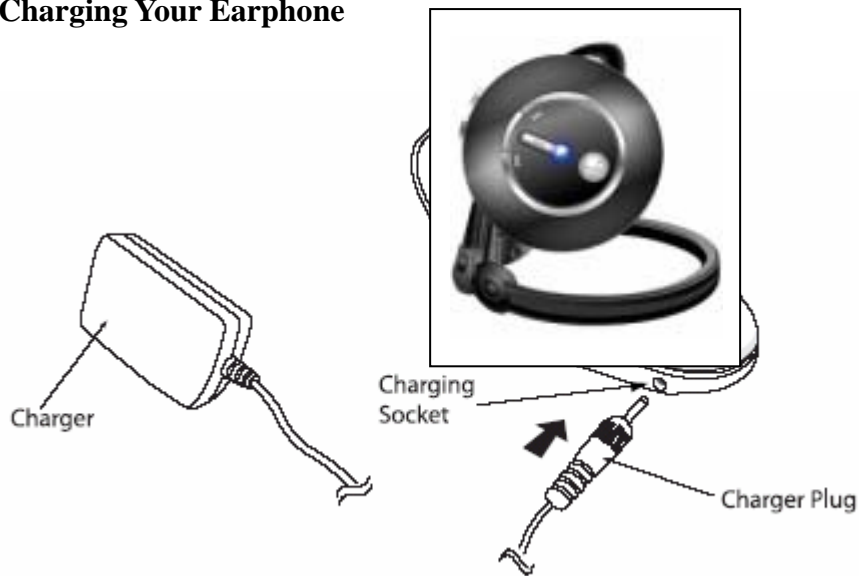

Fig. 4

The Earphone comes with a built-in rechargeable battery. Prior to using the headset, it is recommendable to charge the battery fully for the first time.

### **Charging Your Earphone**

Connect the charger to an AC wall outlet and the charger plug to the headset's charging socket (fig.4). The **LED** will be red while charging.

**IMPORTANT** Charging indication will be delayed for a few seconds if the headset has not been used for a long time or the battery is drained.

### **Normal Charging Time**

Charging the battery fully is normally within 3 hours. When the battery is fully charged, the **LED** will turn blue and remains on. Disconnect the charger from AC wall outlet and the headset. Press and hold the **MFB** (fig.1) for 2 seconds to turn the headset on, please refer to "Turning Your Earphone On and Off" on the next page. For pairing, please refer to "Pairing your earphone".

### **Talk Time, Music Play Time & Standby Time**

The fully charged battery offers up to **7.5** hours talk time, music play time and up to 150 hours standby time. When no calls are in progress, the headset remains turned on in standby mode.

### **Low Battery**

When the headset is on and the battery becomes low, the **LED** flashes red and the headset emits a beep every 1 minute. Please recharge the battery as described above.

## **Turning Your Earphone On and Off**

### **Turning On the Earphone**

Press and hold the **MFB** for 2 seconds until you hear a short beep. The **LED** will flash blue.

**IMPORTANT** Press the **MFB** again each time you turn on the headset to reactivate pairing so that the connection between the headset and the mobile handset is resumed. For pairing, please refer to “Pairing Your Earphone” on page 7-8.

### **Turning Off the Earphone**

Press and hold the **MFB** for 3 seconds until you hear a long beep. The **LED** flash stops.

**IMPORTANT** To disconnect the Bluetooth connection, please firstly turn off your headset by pressing the **MFB** key.

## Pairing Your Earphone

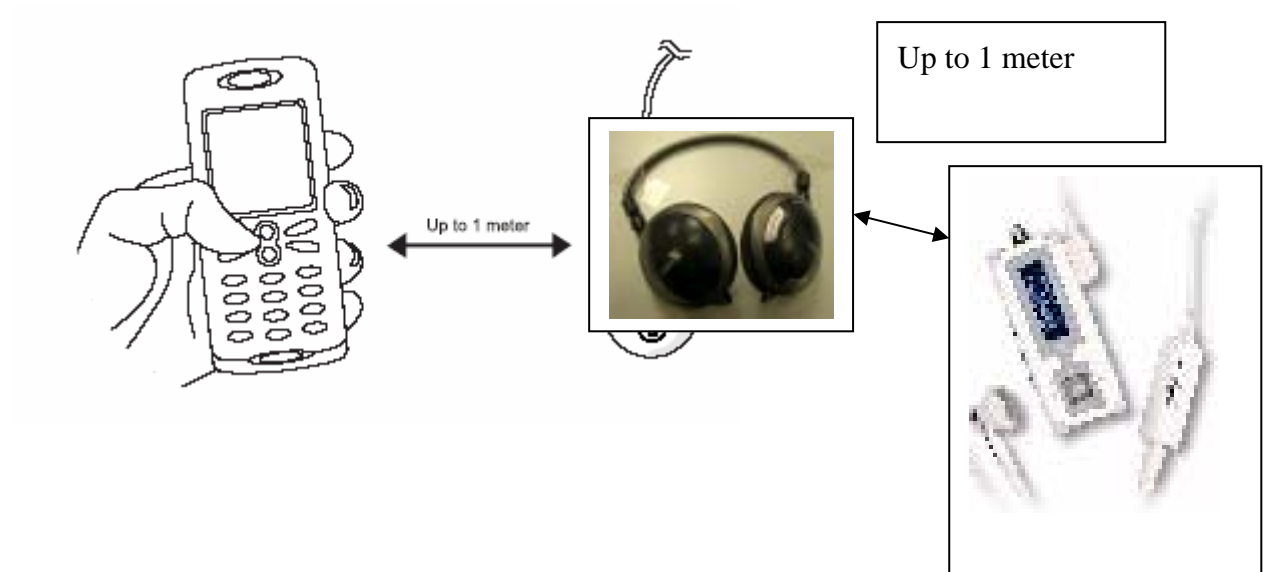

Prior to using your Earphone for the first time, you must pair it with a Bluetooth-enabled mobile handset or Music Player (The “Device”).

The information on the next page describes pairing instruction for typical Bluetooth-enabled mobile handset or music player. Earphone pairing procedure is subject to different models of mobile handsets and music player.



## Pairing Your Earphone

1. Place the Earphone and the device where they are easily viewable by no more than 1 meter apart.
2. Ensure the earphone is OFF.
3. Press and hold the **MFB** until the earphone **Status Indicator** alternately flashes blue and red.
4. Activate your mobile handset's Bluetooth function by referring to your mobile handset user guide for details.
5. Set the device to search for Bluetooth devices within about 1 meter as instructed in the mobile handset user guide and select "**LG BHS-200**" from the list.
6. Enter the preprogrammed passkey "**0000**" and press "OK" to pair your earphone and device. When the pairing is complete, the earphone **Status Indicator** will flash blue rapidly for 5 times followed by a long beep.
7. Go back to your device's main menu. For certain device models, a headset / audio icon will be shown on the screen. You should now be able to make and receive calls using your earphone and listen stereo music via your earphone.

**IMPORTANT** If the pairing cannot be completed within 2 minutes while the pairing mode is activated, the earphone status indicator flashes purple red with 3 beeps and the headset is turned off. Please repeat Steps 2 to 7 to pair the headset and the mobile handset again.

## Using Your Earphone

### Answering a Call

When there is an incoming call, you will hear ringing through the earphone. Press the **MFB** to accept the call or answer the call via your mobile handset in the normal way.

### Answering a Call when Listening to Stereo Audio

Press the **MFB** once to answer the call and when finished, press the **MFB** once to resume stereo audio.

If the other party you are speaking to ends the call, stereo audio will automatically resume without having to pressing the **MFB**.

**NOTE To receive stereo audio from your mobile handset or PDA, please make sure they support the Bluetooth A2DP profile.**

### Ending a Call

Press the **MFB** to end your call or end the call via your mobile handset in the normal way.

### Rejecting a Call

To reject an incoming call during ringing of the headset, press and hold the **Volume Key** for 2 seconds until you hear 2 beeps.

### Dialing from Your Mobile Handset

Simply make calls on your mobile handset in the normal way.

## **Using Your Earphone**

### **Voice Dialing from Your Earphone**

If your mobile handset is equipped with a voice dialling function, simply press the **MFB** on your headset and when you hear a beep, say the voice tag.

**IMPORTANT** Please make sure to record voice tag into the mobile handset first before using voice dialling function.

### **Last Number Redialling from Your Headset**

Press the **MFB** on your headset twice.

**IMPORTANT** The above functions are only applicable to mobile handsets with **Bluetooth Handsfree Profile**. Functionality varies depending on the mobile handset model you have. Please refer to your mobile handset user guide for additional information.

### **Listening to Stereo Audio from Your PC / Device**

By connecting you earphone to your PC through i.Tech mini Bluetooth USB Dongle v1.2, you can listen to stereo audio from your PC (please refer USB Dongle v1.2 Quick User Guide).

By connecting you earphone to your Bluetooth-enabled music devices, you can listen to stereo music from your music devices (please also refer your music player user guide).

### Adjusting the Volume

Press the **Volume Key** repeatedly until you reach the desired volume level.

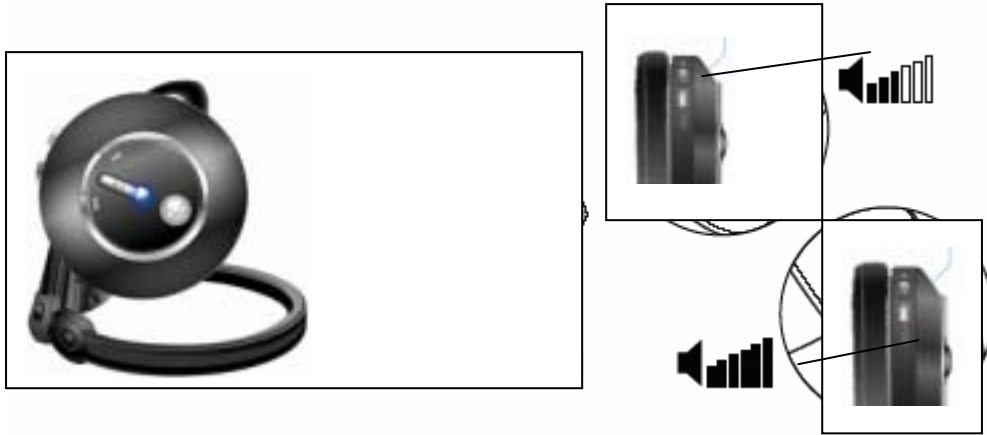

### Resetting / Removing the Pairing

You may want to reset the headset to its original settings. This also clears all current pairings.

1. Ensure the headset is OFF.
2. Press and hold the **Volume Key** 20 seconds until the **Status Indicator** alternately flashes blue and red rapidly.
3. Release the **Volume Key**.
4. Press and hold the **Volume Key** again until you hear 2 beeps.
5. Recharge the headset for a few seconds

The headset is turned off and returns to the original settings. All current pairings are cleared.

## **Remote Control Function (AVRCP)**

### **Play / Pause**

1. Press once for start music playing
2. Press once again for pause the music playing

### **Volume Control**

By pressing the “+” to increase the audio volume. By pressing the “-“ to decrease the audio volume. Total audio level is 12.

### **Forward**

By scrolling the panel upward to skip next chapter or forward selecting the chapter.

### **Backward**

By scrolling the panel downward to repeat last chapter or backward selecting the chapter.

## Care and Maintenance

### Earphone

- ✧ Consider turning your earphone off before placing it in your pocket or bag. If the **MFB** is accidentally depressed, your mobile handset may place an unintended call.
- ✧ Do not expose the earphone to liquid, moisture or humidity as it is not waterproof.
- ✧ Do not use abrasive cleaning solvents to clean the earphone.
- ✧ Do not expose the earphone to extremely high or low temperatures.
- ✧ Do not dispose of the earphone in a fire as it will result in explosion.
- ✧ Do not expose your earphone to contact with sharp objects as this will cause scratches and damage.
- ✧ Do not stick anything inside the earphone as this may damage internal components.
- ✧ Do not attempt to disassemble the earphone as it does not contain serviceable components.
- ✧ If you do not use the earphone for long periods, be sure to store it in a dry place, free from extreme temperatures and dust.

### **Built-in Battery**

- ✧ Do not attempt to replace the earphone's battery yourself as it is in-built and is not changeable.
- ✧ Charge the battery in accordance with the instruction supplied with this user guide.
- ✧ Only use the manufacturer supplied charger when charging the earphone.

### **Charger**

- ✧ Only use the manufacturer supplied charger when charging the earphone.
- ✧ Do not disassemble the charger as it may expose you to dangerous voltages of other risks. Incorrect reassembly can cause electric shock when the earphone is subsequently used.
- ✧ Do not use the charger outdoors or in damp areas.
- ✧ Only charge the earphone's built-in battery in accordance with the instructions of this user guide.
- ✧ Avoid charging the earphone in extremely high and low temperatures.

## **Safety Information**

- ✧ Check local laws regarding use of a mobile handset and earphone while driving. If you use the earphone while driving, ensure your attention and focus remains on your responsibility of driving safely.
- ✧ Never allow children to play with the earphone – small parts may be a choking hazard.
- ✧ Observe all signs that require an electrical device or RF radio product to be switched off in designated areas. These could include hospitals, blasting areas, and potentially explosive atmospheres.
- ✧ Turn off your earphone prior to boarding an aircraft. Do not use your earphone in an aircraft.
- ✧ Never mount or store your earphone over any air bag deployment area as serious injury may result when an air bag deploys.
- ✧ Do not open or mutilate the built-in battery.
- ✧ **Dispose of batteries according to local regulations. Do not dispose as household waste**



## **Troubleshooting**

If you are unable to connect your earphone and mobile handset, please try the following:

- ✧ Ensure your earphone is turned off and is properly charged.
- ✧ Ensure the earphone is paired with your mobile handset.
- ✧ Ensure your mobile handset's Bluetooth feature is activated. Please refer to your mobile handset user guide for specific instruction.
- ✧ Ensure the earphone is within a maximum of 10 meters of your mobile handset(s) and there are no obstructions, such as walls or other electronic devices in between.

If the above steps do not solve your problem, please recharge the earphone and remove your mobile handset battery for a while.

The LG BHS-200 Earphone is compliant with and adopts the Bluetooth Specification 1.2. However, interoperability between the device and other Bluetooth-enabled products is not guaranteed because it depends on compatibility. For more information on the compatibility between the device with other Bluetooth-enabled products, please check with the manufacturer or browse <http://www.itechdynamic.com>

## **Declaration of Conformity (DOC)**

We, i.Tech Dynamic Ltd., declare that the following product:

Product Name: LG BHS-200

Model No.: C51-A05133-XX

Is in conformity with the following essential requirements of Council Directive 1999/5/EC (referred to as R&TTE Directive): Article 3.1a, 3.1.b and 3.2. and the product is manufactured in accordance with Annex II of the above directive.

A copy of the Declaration of Conformity can be found at:

<http://www.itechdynamic.com>

**Product Specifications**

Bluetooth Specification:	Version 1.2 Class 2
Bluetooth Profile Supported:	Earphone, Handsfree, A2DP and AVRCP
Range of Frequency:	2.4GHz Spectrum
Dimensions:	??? mm (L) x ??? mm (W) x ??? mm (H)
Nominal Charging Time:	Within 3 hours
Talk Time*:	Up to 7.5 hours
Music Play Time*:	Up to 7.5 hours
Standby Time*:	Up to 150 hours
Weight:	??? grams

\*may vary due to users' operation mode and mobile phone settings

(Back Cover)

© 2005 Hutchison Harbour Ring Enterprises Limited

All rights in this publication are reserved and no part may be reproduced without the prior written permission of the publisher. The contents of this publication are believed to be correct at the time of going to press, but any information, specifications, products or services mentioned may be modified, supplemented or withdrawn without further notice.

The Stylized i.Tech logos are trademarks owned by Hutchison Harbour Ring Enterprises Limited or its affiliates.

Bluetooth<sup>®</sup> and the Bluetooth logos are trademarks owned by Bluetooth SIG, Inc, USA and licensed to i.Tech Dynamic Limited.

This device complies with Part 15 of the FCC Rules. Operation is subject to the following two conditions:

- (1) this device may not cause harmful interference, and
- (2) this device must accept any interference received, including interference that may cause undesired operation.

Caution: Changes or modifications not expressly approved by the party responsible for compliance could void the user's authority to operate the equipment.

**FCC RF Radiation Exposure Statement:**

This equipment complies with FCC radiation exposure limits set forth for an uncontrolled environment. End users must follow the specific operating instructions for satisfying RF exposure compliance. This transmitter must not be co-located or operating in conjunction with any other antenna or transmitter.

i.Tech declares under our sole responsibility that the earphone is in conformity with the provisions of the following Council Directives: 1999/5/EC

Printed in China