

### 2003 - 2004 SCHOOL DISTRICT VERIFICATION MAP

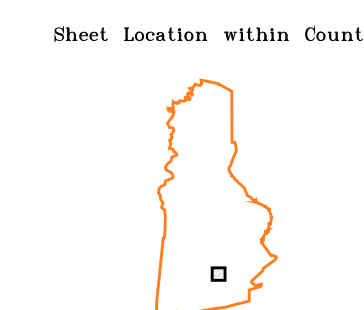
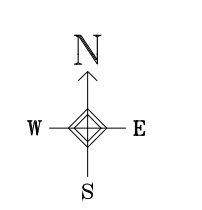
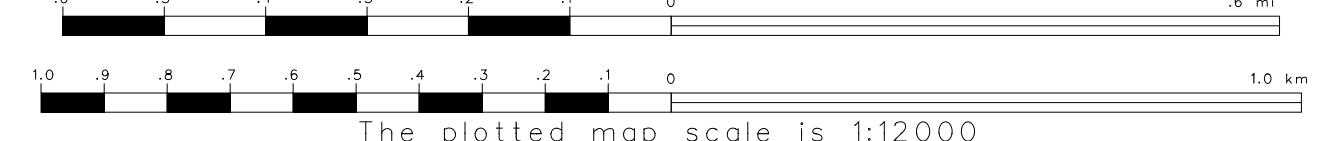
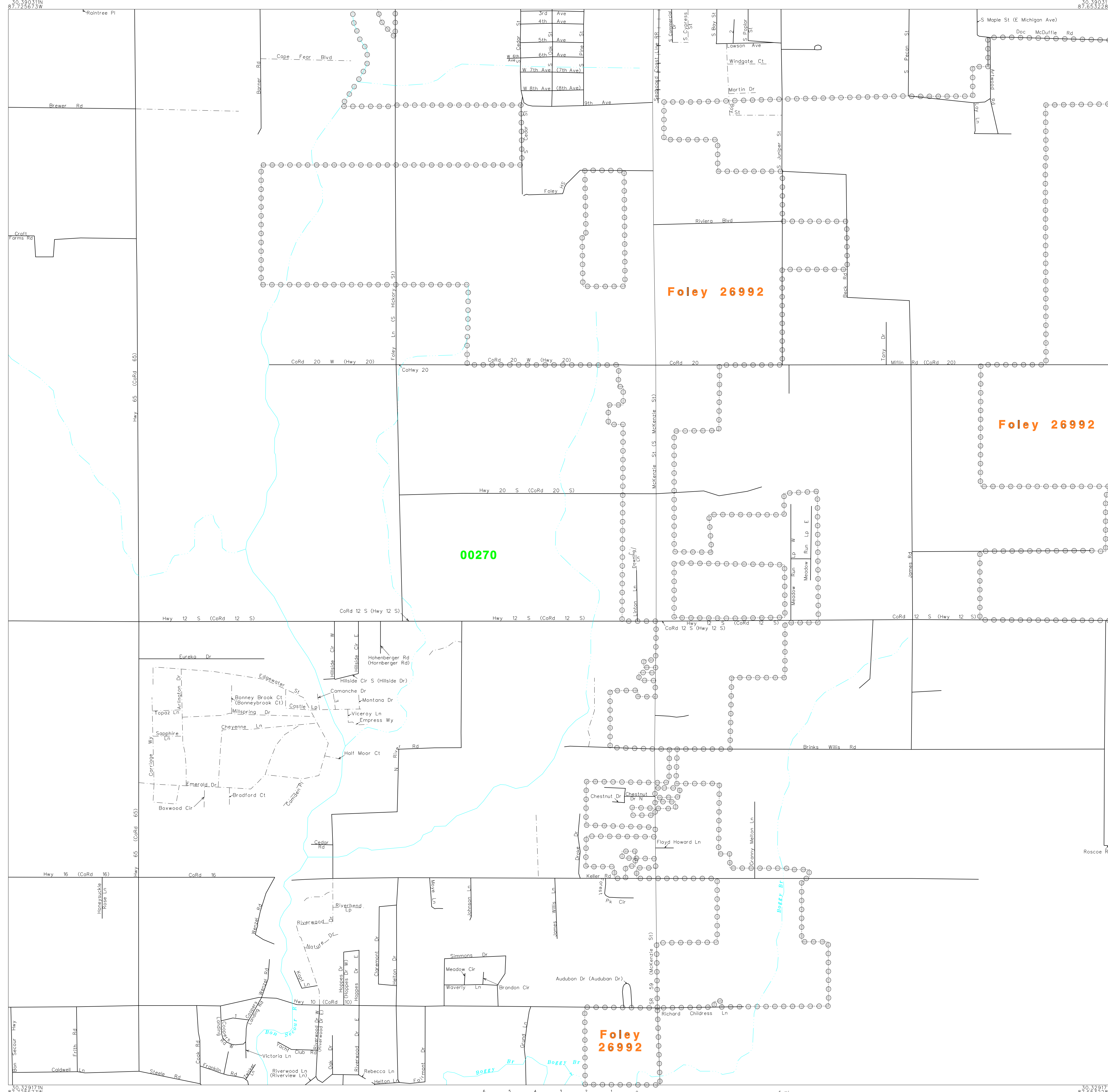

SYMBOL DESCRIPTION	SYMBOL	NAME STYLE
INTERNATIONAL	☆☆☆☆☆☆☆☆	INTERNATIONAL
AMERICAN INDIAN RESERVATION	☆☆☆☆☆☆☆☆	AMERICAN INDIAN RESERVATION
ALASKA NATIVE REGIONAL CORPORATION	◇◇◇◇◇◇◇◇	ALASKA NATIVE REGIONAL CORPORATION
STATE <sup>1</sup>	▨▨▨▨▨▨▨▨	STATE
COUNTY <sup>1</sup>	▣▣▣▣▣▣▣▣	COUNTY
MINOR CIVIL DIVISION <sup>2</sup>	○ ○ ○ ○ ○ ○ ○ ○	MINOR CIVIL DIVISION
Incorporated Place	○ ○ ○ ○ ○ ○ ○ ○	<b>Incorporated Place</b>
Unified School District	▬▬▬▬▬▬▬▬	<b>Unified School District</b>
Secondary School District	▬▬▬▬▬▬▬▬	<b>Secondary School District</b>
Elementary School District	▬▬▬▬▬▬▬▬	<b>Elementary School District</b>
Interstate and Limited Access Highway	▬▬▬▬▬▬▬▬	Interstate and Limited Access Highway
US Highway or Secondary Road	▬▬▬▬▬▬▬▬	U.S. Highway or Secondary Road
County or Connecting Road	▬▬▬▬▬▬▬▬	County or Connecting Road
Neighborhood Road or City Street	▬▬▬▬▬▬▬▬	Neighborhood Road or City Street
Railroad	▬▬▬▬▬▬▬▬	Railroad
Perennial Stream/Shoreline	▬▬▬▬▬▬▬▬	Perennial Stream/Shoreline
Intermittent Stream/Shoreline	▬▬▬▬▬▬▬▬	Intermittent Stream/Shoreline
Pipeline or Powerline	▬▬▬▬▬▬▬▬	Pipeline or Powerline
Property Line	▬▬▬▬▬▬▬▬	Property Line
River, Lake, or Other Water	▬▬▬▬▬▬▬▬	River, Lake, or Other Water
Military	▬▬▬▬▬▬▬▬	Military
Park/National Park	▬▬▬▬▬▬▬▬	Park/National Park
INSET A	▬▬▬▬▬▬▬▬	INSET A
Outside Jurisdiction	▬▬▬▬▬▬▬▬	Outside Jurisdiction

<sup>1</sup> State or County; or their equivalent area for statistical purposes.  
<sup>2</sup> A five-sided material following a minor civil division name indicates that the minor civil division is coextensive with an incorporated place and has the same name.

Code	Name
00270	BALDWIN COUNTY SCHOOL DISTRICT

KEY TO LINEAR FEATURE NAMES

1	Coopers Landing Rd	3	Wyoming St
2	Canterberry Cr		

ST: Alabama (01)  
 COU: Baldwin County (003)

INSET SHEET E03

(SDV03) 0600100369030000000