



# Security Door Openings (SDO)

- **MATRIX**
- **TYPES**
- **SCHEDULE**

The Security Door Opening (SDO) Matrix provides a summary of the primary components and functional requirements for the various opening types found in VA facilities. The Matrix is organized by facility type and entry type and is used in conjunction with the Security Door Opening Schedule and the Security Door Types. The Security Door Opening Schedule identifies specific hardware devices and operational requirements for each opening type. The Security Door Types describes the doors and the placement of hardware devices that may be installed on or near the door to make the secured opening function properly.



BUILDING EXTERIOR

Facility Type	Entry Type	SDO	Locations and Descriptions	Facility Classification	Access Control				Monitoring		Other	
					Card Reader	Fail Safe	Fail Secure	Other	ANSI/BHMA* or other function	Door Contact		Other
Hospital ACC Outpatient Clinic NHCU	Public Entrance	101.A	Exterior to Building Main Entrance Lobby with emergency egress Single, opaque, or framed glass	LSP New	yes	X			Magnetic lock or electric strike	yes		
		101.B		LSP Existing	yes	X			Magnetic lock or electric strike	yes		
		101.C			Pair, opaque, or framed glass							
		101.D			Pair, laminated glass (frameless)							
VBA Where VA is the only tenant	Public Entrance	101.A	Exterior to Building Main Entrance Lobby with emergency egress Single, opaque, or framed glass	LSP New	yes	X			Magnetic lock or electric strike	yes		
		101.B		LSP Existing	yes	X			Magnetic lock or electric strike	yes		
		101.C			Pair, opaque, or framed glass							
		101.D			Pair, laminated glass (frameless)							
Hospital ACC Outpatient Clinic NHCU	Staff Entrance	103.A	Exterior to Secondary Building Entrance with emergency egress Single, opaque, or framed glass	LSP New	yes	X			Mag. lock, elec. strike, or F04 entry	yes		Alarmed exit
		103.B		LSP Existing	yes	X			Mag. lock, elec. strike, or F04 entry	yes		Alarmed exit
		103.C			Pair, opaque, or framed glass							
		103.D			Pair, laminated glass (frameless)							
VBA Where VA is the only tenant	Staff Entrance	103.A	Exterior to Secondary Building Entrance with emergency egress Single, opaque, or framed glass	LSP New	no				Push-button comb. or F04 entry	yes		Alarmed exit
		103.B		LSP Existing	no				Push-button comb. or F04 entry	yes		Alarmed exit
		103.C			Pair, opaque, or framed glass							
		103.D			Pair, laminated glass (frameless)							
Research Facilities and Vivariums	Staff Entrance	102.A	Exterior to Secondary Building Entrance with emergency egress Single, opaque, or framed glass	LSP New	yes	X			Magnetic lock or electric strike	yes		Alarmed exit
		102.C		LSP Existing	yes	X			Magnetic lock or electric strike	yes		Alarmed exit
Hospital ACC Outpatient Clinic NHCU VBA	Egress	104.A	Exterior emergency egress only– no access from exterior Single, opaque, or framed glass	LSP New	no				Exit 01	yes		Alarmed exit
		104.C		LSP Existing	no				Exit 01	yes		Alarmed exit
Hospital ACC Outpatient Clinic NHCU VBA	Loading Dock	107.A	Exterior from Loading Dock area to Building Interior - pedestrian only Single opaque or framed glass	LSP New	no				Push-button combination or F07 Storeroom	yes	Hold open alarm	
		107.C		LSP Existing	no				Push-button combination or F07 Storeroom	yes		
Hospital ACC Outpatient Clinic NHCU VBA	Loading Dock	108.0	Exterior from Loading Dock area to Building Interior - equipment and material deliveries Overhead coiling steel	LSP New	yes					yes		
				LSP Existing	yes					yes		

\* References for ANSI/BHMA Designations: "F-\_\_"– ANSI/BHMA A156.13; "Exit \_\_"– ANSI/BHMA A156.3

BUILDING EXTERIOR (continued)

Facility Type	Entry Type	SDO	Locations and Descriptions	Facility Classification	Access Control				Monitoring		Other
					Card Reader	Fail Safe	Fail Secure	Other	ANSI/BHMA* or other function	Door Contact	
Hospital ACC Outpatient Clinic NHCU	Storage	109.A 109.C	Exterior to Storage only with no entrance to building Single opaque Pair opaque	LSP New	no				F07 Storeroom or card reader	yes	
				LSP Existing	no				F07 Storeroom or card reader	yes	
Hospital ACC Outpatient Clinic NHCU VBA	Emergency Access	110.A	Exterior to Building or Fire Control Center Single opaque or framed glass	LSP New	no			Secure Key Storage	F07 Storeroom	no	
				LSP Existing	no			Secure Key Storage	F07 Storeroom	no	
Hospital ACC Outpatient Clinic NHCU VBA	Tunnel	111.A	Exterior to Utility Tunnel Single opaque	LSP New	no				F07 Storeroom	yes	IDS with alarm
				LSP Existing	no				F07 Storeroom	yes	IDS with alarm
Child Care/ Development Center	Child Care	112.A 112.B 112.C 112.D	Exterior to Main Entrance and exit Single, opaque, or framed glass Single, laminated glass (frameless) Pair, opaque, or framed glass Pair, laminated glass (frameless)	LSP New	yes	X			Magnetic lock or electric strike	yes	
				LSP Existing	no				Push-button combination lock	yes	
Hospital ACC Outpatient Clinic NHCU VBA Research and Vivarium	Utility Connections	111.A 111.C	Exterior to Commercial Power Connections Single, opaque Pair, opaque	LSP New	no				F07 Storeroom	yes	IDS with alarm
				LSP Existing	no				F07 Storeroom	yes	IDS with alarm
Hospital ACC Outpatient Clinic NHCU VBA Research and Vivarium	Utility Connections	111.A 111.C	Exterior to Telecommunications and Data Connections Single, opaque Pair, opaque	LSP New	no				F07 Storeroom	yes	IDS with alarm
				LSP Existing	no				F07 Storeroom	yes	IDS with alarm
Hospital ACC Outpatient Clinic NHCU VBA Research and Vivarium	Utility Connections	113.A 113.C	Exterior to Bulk Medical Gas Storage Single, opaque Pair, opaque	LSP New	no				F07 Storeroom	no	
				LSP Existing	no				F07 Storeroom	no	

\* References for ANSI/BHMA Designations: "F-\_\_" – ANSI/BHMA A156.13; "Exit \_\_" – ANSI/BHMA A156.3

BUILDING INTERIOR

Facility Type	Entry Type	SDO	Locations and Descriptions	Facility Classification	Access Control				Monitoring		Other
					Card Reader	Fail Safe	Fail Secure	Other	ANSI/BHMA* or other function	Door Contact	
Hospital ACC Outpatient Clinic NHCU	General	201.A	Public Lobby to Building Interior Single, opaque, or framed glass	LSP New	no				F04 Entry	no	
		201.B	Single, tempered glass (frameless)								
		201.C	Pair, opaque, or framed glass	LSP Existing	no				F04 Entry	no	
		201.D	Pair, tempered glass (frameless)								
VBA  Where VA is the only tenant	General	201.A	Public Lobby to Building Interior Single, opaque, or framed glass	LSP New	no				F04 Entry	no	
		201.B	Single, tempered glass (frameless)								
		201.C	Pair, opaque, or framed glass	LSP Existing	no				F04 Entry	no	
		201.D	Pair, tempered glass (frameless)								
Research Facilities and Vivariums	General	202.A	Public Lobby to Building Interior Single, opaque, or framed glass	LSP New	yes	X			Magnetic lock or electric strike	yes	
		202.C	Pair, opaque, or framed glass	LSP Existing	yes	X			Magnetic, electric strike, or push-button combination	yes	
Hospital ACC Outpatient Clinic NHCU VBA	Mail Room	203.A	Corridor to Mail Room Single, opaque, or framed glass	LSP New	yes		X		F07 Storeroom and electric strike	yes	
		203.C	Pair, opaque, or framed glass	LSP Existing	no				Push-button combination lock	no	
Hospital ACC Outpatient Clinic NHCU VBA	Security Control Center	204.A	Corridor to SCC Single, opaque, or framed one-way glass	LSP New	yes		X		F07 Storeroom and electric strike	yes	FEBR (30 min./ Level III)
				LSP Existing	no				Push-button combination lock	no	FEBR (30 min./ Level III)
Hospital ACC Outpatient Clinic	Police Operations Unit	205.A	Holding Area Single, opaque, or framed one-way glass	LSP New	yes		X		F07 Storeroom and electric strike	yes	
				LSP Existing	yes		X		F07 Storeroom and electric strike	yes	
Hospital ACC Outpatient Clinic NHCU VBA	Guard Station	206.A	Corridor to Security Guard Station Single, opaque, or framed glass	LSP New	yes				F07 Storeroom and electric strike	yes	
				LSP Existing	no				Push-button combination lock	no	

\* References for ANSI/BHMA Designations: "F-\_\_" – ANSI/BHMA A156.13; "Exit \_\_" – ANSI/BHMA A156.3

BUILDING INTERIOR (continued)

Facility Type	Entry Type	SDO	Locations and Descriptions	Facility Classification	Access Control					Monitoring		Other
					Card Reader	Fail Safe	Fail Secure	Other	ANSI/BHMA* or other function	Door Contact	Other	
Hospital NHCU	Canteen Retail Store	207.A	Corridor to Canteen Retail Store Single, opaque, or framed glass	LSP New	no				F07 Storeroom	yes	IDS with alarm	
		207.B	Single, tempered glass (frameless)									
		207.C	Pair, opaque, or framed glass	LSP Existing	no				F07 Storeroom	yes	IDS with alarm	
		207.D	Pair, tempered glass (frameless)									
Hospital NHCU	Canteen Storage	208.A	Canteen Storage Room Single, opaque	LSP New	no				F07 Storeroom	yes	IDS with alarm	
		208.C	Pair, opaque	LSP Existing	no				F07 Storeroom	yes	IDS with alarm	
Hospital	Agent Cashier	209.A	Corridor to Agent Cashier Single, opaque, or framed glass	LSP New	yes	X			F07 Storeroom and electric strike	yes	IDS with alarm	
				LSP Existing	yes	X			F07 Storeroom and electric strike	yes	IDS with alarm	
Hospital	Credit Union	209.A	Public Areas to Credit Union Single, opaque, or framed glass	LSP New	yes	X			F07 Storeroom and electric strike	yes	IDS with alarm	
				LSP Existing	yes	X			F07 Storeroom and electric strike	yes	IDS with alarm	
Hospital ACC Outpatient Clinic NHCU	Pharmacy Cache	210.A	Corridor to Pharmacy Cache Single, opaque, or framed one-way glass	LSP New	yes	X		PIN or Biometrics	F07 Storeroom and electric strike	yes	IDS with alarm	30 minute forced entry
		210.C	Pair, opaque, or framed one-way glass	LSP Existing	yes	X		PIN or Biometrics	F07 Storeroom and electric strike	yes	IDS with alarm	30 minute forced entry
Hospital ACC Outpatient Clinic	Pharmacy Dispensing	211.A	Corridor to Pharmacy Dispensing Area Single, opaque, or framed one-way glass	LSP New	yes	X			F07 Storeroom and electric strike	yes	IDS with alarm	
				LSP Existing	yes	X			F07 Storeroom and electric strike	yes	IDS with alarm	
Hospital ACC Outpatient Clinic	Pharmacy Manuf'g	211.A	Corridor to Pharmacy Manufacturing Area Single, opaque, or framed one-way glass	LSP New	yes	X		PIN or Biometrics	F07 Storeroom and electric strike	yes	IDS with alarm	30 minute forced entry
				LSP Existing	yes	X		PIN or Biometrics	F07 Storeroom and electric strike	yes	IDS with alarm	30 minute forced entry
Hospital ACC Outpatient Clinic	Narcotics Vault	212.A	Pharmacy Cache to Narcotics Vault Single, opaque, or wire mesh	LSP New	yes	X		PIN or Biometrics	F07 Storeroom and electric strike	yes	Hold-open alarm	
				LSP Existing	yes	X		PIN or Biometrics	F07 Storeroom and electric strike	yes	Hold-open alarm	
Hospital ACC Outpatient Clinic NHCU VBA	Veterans' Records	213.A	Corridor to Veterans' Records Single, opaque, or framed glass	LSP New	yes	X			F07 Storeroom and electric strike	yes	IDS with alarm	15 minute forced entry
		213.C	Pair, opaque, or framed glass	LSP Existing	no				Push-button combination lock	yes	IDS with alarm	15 minute forced entry

\* References for ANSI/BHMA Designations: "F-\_\_" – ANSI/BHMA A156.13; "Exit \_\_" – ANSI/BHMA A156.3

BUILDING INTERIOR (continued)

Facility Type	Entry Type	SDO	Locations and Descriptions	Facility Classification	Access Control				Monitoring		Other
					Card Reader	Fail Safe	Fail Secure	Other	ANSI/BHMA* or other function	Door Contact	
Hospital ACC Outpatient Clinic NHCU	Medical Supplies	214.A	Corridor to Medical Supply Storage Single, opaque	LSP New	no				Push-button combination lock	no	
		214.C	Pair, opaque	LSP Existing	no				Push-button combination lock	no	
Hospital ACC Outpatient Clinic NHCU	Linen Storage and Distrib.	215.A	Corridor to Central Linen Storage and Distribution Single, opaque	LSP New	no				Push-button combination lock	yes	IDS with alarm
		215.C	Pair, opaque	LSP Existing	no				Push-button combination lock	yes	IDS with alarm
Hospital ACC Outpatient Clinic NHCU VBA Research Facilities	Information Resource Mgmt.	216.A	Corridor to Information Resource Management (IRM) Single, opaque or framed glass	LSP New	yes	X		PIN or Biometrics	F07 Storeroom and electric strike	yes	IDS with alarm
		216.C	Pair, opaque or framed glass	LSP Existing	yes	X		PIN or Biometrics	F07 Storeroom and electric strike	yes	IDS with alarm
Hospital ACC Outpatient Clinic NHCU VBA Research Facilities	Communications	217.A	Corridor to Telephone Equipment Room Single, opaque or framed glass	LSP New	yes	X		PIN or Biometrics	F07 Storeroom and electric strike	yes	IDS with alarm
		217.C	Pair, opaque or framed glass	LSP Existing	yes	X		PIN or Biometrics	F07 Storeroom and electric strike	yes	IDS with alarm
Hospital ACC Outpatient Clinic NHCU VBA Research Facilities	Telephone and Data Closets	218.A	Corridor to Telephone and Data Closets Single, opaque	LSP New	no				F07 Storeroom	no	
		218.C	Pair, opaque	LSP Existing	no				F07 Storeroom	no	
Hospital ACC Outpatient Clinic NHCU VBA Research Facilities	Electrical Closets	218.A	Corridor to Electrical Closets Single, opaque	LSP New	no				F07 Storeroom	no	
		218.C	Pair, opaque	LSP Existing	no				F07 Storeroom	no	

\* References for ANSI/BHMA Designations: "F-\_\_" – ANSI/BHMA A156.13; "Exit \_\_" – ANSI/BHMA A156.3



BUILDING INTERIOR (continued)

Facility Type	Entry Type	SDO	Locations and Descriptions	Facility Classification	Access Control				Monitoring		Other	
					Card Reader	Fail Safe	Fail Secure	Other	ANSI/BHMA* or other function	Door Contact		Other
Hospital ACC Outpatient Clinic NHCU Research Facilities	Medical Media Equipment Storage	219.A 219.C	Corridor to Medical Media Equipment Storage Single, opaque or framed glass Pair, opaque or framed glass	LSP New	yes				F07 Storeroom and electric strike	yes	IDS with alarm	
				LSP Existing	yes				F07 Storeroom and electric strike	yes	IDS with alarm	
Hospital ACC Outpatient Clinic	Evidence Storage	220.A	Corridor to Evidence Storage Single, opaque	LSP New	yes		X		F07 Storeroom and electric strike	yes	IDS with alarm	FEBR (15 min./ Level III)
				LSP Existing	yes		X		F07 Storeroom and electric strike	yes	IDS with alarm	FEBR (15 min./ Level III)
Hospital ACC Outpatient Clinic	Weapon Storage/ Armory	221.A	Security Control Center to Weapon Storage/Armory Single, opaque	LSP New	yes		X	PIN or Biometrics	F07 Storeroom, electric strike, and magnetic lock	yes	IDS with alarm	FEBR (15 min./ Level III)
				LSP Existing	yes		X	PIN or Biometrics	F07 Storeroom, electric strike, and magnetic lock	yes	IDS with alarm	FEBR (15 min./ Level III)
Hospital Research Facilities	Animal Research Facility	222.A 222.C	Public Area to Animal Research Facility or Vivarium Single, opaque or framed glass Pair, opaque or framed glass	LSP New	yes	X		PIN or Biometrics	F07 Storeroom and electric strike, or magnetic lock	yes	IDS with alarm	
				LSP Existing	yes	X		PIN or Biometrics	F07 Storeroom and electric strike, or magnetic lock	yes	IDS with alarm	
Hospital Research Facilities	Research and Clinical Labs	222.A 222.C	Public Areas to Research and Clinical Laboratories Single, opaque or framed glass Pair, opaque or framed glass	LSP New	yes	X		PIN or Biometrics	F07 Storeroom and electric strike, or magnetic lock	yes	IDS with alarm	
				LSP Existing	yes	X		PIN or Biometrics	F07 Storeroom and electric strike, or magnetic lock	yes	IDS with alarm	
Hospital ACC Outpatient Clinic NHCU Research Facilities	Radio- active Materials Storage	223.A 223.C	Corridor to Areas Containing Radioactive Materials Single, opaque Pair, opaque	LSP New	yes	X		PIN or Biometrics	F07 Storeroom and electric strike	yes	IDS with alarm	
				LSP Existing	yes	X		PIN or Biometrics	F07 Storeroom and electric strike	yes	IDS with alarm	
Hospital ACC Outpatient Clinic NHCU VBA Research Facilities	Fire Control Center	224.A	Fire Control Center to Building Interior Single, opaque	LSP New	no				F07 Storeroom	yes	IDS with alarm	
				LSP Existing	no				F07 Storeroom	yes	IDS with alarm	

\* References for ANSI/BHMA Designations: "F-\_\_" – ANSI/BHMA ; "Exit \_\_" – ANSI/BHMA A156.3



BUILDING INTERIOR (continued)

Facility Type	Entry Type	SDO	Locations and Descriptions	Facility Classification	Access Control				Monitoring		Other
					Card Reader	Fail Safe	Fail Secure	Other	ANSI/BHMA* or other function	Door Contact	
Hospital Research Facilities	Restricted Access Floors	225.0	Elevator to Restricted or Controlled Floor Opaque elevator cab and entrance doors	LSP New	yes		X		Elevator Door Control	yes	
				LSP Existing	yes		X		Elevator Door Control	yes	
Hospital Research Facilities	Restricted Access Floors	226.A	Stair to Restricted or Controlled Area Single, opaque	LSP New	yes	X			Electric Strike and Exit 13	yes	
				LSP Existing	yes	X			Electric Strike and Exit 13	yes	
Hospital Research Facilities	Restricted Access Floors	227.A 227.C	Corridor to Restricted or Controlled Area Single, opaque Pair, opaque	LSP New	yes	X			F07 Storeroom and electric strike	yes	
				LSP Existing	yes	X			F07 Storeroom and electric strike	yes	
Hospital ACC Outpatient Clinic NHCU VBA Research Facilities	Elevator Equipment Room	228.A 228.C	Corridor to Elevator Equipment Room Single, opaque Pair, opaque	LSP New	yes		X		F07 Storeroom and electric strike	yes	
				LSP Existing	no				Push-button combination lock	yes	IDS with alarm
Hospital ACC Outpatient Clinic NHCU VBA Research Facilities	Building Systems	228.A 228.C	Corridor to Building Systems Rooms Single, opaque Pair, opaque	LSP New	yes		X		F07 Storeroom and electric strike	yes	
				LSP Existing	no				Push-button combination lock	no	
Hospital ACC Outpatient Clinic NHCU VBA Research Facilities	Mech. and Electrical	228.A 228.C	Corridor to Mechanical and Electrical Rooms Single, opaque Pair, opaque	LSP New	yes		X		F07 Storeroom and electric strike	yes	
				LSP Existing	no				Push-button combination lock	no	
Hospital Research Facilities	Select Agents	229.A 229.C	Rooms with Select Agents Single, opaque or framed glass Pair, opaque or framed glass	LSP New	yes		X		F07 Storeroom and electric strike	yes	
				LSP Existing	yes		X		F07 Storeroom and electric strike	yes	
Hospital Research Facilities	BSL Labs	230.A 230.C	Public Areas to BSL-3 Laboratory Suites Single, opaque or framed glass Pair, opaque or framed glass	LSP New	yes	X		PIN or Biometrics	Magnetic Lock or electric strike	yes	
				LSP Existing	yes	X		PIN or Biometrics	Magnetic Lock or electric strike	yes	

\* References for ANSI/BHMA Designations: "F-\_\_" – ANSI/BHMA A156.13; "Exit \_\_" – ANSI/BHMA A156.3

BUILDING INTERIOR (continued)

Facility Type	Entry Type	SDO	Locations and Descriptions	Facility Classification	Access Control					Monitoring		Other
					Card Reader	Fail Safe	Fail Secure	Other	ANSI/BHMA* or other function	Door Contact	Other	
Research Facilities	Vivariums	222.A 222.C	Public Area to Vivarium Single, opaque or framed glass Pair, opaque or framed glass	LSP New	yes	X		PIN or Biometrics	Magnetic Lock or electric strike	yes		
				LSP Existing	yes	X		PIN or Biometrics	Magnetic Lock or electric strike	yes		
Research Facilities	Vivariums	222.A 222.C	Vivarium Exit Single, opaque or framed glass Pair, opaque or framed glass	LSP New	yes	X			EXIT 01	yes		
				LSP Existing	yes	X			EXIT 01	yes		
Hospital NHCU	Psychiatric Units	231.A	Public Areas to Psychiatric Unit Single, framed glass	LSP New	yes	X			F01 Passage and magnetic lock	yes		Monitor at NS
				LSP Existing	yes	X			F01 Passage and magnetic lock	yes		Monitor at NS
Hospital NHCU	Psychiatric Units	232.A	Psychiatric Unit Exit Only Single, framed glass	LSP New	no				F01 Passage and magnetic lock	yes		Monitor at NS
				LSP Existing	no				F01 Passage and magnetic lock	yes		Monitor at NS
Hospital	COOP	233.A 233.C	Public Areas to COOP Single, opaque Pair, opaque	LSP New	yes		X		F07 Storeroom, electric strike, and magnetic lock	yes	PIN or Biometrics	
				LSP Existing	yes		X		F07 Storeroom, electric strike, and magnetic lock	yes	PIN or Biometrics	

\* References for ANSI/BHMA Designations: "F-\_\_" – ANSI/BHMA A156.13; "Exit \_\_" – ANSI/BHMA A156.3



### VA Standard Security Door Types A and C

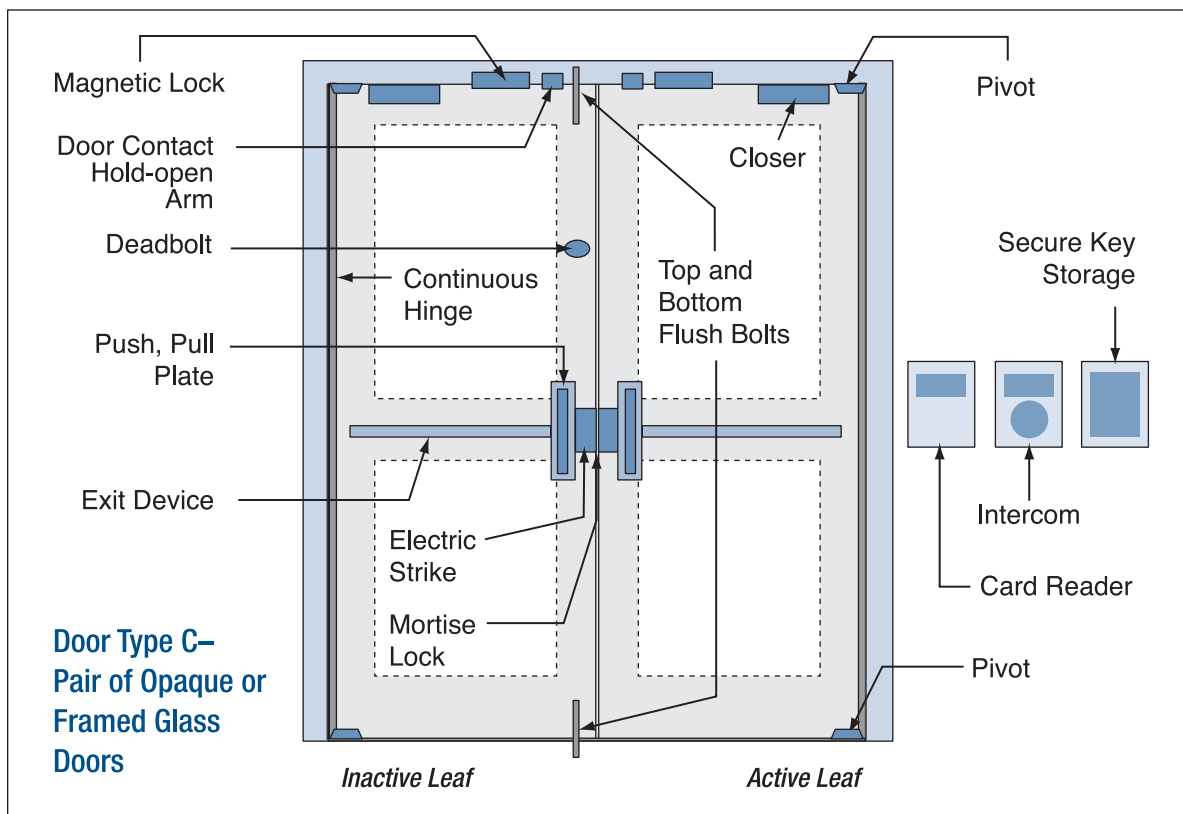
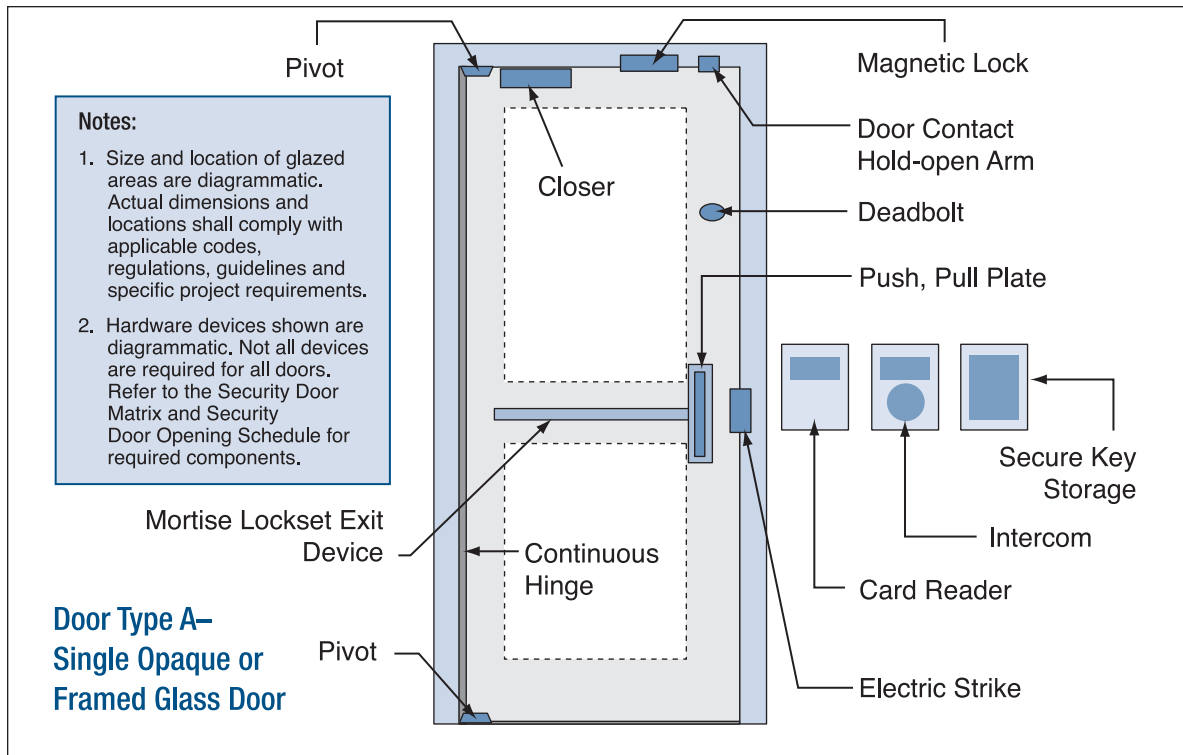

### VA Standard Security Door Types B and D

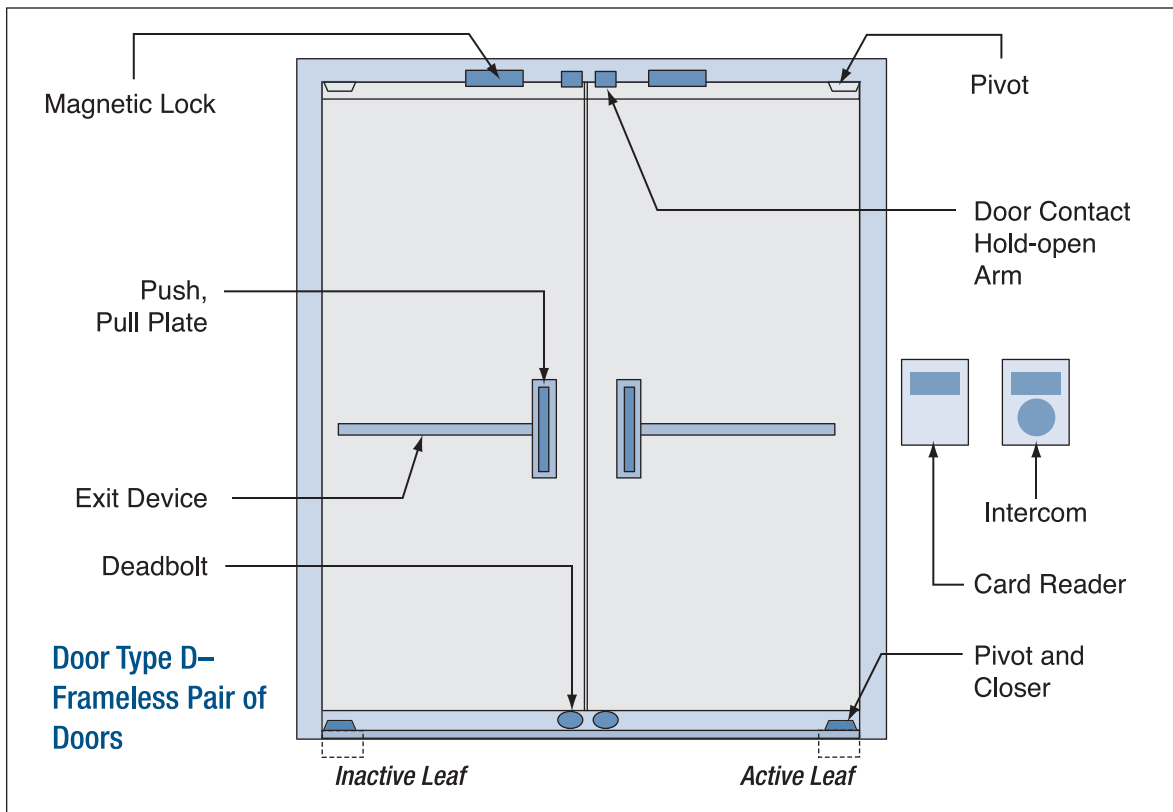
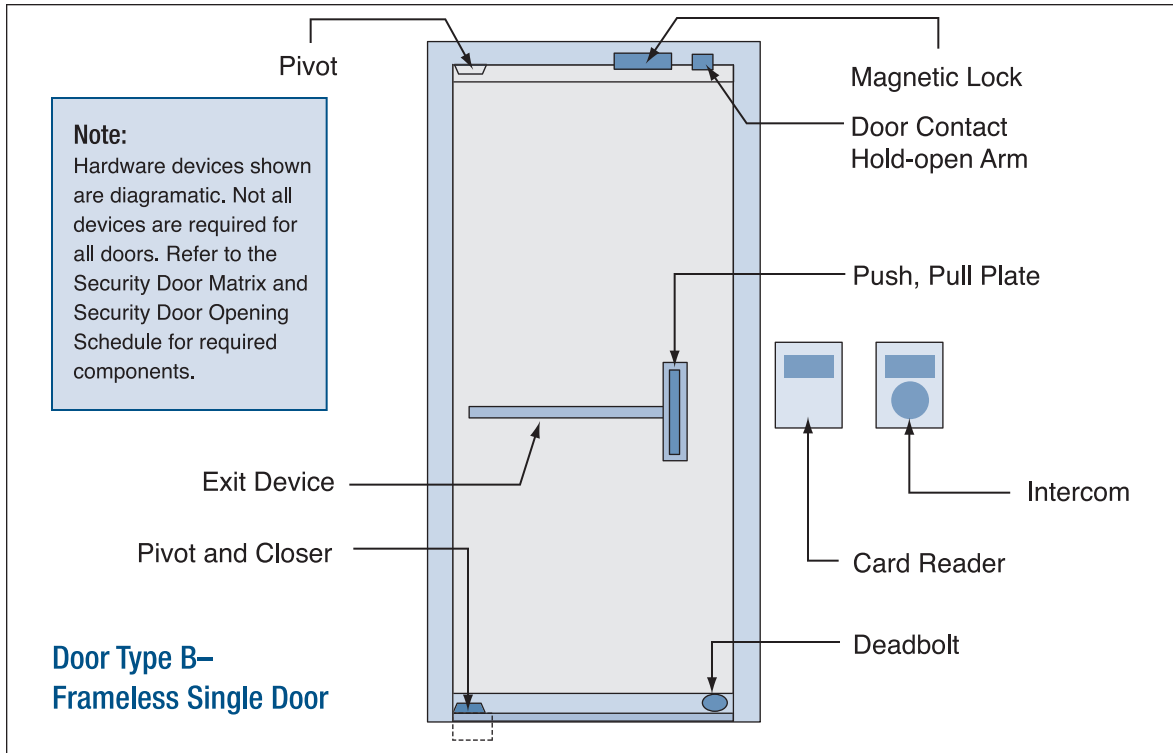

## Security Door Opening General Notes and Schedule

1. The hardware devices identified below indicate those generally required to meet the operational and security requirements. They are not all inclusive. Certain devices may not be applicable to every opening. For example, flush bolts are not required for single doors and neither continuous hinges nor electric strikes would be used on frameless doors.
2. When optional operational features are provided, refer to Security Door Openings Matrix for requirements by facility classification.
3. Items required for functional purposes that are not related to door operation are not included in the descriptions below. For example, an intercom may be required at a guard booth so that a visitor can communicate with the guard, but it is not required for door operation.

---

## SDO 101

### Hardware Devices:

- Card Reader
- Closer
- Continuous Hinge or Pivots
- Door Contact
- Electric Strike
- Exit Device
- Flush Bolts
- Intercom
- Magnetic Lock
- Mortise Lock

### Normal Daytime Operation

- Free operation from either side

### After Hours Operation

- Exterior lever inoperative
- Card reader on exterior releases electric strike or magnetic lock
- Remote release releases electric strike or magnetic lock
- Free operation from interior
- Door contact alarmed to central monitoring

---

### SDO 102

#### Hardware Devices

- Card Reader
- Closer
- Continuous Hinge
- Door Contact
- Electric Strike
- Exit Device
- Flush Bolts
- Hold-open Alarm
- Intercom
- Magnetic Lock
- Mortise Lock

#### Operation At All Times

- Outside lever always rigid
- Card reader releases electric strike
- Free operation from interior at all times

---

### SDO 103

#### Hardware Devices

- Card Reader
- Closer
- Continuous Hinge or Pivots
- Deadbolt
- Door Contact
- Electric Strike
- Exit Device
- Flush Bolts
- Hold-open Alarm
- Magnetic Lock
- Mortise Lock
- Pull

#### Normal Daytime Operation

- Free operation from either side

#### After Hours Operation

- Exterior lever inoperative
- Card reader on exterior releases electric strike or magnetic lock
- Delayed action and alarmed operation from interior when door is a means of egress; card reader for egress when door is not a required means of egress
- Door contact alarmed to central monitoring



---

## SDO 104

### Hardware Devices

- Closer
- Continuous Hinge or Pivots
- Door Contact
- Exit Device
- Flush Bolts
- Hold-open Alarm
- Mortise Lock

### Operation At All Times

- Operation of exit device from inside retracts bolt and sounds local alarm and central monitoring station
- No operation from exterior

---

## SDO 105

### Hardware Devices

- Power Operator
- Card Reader
- Continuous Hinge
- Intercom
- Magnetic Lock

### Normal Daytime Operation

- Power operated doors (swinging or horizontal sliding)
- Door activated by motion sensor on interior and exterior

### After Hours Operation

- Power operated doors (swinging or horizontal sliding)
- Door activated from exterior by card reader or remote release
- Door activated by motion sensor on interior

---

### SDO 106

#### Hardware Devices

- Card Reader
- Closer
- Continuous Hinge or Pivots
- Door Contact
- Electric Strike
- Exit Device
- Flush Bolts
- Intercom
- Magnetic Lock
- Mortise Lock

#### Normal Daytime Operation

- Free operation at all times

#### After Hours Operation

- Exterior lever inoperative
- Card reader on exterior releases electric strike or magnetic lock
- Remote release releases electric strike or magnetic lock
- Free operation from interior
- Door contact alarmed to nurses' station

---

### SDO 107

#### Hardware Devices

- Card Reader
- Closer
- Continuous Hinge
- Door Contact
- Electric Strike
- Flush Bolts
- Hold-open Alarm
- Mortise Lock

#### Operation At All Times

- Outside levers always rigid
- Card reader releases electric strike or key in outside lever retracts latchbolt
- Inside lever retracts latchbolt at all times
- Hold-open alarm annunciates at central monitoring station

---

## SDO 108

### Hardware Devices

- Card Reader
- Door Contact
- Intercom

### Operation At All Times

- Card reader activates motorized door operator or provides access to manual operator

---

## SDO 109

### Hardware Devices

- Continuous Hinge
- Door Contact
- Flush Bolts

### Operation At All Times

- Outside lever always rigid
- Inside lever retracts latchbolt at all times
- Door contact alarmed to central monitoring station

---

## SDO 110

### Hardware Devices

- Closer
- Continuous Hinge
- Knox Box<sup>®</sup>
- Mortise Lock

### Operation At All Times

- Outside lever always rigid
- Key in Knox Box<sup>®</sup> retracts latchbolt from exterior
- Inside lever retracts latchbolt at all times

---

### SDO 111

#### Hardware Devices

- Closer
- Continuous Hinge
- Door Contact
- Flush Bolts
- Mortise Lock

#### Operation At All Times

- Outside lever always rigid
- Key retracts latchbolt from exterior
- Inside lever retracts latchbolt at all times
- Door monitor alarmed at central monitoring station

---

### SDO 112

#### Hardware Devices

- Card Reader
- Closer
- Continuous Hinge or Pivots
- Door Contact
- Electric Strike
- Exit Device
- Flush Bolts
- Hold-open Alarm
- Intercom
- Magnetic Lock
- Mortise Lock

#### Normal Daytime Operation

- Outside lever always rigid
- Card reader or remote switch release electric strike or magnetic lock
- Inside lever releases latchbolt; card reader, remote switch or fire alarm release magnetic lock
- Door alarmed to central monitoring station

---

## SDO 113

### Hardware Devices

- Closer
- Continuous Hinge
- Flush Bolts
- Mortise Lock

### Operation At All Times

- Outside lever always rigid
- Key retracts latchbolt from exterior
- Inside lever retracts latchbolt at all times

---

## SDO 114

### Hardware Devices

- Closer
- Continuous Hinge
- Mortise Lock

### Operation At All Times

- Outside lever rigid when locked by mechanical device
- Outside lever free when unlocked by mechanical device
- Inside lever retracts latchbolt at all times

---

## SDO 201

### Hardware Devices

- Closer
- Continuous Hinge or Pivots
- Exit Device
- Flush Bolts
- Mortise Lock

### Normal Daytime Operation

- Outside (lobby side) lever set for free operation
- Free passage from interior

### After Hours Operation

- Outside (lobby side) lever rigid
- Free passage from interior

---

## SDO 202

### Hardware Devices

- Card Reader
- Closer
- Continuous Hinge
- Door Contact
- Electric Strike
- Exit Device
- Flush Bolts
- Hold-open Alarm
- Intercom
- Magnetic Lock
- Mortise Lock

### Operation At All Times

- Outside lever always rigid
- Card reader or remote switch release electric strike or magnetic lock
- Card reader and fire alarm release magnetic lock from interior
- Inside lever retracts latchbolt at all times

---

## SDO 203

### Hardware Devices

- Card Reader
- Closer
- Continuous Hinge
- Door Contact
- Electric Strike
- Flush Bolts
- Hold-open Alarm
- Mortise Lock

### Operation At All Times

- Outside lever always rigid
- Outside card reader releases electric strike or outside combination lock retracts latchbolt
- Inside lever retracts latchbolt at all times
- Door alarmed to central monitoring station

---

## SDO 204

### Hardware Devices

- Card Reader
- Closer
- Continuous Hinge
- Door Contact
- Electric Strike
- Mortise Lock

### Operation At All Times

- Outside lever always rigid
- Outside card reader releases electric strike or outside combination lock retracts latchbolt
- Inside lever retracts latchbolt at all times
- Door alarmed to central monitoring station

---

## SDO 205

### Hardware Devices

- Card Reader
- Closer
- Continuous Hinge
- Deadbolt
- Door Contact
- Electric Strike
- Mortise Lock

### Operation At All Times

- Outside and inside levers always rigid
- Card reader releases electric strike
- Door monitor alarmed to central monitoring station

---

## SDO 206

### Hardware Devices

- Card Reader
- Closer
- Continuous Hinge
- Door Contact
- Electric Strike
- Mortise Lock

### Operation At All Times

- Outside lever always rigid
- Outside card reader releases electric strike or outside combination lock retracts latchbolt
- Inside lever retracts latchbolt at all times
- Door monitor alarmed to central monitoring station



---

### SDO 207

#### Hardware Devices

- Closer
- Continuous Hinge or Pivots
- Door Contact
- Exit Device
- Flush Bolts
- Mortise Lock

#### Normal Daytime Operation

- Free operation from either side

#### After Hours Operation

- Outside lever always rigid
- Exit device releases latchbolts from interior
- Door monitor alarmed to central monitoring station

---

### SDO 208

#### Hardware Devices

- Closer
- Continuous Hinge
- Door Contact
- Flush Bolts
- Mortise Lock

#### Operation At All Times

- Outside lever always rigid
- Inside lever retracts latchbolt at all times
- Door monitor alarmed to central monitoring station

---

### SDO 209

#### Hardware Devices

- Card Reader
- Closer
- Continuous Hinge
- Door Contact
- Electric Strike
- Mortise Lock

#### Normal Daytime Operation

- Outside lever always rigid
- Card reader releases electric strike
- Inside lever retracts latchbolt

## After Hours Operation

- Outside lever always rigid
- Card reader releases electric strike from outside
- Inside lever retracts latchbolt
- Door monitor alarmed to central monitoring station

---

## SDO 210

### Hardware Devices

- Card Reader
- Closer
- Continuous Hinge
- Door Contact
- Electric Strike
- Flush Bolts
- Hold-open Alarm
- Intercom
- Mortise Lock

### Operation At All Times

- Outside and inside levers rigid at all times
- Card reader with biometric or PIN identification retracts electric strike from either side
- Door monitor alarmed to central monitoring station

---

## SDO 211

### Hardware Devices

- Card Reader
- Closer
- Continuous Hinge
- Door Contact
- Electric Strike
- Hold-open Alarm
- Intercom
- Mortise Lock

### Operation At All Times

- Outside and inside levers rigid at all times
- Card reader with biometric or PIN identification retracts electric strike from either side
- Door monitor alarmed to central monitoring station

---

### SDO 212

#### Hardware Devices

- Card Reader
- Closer
- Continuous Hinge
- Door Contact
- Electric Strike
- Hold-open Alarm
- Mortise Lock

#### Operation At All Times

- Outside and inside levers rigid at all times
- Card reader or remote release retracts electric strike from either side
- Door monitor alarmed to pharmacy and central monitoring station

---

### SDO 213

#### Hardware Devices

- Card Reader
- Closer
- Continuous Hinge
- Door Contact
- Electric Strike
- Flush Bolts
- Intercom
- Mortise Lock

#### Operation At All Times

- Outside lever always rigid
- Card reader or remote switch releases electric strike
- Inside lever retracts latchbolt at all times
- Door monitor alarmed to central monitoring station

---

### SDO 214

#### Hardware Devices

- Closer
- Continuous Hinge
- Flush Bolts
- Mortise Lock

#### Operation At All Times

- Outside lever always rigid
- Latchbolt released from outside by combination lock
- Inside lever retracts latchbolt at all times

---

## SDO 215

### Hardware Devices

- Closer
- Continuous Hinge
- Door Contact
- Flush Bolts
- Mortise Lock

### Operation At All Times

- Outside lever always rigid
- Latchbolt released from outside by combination lock
- Inside lever retracts latchbolt at all times

---

## SDO 216

### Hardware Devices

- Card Reader
- Closer
- Continuous Hinge
- Door Contact
- Electric Strike
- Flush Bolts
- Intercom
- Mortise Lock

### Operation At All Times

- Outside lever always rigid
- Card reader with biometric or PIN identification retracts electric strike
- Inside lever retracts latchbolt at all times
- Door monitor alarmed to central monitoring station

---

## SDO 217

### Hardware Devices

- Card Reader
- Closer
- Continuous Hinge
- Door Contact
- Electric Strike
- Flush Bolts
- Mortise Lock

### Operation At All Times

- Outside lever always rigid
- Card reader with biometric or PIN identification retracts electric strike
- Inside lever retracts latchbolt at all times
- Door monitor alarmed to central monitoring station

---

## SDO 218

### Hardware Devices

- Continuous Hinge
- Flush Bolts
- Mortise Lock

### Operation At All Times

- Outside lever always rigid
- Latchbolt released by key outside and lever inside

---

## SDO 219

### Hardware Devices

- |                    |                   |
|--------------------|-------------------|
| ■ Card Reader      | ■ Electric Strike |
| ■ Closer           | ■ Flush Bolts     |
| ■ Continuous Hinge | ■ Mortise Lock    |
| ■ Door Contact     |                   |

### Operation At All Times

- Outside lever rigid at all times
- Card reader releases electric strike from outside
- Inside lever retracts latchbolt at all times
- Door monitor alarmed to central monitoring station

---

## SDO 220

### Hardware Devices

- Card Reader
- Closer
- Continuous Hinge
- Door Contact
- Electric Strike
- Mortise Lock

### Operation At All Times

- Outside lever rigid at all times
- Card reader releases electric strike from outside
- Inside lever rigid at all times
- Card reader releases electric strike from inside
- Door monitor alarmed to central monitoring station

---

## SDO 221

### Hardware Devices

- Card Reader
- Closer
- Continuous Hinge
- Deadbolt
- Door Contact
- Electric Strike
- Magnetic Lock
- Mortise Lock

### Operation At All Times

- Outside lever rigid at all times
- Card reader with biometric or PIN identification releases electric strike and magnetic lock from outside
- Inside lever rigid at all times
- Card reader with biometric or PIN identification releases electric strike and magnetic lock from inside
- Door monitor alarmed to central monitoring station

---

### SDO 222

#### Hardware Devices

- Card Reader
- Closer
- Continuous Hinge
- Door Contact
- Electric Strike
- Flush Bolts
- Intercom
- Magnetic Lock
- Mortise Lock

#### Operation At All Times

- Outside lever always rigid
- Card reader with biometric or PIN identification releases electric strike or magnetic lock
- Inside lever retracts latchbolt at all times or request to exit button releases magnetic lock
- Door monitor alarmed to central monitoring station

---

### SDO 223

#### Hardware Devices

- Card Reader
- Closer
- Continuous Hinge
- Door Contact
- Electric Strike
- Flush Bolts
- Mortise Lock

#### Operation At All Times

- Outside and inside levers rigid at all times
- Card reader with biometric or PIN identification releases electric strike on either side
- Door monitor alarmed to central monitoring station

---

### SDO 224

#### Hardware Devices

- Closer
- Continuous Hinge
- Mortise Lock



## Operation At All Times

- Outside lever always rigid
- Key in outside lever retracts latchbolt
- Inside lever retracts latchbolt at all times
- Door monitor alarmed to central monitoring station

---

## SDO 225

### Hardware Devices

- Card Reader
- Door Contact

### Operation At All Times

- Card reader permits elevator door to open on restricted access floors
- Door monitor alarmed to central monitoring station

---

## SDO 226

### Hardware Devices

- Card Reader
- Closer
- Continuous Hinge
- Door Contact
- Electric Strike
- Exit Device

### Operation At All Times

- Outside lever (stair side) always rigid
- Card reader releases electric strike
- Delayed action and alarmed operation from inside (occupied side) when door is a means of egress; card reader for egress when door is not a required means of egress
- Door monitor alarmed to central monitoring station

---

### SDO 227

#### Hardware Devices

- Card Reader
- Closer
- Continuous Hinge
- Door Contact
- Electric Strike
- Exit Device
- Flush Bolts
- Intercom
- Mortise Lock

#### Operation At All Times

- Outside lever always rigid
- Card reader or remote switch releases electric strike
- Inside lever retracts latchbolt at all times
- Door monitor alarmed to central monitoring station

---

### SDO 228

#### Hardware Devices

- Card Reader
- Closer
- Continuous Hinge
- Door Contact
- Electric Strike
- Flush Bolts
- Mortise Lock

#### Operation At All Times

- Outside lever always rigid
- Card reader releases electric strike or combination lock retracts latchbolt
- Inside lever retracts latchbolt at all times
- Door monitor alarmed to central monitoring station

---

## SDO 229

### Hardware Devices

- Card Reader
- Closer
- Continuous Hinge
- Door Contact
- Electric Strike
- Flush Bolts
- Intercom
- Mortise Lock

### Operation At All Times

- Outside lever always rigid
- Card reader or remote switch releases electric strike from outside
- Inside lever always rigid
- Card reader releases electric strike from inside
- Door monitor alarmed to central monitoring station

---

## SDO 230

### Hardware Devices

- Card Reader
- Closer
- Continuous Hinge
- Door Contact
- Electric Strike
- Flush Bolts
- Intercom
- Magnetic Lock
- Mortise Lock

### Operation At All Times

- Outside lever always rigid
- Card reader or remote switch releases electric strike or magnetic lock from outside
- Inside lever always rigid
- Card reader or fire alarm releases electric strike or magnetic lock from inside
- Door monitor alarmed to central monitoring station

---

### SDO 231

#### Hardware Devices

- Card Reader
- Closer
- Continuous Hinge
- Door Contact
- Hold-open Alarm
- Intercom
- Magnetic Lock
- Mortise Lock

#### Operation At All Times

- Outside and inside levers always free (passage function for latching requirements only)
- Card reader or remote switch at nurses' station releases magnetic lock
- Fire alarm releases magnetic lock
- Door monitor alarmed at nurses' station

---

### SDO 232

#### Hardware Devices

- Closer
- Continuous Hinge
- Door Contact
- Exit Device
- Magnetic Lock

#### Operation At All Times

- No hardware on outside
- Magnetic lock released by remote switch at nurses' station or by fire alarm
- Door monitor alarmed at nurses' station

---

### SDO 233

#### Hardware Devices

- Card Reader
- Closer
- Continuous Hinge
- Door Contact
- Electric Strike
- Flush Bolts
- Intercom
- Magnetic Lock
- Mortise Lock

## Operation At All Times

- Outside lever rigid at all times
- Card reader with biometric or PIN identification or remote switch release electric strike and magnetic lock from outside
- Card reader, remote release, or request to exit button release electric strike and magnetic lock from inside
- Door monitor alarmed to COOP and central monitoring station

---

## SDO 234

### Hardware Devices

- Card Reader
- Closer
- Continuous Hinge
- Door Contact
- Electric Strike
- Flush Bolts
- Mortise Lock

### Operation At All Times

- Outside lever rigid at all times
- Card reader on outside releases electric strike or combination lock on outside retracts latchbolt
- Inside lever retracts latchbolt at all times
- Door monitor alarmed at central monitoring station

# Security System Application Matrix

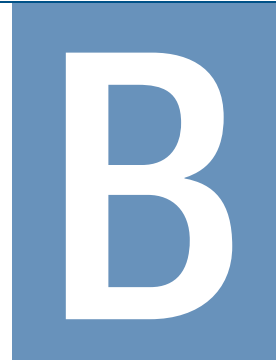



BUILDING EXTERIOR

Area of Coverage	Fixed Camera	Pan/Tilt/Zoom <sup>1</sup>	Controller	Monitor <sup>2</sup>	Recording Device	Matrix Switcher	Motion Det.	Glass Break	Door Contact <sup>3</sup>	Card Reader	Biometrics <sup>4</sup>	Intercom	Duress/Panic Alarm	Emer. Phone/Call Box	Optional <sup>5</sup>				
															X-Ray Mach.	WTMD	HHMD	Itemizer	
															DSS				
CCTV							IDS			PACS		DSPI			DSS				
Access Roadways / Vehicle Gates	X	X								X		X							
Air Intake Areas	X						X		X										
ATM Areas	X																		
Cemetery																			
Administration Building							X	X	X				X						
Storage and Supply Buildings							X	X	X										
Common Ground / Pathways / Sidewalks	X	X												X					
Credit Union	X						X	X	X				X						
Child Care Center	X	X	X	X	X	X	X	X	X	X		X	X	X					
Drop Off / Pick Up Points	X													X					
Elevator Machinery Room	X						X		X	X		X							
Emergency Exit / Perimeter Doors	X	X					X		X										
Emergency Room / Facility Entrance	X	X					X	X	X	X		X							
Employee Entrance / Secondary Doors	X	X					X		X	X		X							
Exterior Windows (AC Unit Inserts)		X					X	X											
Exterior Windows (Ground Accessible)		X					X	X											
Hazardous Material Storage / Enclosures																			
Bio Hazard Waste	X	X					X	X	X	X									
Fuel	X	X					X	X	X										
Liquid Oxygen	X	X					X	X	X										
Medical Gas	X	X					X	X	X	X									
Propane	X	X					X	X	X										
Radioactive Materials Storage	X	X					X	X	X	X			X						
Select Agents Area	X	X					X	X	X	X			X						
Laundry Plant	X	X					X	X	X	X		X	X						
Loading Docks	X			X					X	X		X							
Main Entrance	X	X						X	X			X							
Maintenance Shop	X	X					X	X	X				X						
Nursing Home	X	X	X	X	X	X	X	X	X	X		X	X	X					
Parking Garages	X	X								X		X		X					
Parking Garages (Underground)	X	X								X		X		X					
Parking Lot Areas (Employees)	X	X								X		X		X					
Parking Lot Areas (Open / Visitor / Vendor)	X	X												X					
Pedestrian Access Point	X	X							X										



BUILDING EXTERIOR (continued)

Area of Coverage	Fixed Camera	Pan/Tilt/Zoom <sup>1</sup>	Controller	Monitor <sup>2</sup>	Recording Device	Matrix Switcher	Motion Det.	Glass Break	Door Contact <sup>3</sup>	Card Reader	Biometrics <sup>4</sup>	Intercom	Duress/Panic Alarm	Emer. Phone/Call Box	Optional <sup>5</sup>			
															X-Ray Mach.	WTMD	HHMD	Itemizer
															CCTV			
Perimeter Fence / Wall / Barrier	X	X					X											
Rooftop Access	X	X					X		X	X		X						
Security Guard House / Vehicle Screening Area	X	X		X			X	X				X	X					
Service Entrance	X	X							X	X		X						
Service Vehicle Roadway Gates	X	X								X		X						
Service Yard	X	X												X				
Shipping / Receiving Area	X	X					X	X	X	X		X			X			X
Loading Dock Bay Areas	X	X					X	X	X	X		X	X		X			X
Mailroom	X	X					X	X	X	X		X	X		X			X
UPS Battery / Generator Area	X	X					X	X	X	X								
Utility Buildings																		
Electrical	X	X					X	X	X	X								
Energy Center	X	X					X	X	X	X		X	X					
Mechanical	X	X					X	X	X	X								
Signal	X	X					X	X	X	X								
Telecommunications	X	X					X	X	X	X								
Water Storage / Processing	X	X					X	X	X	X								
Utility Service Tunnel Entrance / Exit	X	X					X		X	X		X		X				
VA Benefits / Regional Office Building	X	X		X			X	X	X	X		X	X		X	X	X	X
Vehicle Entrances / Site Access (Open Access)	X	X												X				
Warehouse Building	X	X		X			X	X	X	X		X	X		X	X	X	X

Footnotes:

1. P/T/Z cameras shall be deployed primarily to monitor site and building exterior areas. They will supplement the use of fixed cameras if they can be programmed to monitor multiple areas with minimal human interface required.
2. A dedicated CCTV camera monitor may be required to provide staff with the ability to monitor access to these controlled areas.
3. Door contacts shall be installed as a back-up to the use of security motion detection devices.
4. Biometric security devices shall only be used as a secondary means of providing access control. Card readers will be the primary security access device used.
5. The use of DSS equipment is indicated as an optional means to screen persons, items, and materials carried into or delivered to a facility. Each facility shall be addressed on a case-by-case basis as to DSS equipment requirements.

BUILDING INTERIOR

Area of Coverage	Fixed Camera	Pan/Tilt/Zoom <sup>1</sup>	Controller	Monitor <sup>2</sup>	Recording Device	Matrix Switcher	Motion Det.	Glass Break	Door Contact <sup>3</sup>	Card Reader	Biometrics <sup>4</sup>	Intercom	Duress/Panic Alarm	Emer. Phone/Call Box	Optional <sup>5</sup>			
															X-Ray Mach.	WTMD	HHMD	Itemizer
															CCTV			
Agent Cashier	X						X	X	X	X		X	X					
Animal Research / Vivarium	X		X	X		X	X	X	X	X	X	X	X					
ATM	X						X	X	X	X								
BSL Labs	X		X	X	X	X	X	X	X	X	X	X	X					
Building Corridors (Restricted / Controlled)	X	X					X	X		X		X						
Building Lobby / Reception Area	X	X						X							X	X	X	X
Cafeteria	X						X	X	X	X			X					
Canteen Office							X	X	X				X					
Canteen Retail Store	X						X	X	X				X					
Canteen Storage	X						X	X	X									
Child Care Center	X	X	X	X	X	X	X	X	X	X		X	X	X				
COOP Room / Facility	X	X	X	X	X	X	X	X	X	X	X	X						
Credit Union	X						X	X	X				X					
Domiciliary	X	X		X			X	X	X	X		X	X	X				
Elevator Equipment Room	X						X		X	X			X					
Elevator Lobby / Floor Access Areas	X						X	X		X		X						
Emergency Exit / Egress Doors	X	X					X		X									
Emergency (Urgent Care) Area										X		X			X	X	X	X
Nursing Station	X							X					X					
Waiting Room	X							X										
Fire Pump Room	X						X		X	X								
General Waiting Areas	X							X										
Hazardous Material Storage / Enclosure																		
Bio Hazard Waste	X	X					X	X	X	X								
Fuel	X	X					X	X	X									
Liquid Oxygen	X	X					X	X	X									

BUILDING INTERIOR (continued)

Area of Coverage	Fixed Camera	Pan/Tilt/Zoom <sup>1</sup>	Controller	Monitor <sup>2</sup>	Recording Device	Matrix Switcher	Motion Det.	Glass Break	Door Contact <sup>3</sup>	Card Reader	Biometrics <sup>4</sup>	Intercom	Duress/Panic Alarm	Emer. Phone/Call Box	Optional <sup>5</sup>			
															X-Ray Mach.	WTMD	HHMD	Itemizer
															CCTV			
Medical Gas	X	X					X	X	X	X								
Propane	X	X					X	X	X									
Radioactive Materials Storage	X						X	X	X	X			X					
Select Agents Area	X						X	X	X	X			X					
Interstitial Space (Controlled Access)	X	X					X	X	X	X								
Information Resource Management (IRM)	X		X	X		X	X	X	X	X	X	X	X					
IRM Data Closet	X	X					X	X	X	X								
Laboratory (Clinical)	X	X	X	X		X	X	X	X	X		X	X					
Laundry Plant	X	X					X	X	X	X		X	X					
Library / Research	X						X	X	X	X			X					
Linen Supply / Storage	X						X	X	X									
Maintenance Shop	X	X					X	X	X				X					
Medical Directors Office	X	X					X	X	X	X		X	X					
Medical Gas Bulk Storage	X	X					X	X	X	X								
Medical Media Equipment Storage	X	X					X	X	X	X								
Medical Records Storage	X	X					X	X	X	X								
Nuclear Medicine Areas	X						X	X	X	X		X	X					
Nursing Home	X	X	X	X	X	X	X	X	X	X		X	X	X				
Operator Switchboard	X							X	X	X		X	X					
Pedestrian Corridor	X	X					X							X				
Pedestrian Tunnel/ Pathways	X	X					X							X				
Pedestrian Skywalk	X	X					X							X				
Pharmacy																		
Control Substance Room	X						X	X	X	X		X	X					
Dispensing Room	X						X	X	X	X		X	X					
Drug Cache	X						X	X	X	X		X						

BUILDING INTERIOR (continued)

Area of Coverage	Fixed Camera	Pan/Tilt/Zoom <sup>1</sup>	Controller	Monitor <sup>2</sup>	Recording Device	Matrix Switcher	Motion Det.	Glass Break	Door Contact <sup>3</sup>	Card Reader	Biometrics <sup>4</sup>	Intercom	Duress/Panic Alarm	Emer. Phone/Call Box	Optional <sup>5</sup>			
															X-Ray Mach.	WTMD	HHMD	Itemizer
															CCTV			
Drug Storage Room	X						X	X	X	X		X						
Inpatient / Outpatient Service Windows	X						X	X					X					
Manufacturing Area	X						X	X	X	X			X					
Primary Inventory (Medical Supplies)	X						X	X	X	X								
Psychiatric Units	X		X	X				X	X	X		X	X					
Research Clinical Labs	X		X	X			X	X	X	X		X	X					
Research Library	X		X	X			X	X	X	X		X	X					
Security Control Center (SCC)	X		X	X	X	X		X	X	X		X	X					
Security System Equipment Closets	X						X	X	X	X								
Shipping / Receiving Area																		
Loading Dock Bay Areas	X	X					X	X	X	X		X	X		X			X
Mailroom	X						X	X	X	X			X		X			X
Stairwells	X						X	X	X	X		X		X				
Telecommunication / Data Equipment Areas																		
Telephone Data Closet	X						X	X	X	X		X						
Main Computer Room	X						X	X	X	X		X						
Main Telephone Room	X						X	X	X	X		X						
Travel Office	X						X	X	X	X			X					
Utility Rooms																		
Battery-UPS-Generator Area	X						X	X	X	X		X						
Electrical	X						X	X	X	X		X						
Mechanical	X						X	X	X	X		X						
Signal	X						X	X	X	X		X						
Telecommunications	X						X	X	X	X		X						
Utility Tunnel Pathway	X	X					X		X	X				X				

**BUILDING INTERIOR** (continued)

Area of Coverage	Fixed Camera	Pan/Tilt/Zoom <sup>1</sup>	Controller	Monitor <sup>2</sup>	Recording Device	Matrix Switcher	Motion Det.	Glass Break	Door Contact <sup>3</sup>	Card Reader	Biometrics <sup>4</sup>	Intercom	Duress/Panic Alarm	Emer. Phone/Call Box	Optional <sup>5</sup>			
															X-Ray Mach.	WTMD	HHMD	Itemizer
															DSS			
CCTV							IDS			PACS		DSPI			DSS			
VA Benefits / Regional Office Building	X	X					X	X	X	X		X	X		X	X	X	X
VA Police Office																		
Holding Area	X		X	X	X			X	X	X		X						
Processing Room							X	X	X	X								
Property / Evidence Room	X						X	X	X	X								
Weapon Storage/armory	X		X	X	X		X	X	X	X								
Ward / Medical Treatment Room	X						X	X	X	X		X	X					

**Footnotes:**

1. P/T/Z cameras shall be deployed primarily to monitor site and building exterior areas. They will supplement the use of fixed cameras if they can be programmed to monitor multiple areas with minimal human interface required.
2. A dedicated CCTV camera monitor may be required to provide staff with the ability to monitor access to these controlled areas.
3. Door contacts shall be installed as a back-up to the use of security motion detection devices.
4. Biometric security devices shall only be used as a secondary means of providing access control. Card readers will be the primary security access device used.
5. The use of DSS equipment is indicated as an optional means to screen persons, items, and materials carried into or delivered to a facility. Each facility shall be addressed on a case-by-case basis as to DSS equipment requirements.

