

Key

 Study Area

HSE Consultation Zones

 DPZ

 Inner



Bristol City and South Gloucestershire Councils

Avonmouth and Severnside Study

HSE COMAH Inner Zones

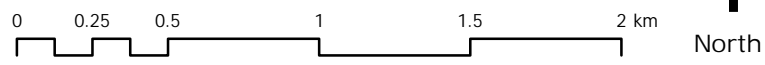
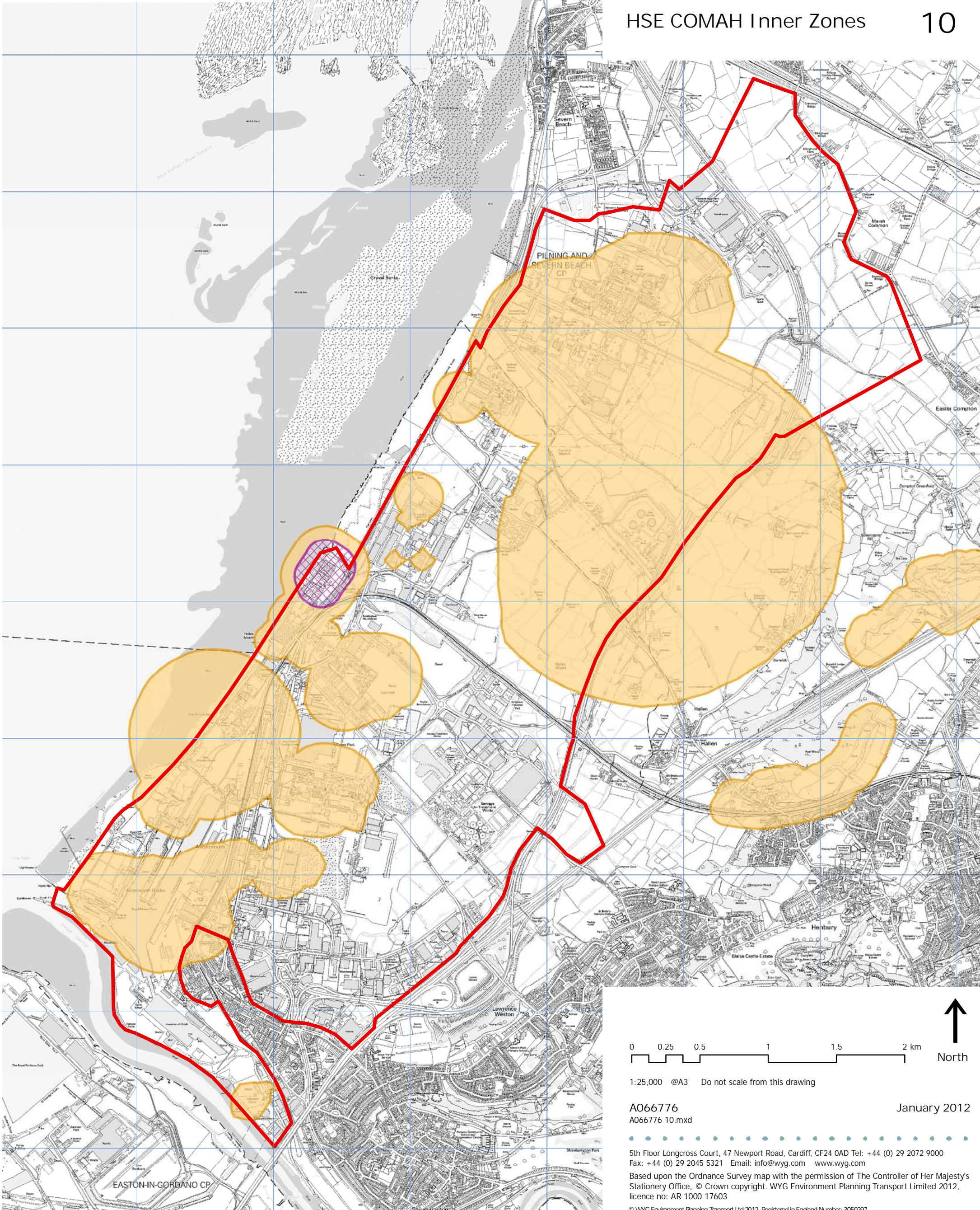

1:25,000 @A3 Do not scale from this drawing

A066776
A066776 10.mxd

January 2012

Key

Study Area

HSE Consultation Zones

DPZ

Inner

Middle

Outer



Bristol City and South Gloucestershire Councils

Avonmouth and Severnside Study

HSE COMAH Zones (All Zones)

09

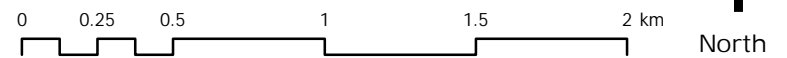
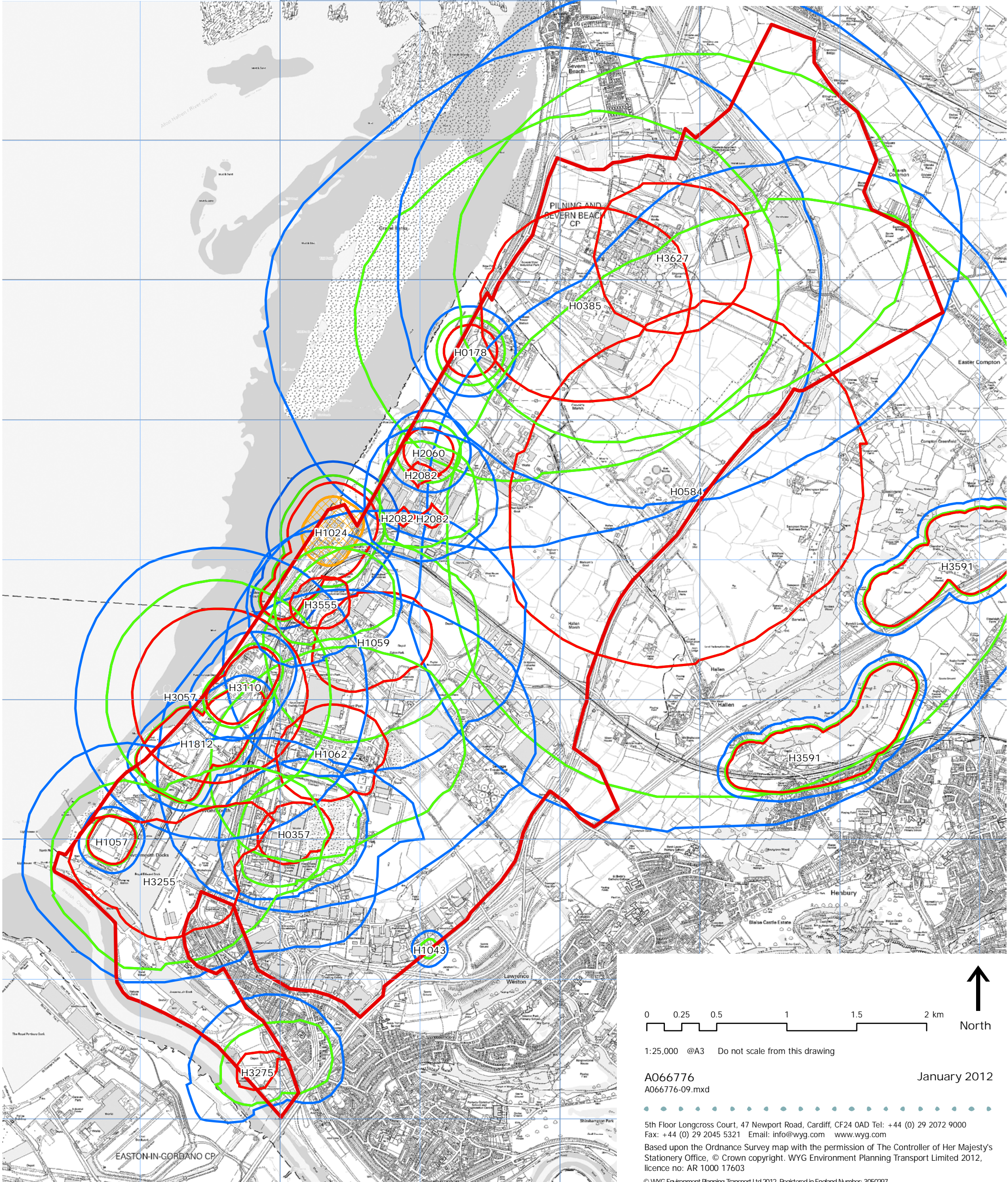

1:25,000 @A3 Do not scale from this drawing

A066776
A066776-09.mxd

January 2012

5th Floor Longcross Court, 47 Newport Road, Cardiff, CF24 0AD Tel: +44 (0) 29 2072 9000
Fax: +44 (0) 29 2045 5321 Email: info@wyg.com www.wyg.com

Based upon the Ordnance Survey map with the permission of The Controller of Her Majesty's Stationery Office, © Crown copyright. WYG Environment Planning Transport Limited 2012, licence no: AR 1000 17603

© WYG Environment Planning Transport Ltd 2012 Registered in England Number: 3050297

Key

 Study Area

HSE Consultation Zones

 DPZ

 Inner

 Middle

 Outer



Bristol City and South Gloucestershire Councils

Avonmouth and Severnside Study

HSE COMAH Zones (Combined)

08

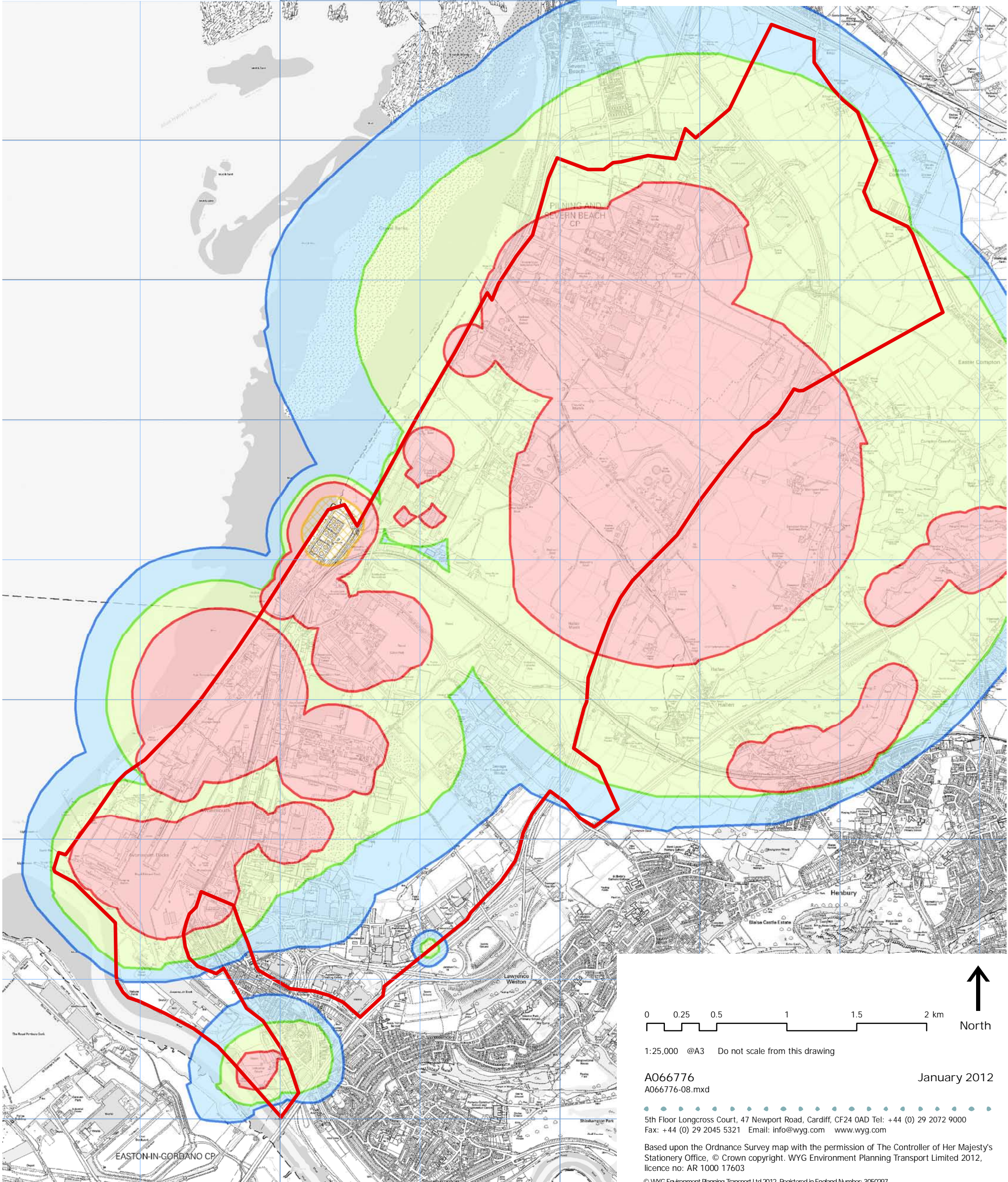

1:25,000 @A3 Do not scale from this drawing

A066776
A066776-08.mxd

January 2012

5th Floor Longcross Court, 47 Newport Road, Cardiff, CF24 0AD Tel: +44 (0) 29 2072 9000
Fax: +44 (0) 29 2045 5321 Email: info@wyg.com www.wyg.com

Based upon the Ordnance Survey map with the permission of The Controller of Her Majesty's Stationery Office, © Crown copyright. WYG Environment Planning Transport Limited 2012, licence no: AR 1000 17603

© WYG Environment Planning Transport Ltd 2012 Registered in England Number: 3050297

A066776 AVONMOUTH/ SEVERNSIDE STUDY
HSE - Control of Major Accident Hazards (COMAH)
Avonmouth/ Severnside - COMAH Sites Consultation Distances

Site No	HSE Site Ref	Site Type	Grid Ref	Site	Address	Approved	GIS Zones Prepared
1	H2060	Hazardous Substances Consent	ST 530 817	Shell Gas Ltd	Bank Road, Chittenting Industrial Estate, Smoke Lane, Avonmouth		Dec-02
2	H1059	Hazardous Substances Consent	ST 526 804	Albermarle Chemicals Uk Ltd, Avonmouth Works	Avonmouth Bristol, BS 11 0YT	16/01/02	Oct-06
3	H0385 & H3877	Hazardous Substances Consent	ST 540 830	Terra Nitrogen (Uk) Ltd & J H Bunn Ltd	Central Avenue, Avonmouth	31/01/02	Oct-09
4	H1062	Hazardous Substances Consent	ST523 796	Rhodia Organique Fine Ltd	Kings Weston Lane, Avonmouth	08/07/02	Nov-08
5	H3591	Hazardous Substances Consent	ST 556 795	The Oil & Pipelines Agency	Ison Hill, Hallen, Bristol BS10 7RH	06/09/02	Oct-06
6	H3255	Hazardous Substances Consent	ST 514 797	Bristol Port Company	Royal Edward Dock, Avonmouth BS11 9DQ	09/01/04	Oct-06
7	H3110	Hazardous Substances Consent	ST 517 800	Bristol Oil Storage Ltd	Holesmouth Road, Royal Edward Docks	25/05/04	Oct-06
8	H0178	Hazardous Substances Consent	ST 533 825	Transco Ltd, Seabank Works	Severn Road, Hallen, Avonmouth	19/09/05	Nov-08
9	H3275	Hazardous Substances Consent	ST 519 773	Dalgety Arable Ltd, Avonmouth Mill	Victoria Road, Avonmouth	07/10/05	Nov-08
10	H3555	Hazardous Substances Consent	ST 523 807	JE Clarke & Co Transport Ltd	Smoke Lane Avonmouth	02/05/06	Nov-08
11	H0357	Hazardous Substances Consent	ST 520 790	Yara Uk Ltd	St Andrews Road, Avonmouth		Oct-06
12	H3057	Hazardous Substances Consent	ST 514 797	BP Oil (Uk) Ltd, Avonmouth LPA Terminal	Royal Edward Dock, Avonmouth BS11 9BT		Oct-06
13	H2082	Hazardous Substances Consent	ST 529 813	AE Murphy Warehousing Ltd	Chittening Estate, Avonmouth BS11 0YB		Oct-06
14	H1043	Hazardous Substances Consent	ST 530 782	Handygas Ltd	Fourth Way, Avonmouth Bristol, BS11 8DL		Oct-06
15	H0584	Hazardous Substances Consent	ST 547 813	LNG Storage/ National Grid plc	Severn Road, Hallen, Avonmouth	19/06/06	Oct-07
16	H1057	Hazardous Substances Consent	ST 510 790	Shell Oil	Royal Edward Dock, Avonmouth	07/11/06	Nov-08
17	H1812	Hazardous Substances Consent	ST 516 796	GATX Terminals Ltd	Royal Edward Dock, Avonmouth, BS11 9BT	09/08/07	Oct-07
18	H3627	Hazardous Substances Consent	ST 545 835	Astra Zeneca Avlon Works	Severn Road, Hallen, Avonmouth BS10 7ZE	07/09/07	Oct-07
19	H1024	Hazardous Substances Consent	ST 523 810	Esso Petroleum Ltd	Avonmouth Terminal, Holesmouth, Avonmouth, BS11 9BN	10/08/10	Sep-10

Enquiry Ref : BRISTOL GENERAL - 111165/AJB/MC

Your Ref :

Date : 18 February 2011

For the attention of Mr Andrew Strange

WYG - White Young Green

Ropemaker Court

12 Lower Park Row

Bristol

Avon

BS1 5BN

Dear Sir/Madam

FISHER GERMAN LLP
GPSS
PO BOX 7273
ASHBY DE LA ZOUCH
LEICESTERSHIRE
LE65 2BY

Telephone 0845 070 1245

Fax 0845 070 1250

Email: gpss@gpss.info

GOVERNMENT PIPELINES AND STORAGE SYSTEM

A066776 - LS-110216-UX-516-TDF

Thank you for your letter dated 16/02/2011 09:25:00

We can confirm that our client's apparatus, the Government Pipelines and Storage System (GPSS), may be affected by your proposals as indicated on the attached plan(s). The plan(s) supplied are intended for general guidance only and should not be relied upon for excavation or construction purposes. No guarantee is given regarding the accuracy of the information provided and in order to verify the accurate location of the pipeline in conjunction with your proposals you should contact OPA Central Services, to arrange a site visit. Their contact details are given below.

OPA Central Services

Ashdon Road

Saffron Walden

Essex

CB10 2NF

Tel: 01799 564101

anne.swallow@oilandpipelines.com

When contacting OPA Central Services, please quote the Enquiry Ref given at the top of this letter, which is specific to this enquiry. Please note that you should contact OPA Central Services within 28 days of the date of this letter in order to validate this enquiry otherwise it will become void.

You should note that the interests of the GPSS are conserved by means of the Land Powers (Defence) Act 1958, in particular Section 16 of the Act, and other legislation such as the Pipeline Safety Regulations 1996. It is, however, the Land Powers (Defence) Act 1958 that specifically prohibits any development and most intrusive activities within a GPSS Wayleave without specific consent from the Secretary of State for Defence. GPSS Wayleaves are generally 6 metres wide and bstride the pipeline 3 metres on either side and can incorporate other associated GPSS facilities.

OPA Central Services will be able to provide guidance on the required procedures for entering into a Section 16 Consent and provide confirmation on permitted development and intrusive activities. The whole process of obtaining Section 16 Consent can take between four and six weeks depending on circumstances at the time of application.

To reiterate, you should not undertake any work or activity without first contacting the GPSS Operator for advice and, if required, Section 16 Consent.

For your additional information please visit www.linesearch.org, subheading useful information, standard requirements for working/crossing Government pipelines.

You should also be aware that landowners and third parties have a duty of care not to carry out any works that have the potential to damage GPSS apparatus. This duty of care applies even if the works themselves are situated more than 3 metres from the pipeline. Examples of such works are mineral extraction, mining, explosives, piling and windfarms.

Please note that implementation of any unapproved work that affects a GPSS Wayleave may result in serious consequences in terms of health and safety, expense and other attendant liabilities. In such cases it is the perpetrator of the act, together with any other promoting organisation, that shall be held fully accountable for any resulting damage.

Should you require any further assistance regarding this letter please contact the undersigned or alternatively, you can contact the OPA Central Services using the details provided above.

Yours faithfully



FISHER GERMAN LLP (GPSS LAND AGENT)

Enc Location Plan
Special Requirements Booklet

CC OPA Central Services
Information for OPA Central Services
Third Party Contact Details:
07900 570254

General. ?

Morag McRae

From: andrew.strange [andrew.strange@wyg.com]
Sent: 17 February 2011 09:30
To: GPSS
Subject: RE: A066776 - Avonmouth/Severnside - Pipelines [Filed 16 Feb 2011 12:09]

Please note that my linesearch reference is LS-110216-UX-516-TDF

AFFECTED

353800, 180800
5,000 in search.

Regards

Andrew Strange
Regional Director

Tel: +44 (0)117 9254393

.....
WYG Environment Planning Transport Ltd. Registered in England number: 3050297. Registered Office: Arndale Court, Otley Road, Headingley, Leeds, West Yorkshire LS6 2UJ VAT No: 431-0326-08

From: GPSS [mailto:gpss@gpss.info]
Sent: 16 February 2011 12:06
To: andrew.strange
Subject: RE: A066776 - Avonmouth/Severnside - Pipelines

Dear Andrew

Thank you for your search enquiry sent to GPSS requesting details of apparatus at this location – please can you supply the Linesearch reference number so we can process your request more efficiently.

If you have not used the free website www.linesearch.org for this enquiry please note that GPSS have their apparatus information on the site and direct all enquirers to it use it in the first instance and receive an instant response to their enquiry. They would only search on someone's behalf if they have no access to the internet.

There are currently 27 operators who have their apparatus on the www.linesearch.org site which receives in excess of 75,000 enquiries a month. There is also a demonstration of the enquiry process on the sites home page. I have pleasure in attaching further information about the site for your attention.

When using www.linesearch.org it is not necessary to send written requests for searches to the operators covered unless it falls within a zone of interest. By using www.linesearch.org you are deemed to have served notice to the operators covered by the site. If the search indicates that your work will fall in the zone of interest for an operator requiring you to contact them please ensure you quote the Linesearch reference number on the letter and enclose a plan.

Yours faithfully

gpss@gpss.info
0845 070 1245

Bristol lines AFF

AH 18.2.11

From: andrew.strange [mailto:andrew.strange@wyg.com]
Sent: 15 February 2011 16:54
To: GPSS
Subject: A066776 - Avonmouth/Severnside - Pipelines

ST537804

Sir/Madam

Morag McRae

From: andrew.strange [andrew.strange@wyg.com]
Sent: 15 February 2011 16:54
To: GPSS
Subject: A066776 - Avonmouth/Sevenside - Pipelines
Attachments: A066776_01 Existing Development.pdf

Sir/Madam

We are undertaking an infrastructure study for the Avonmouth/Sevenside area on behalf of the South West RDA, Bristol City and South Gloucestershire Councils. I attach a plan that shows the extent of the study area.

Please could you confirm whether any of the pipelines for which you are responsible lie within this area and, if they do, forward a plan to show their location?

Thanks.

Andrew Strange
Regional Director

WYG PLANNING & DESIGN

Ropemaker Court, 12 Lower Park Row, Bristol, BS1 5BN

Tel: +44 (0)117 9254393

Fax: +44 (0)117 9254239

Mob: +44(0)7900570254

www.wyg.com

.....
WYG Environment Planning Transport Ltd. Registered in England number: 3050297. Registered Office: Arndale Court, Otley Road, Headingley, Leeds, West Yorkshire LS6 2UJ VAT No: 431-0326-08

Winner Institution of Civil Engineers Award 2010

Winner BREEAM (BRE Environmental Assessment Method) Award 2010

Winner Royal Institute of British Architects Award 2010

Winner NCE/ACE Consultants of the Year 2009 'Outstanding Contribution Award'

Winner RoSPA Occupational Health and Safety Gold Medal Award 2009

Winner British Expertise Awards 2009

This message contains confidential information and is intended only for the recipient. If you are not the recipient you should not disseminate, distribute or copy this e-mail. Please notify the sender immediately by e-mail if you have received this e-mail by mistake and delete this e-mail from your system. E-mail transmission cannot be guaranteed to be secure or error-free as information could be intercepted, corrupted, lost, destroyed, arrive late or incomplete, or contain viruses. The sender therefore does not accept liability for any errors or omissions in the contents of this message, which arise as a result of e-mail transmission. If verification is required please request a hard-copy version.

This email has been scanned by the MessageLabs Email Security System.
For more information please visit <http://www.messagelabs.com/email>

Key

-  Study Area
-  Completions

FISHER GERMAN LLP

**South West Regional
 Development Agency**

PO BOX 7273
 ASHBY DE LA ZOUCH
 LEICESTERSHIRE
 LE65 2BY

Avonmouth & Severnside Study

Existing development Telephone 0845 070 1011

Fax 0845 070 1250

Email: gpass@gpass.info

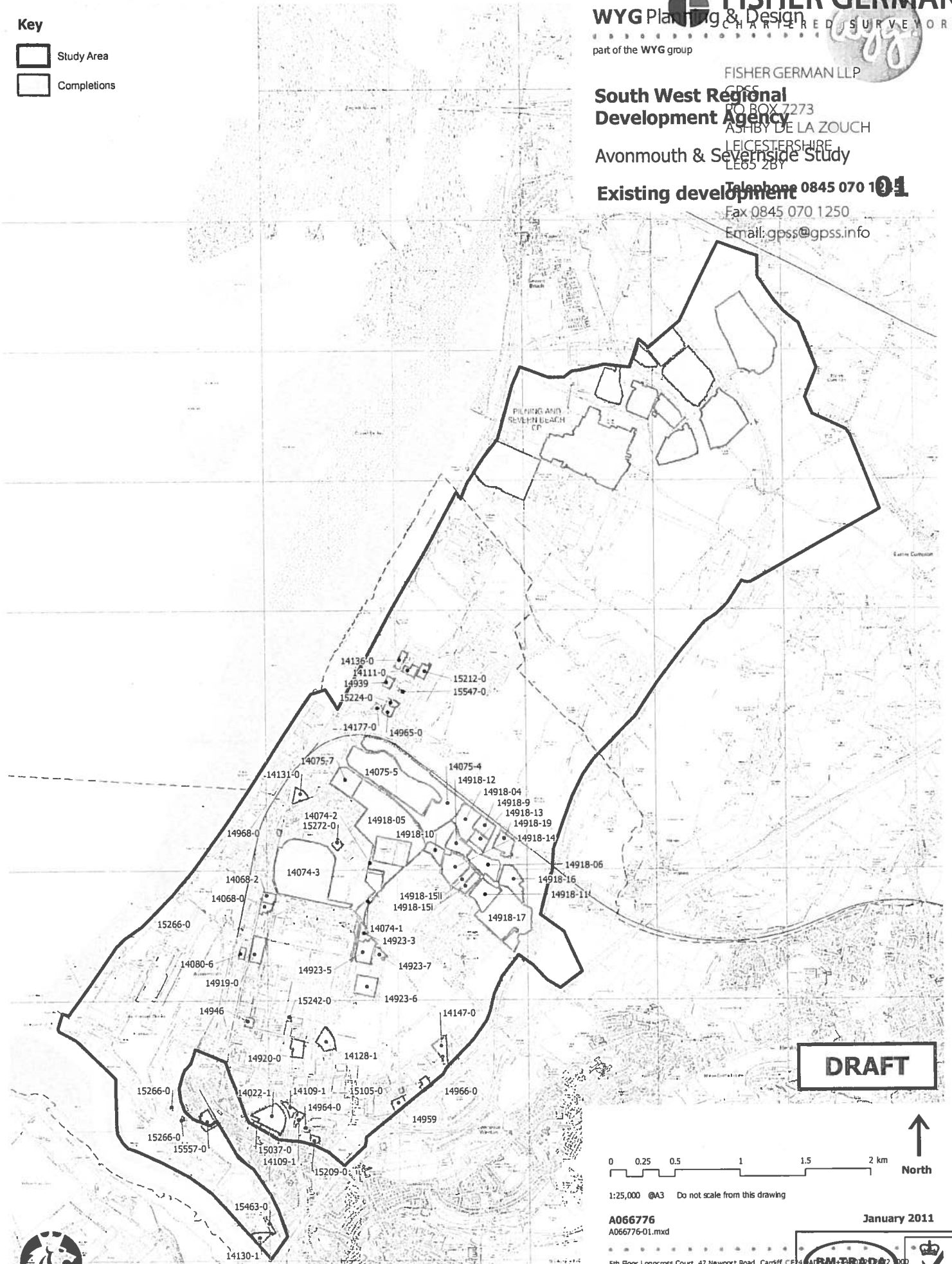

DRAFT

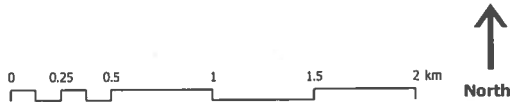

1:25,000 @A3 Do not scale from this drawing

A066776
 A066776-01.mxd

January 2011





Fisher German LLP is a limited liability partnership. Registered in England and Wales. Registered Number: OC317554.
 Registered Office: 40 High Street, Market Harborough, Leicestershire LE16 7NX.
 A list of members names is available for inspection at the Market Harborough office.
 Regulated by RICS.

5th Floor Longcross Court, 47 Newport Road, Cardiff, CF4 4AG
 Fax: +44 (0) 29 2045 5321 Email: info@wyg.com www.wyg.com

Based upon the Ordnance Survey map with the permission of The Controller of Her Majesty's Stationery Office. © Crown copyright. WYG Environment Planning Transport Limited 2011
 Licence no: AR 1000 17603

© WYG Environment Planning Transport Ltd 2011 Registered in England Number 3060227

WARNING

THIS DRWG. IS NOT TO BE USED FOR CONSTRUCTION PURPOSES, THE LOCATION OF THE PIPE MUST BE VERIFIED AND PEGGED ON SITE BY THE PIPELINE OPERATOR BEFORE ANY EXCAVATION OR CONSTRUCTION WORK COMMENCES.

FOR FURTHER DETAILS PLEASE CONTACT FISHER GERMAN ON 01530 412821 REFERENCE NOS.....

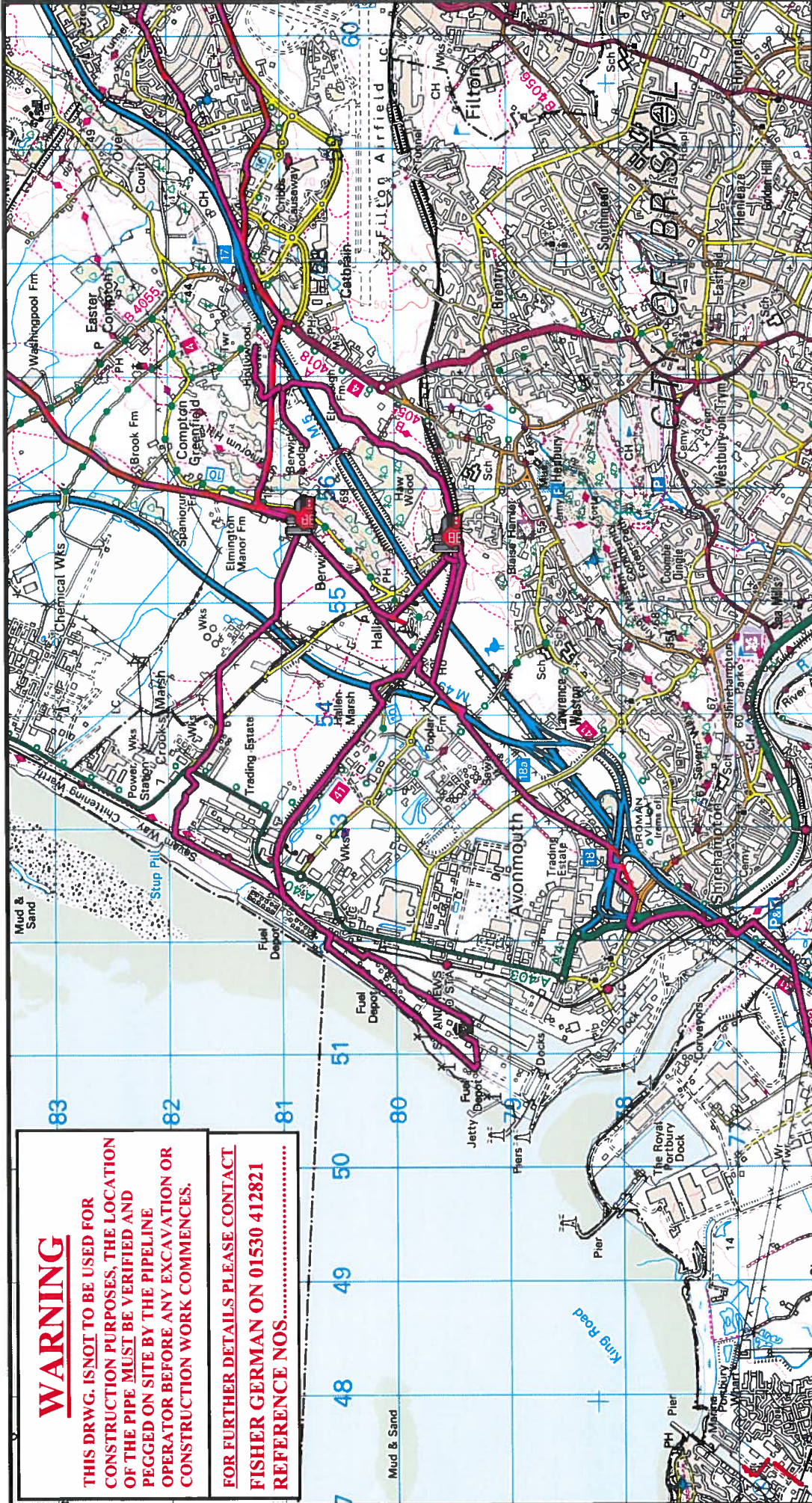

Approximate position only
Contact Pipeline Operator
prior to works.

"This plan must not be copied or reproduced without prior written consent from the office of origin."



FISHER GERMAN
CHARTERED SURVEYORS

Fisher German LLP, The Grange
80 Tamworth Road, Ashby de la Zouch,
Leicestershire, LE65 2BW
Fax: (01530) 413896 and Telephone: (01530) 412821

GPSS LOCATION PLAN EXTRACT OF PIPELINE BRISTOL LINES

**DATE: FEBRUARY 2011
NOT TO SCALE**

THIS DRAWING IS PROTECTED BY COPYRIGHT. IT MAY NOT BE REPRODUCED IN ANY FORM OR BY ANY MEANS FOR ANY PURPOSE, WITHOUT THE WRITTEN PERMISSION OF FISHER GERMAN LLP CHARTERED SURVEYORS. FISHER GERMAN LLP IS A LIMITED LIABILITY PARTNERSHIP REGISTERED IN ENGLAND AND WALES. REGISTERED NUMBER: 06231764

Reproduced from Ordnance Survey maps with the sanction of the Controller of HM Stationery Office Reference No. EP755672 Crown Copyright reserved

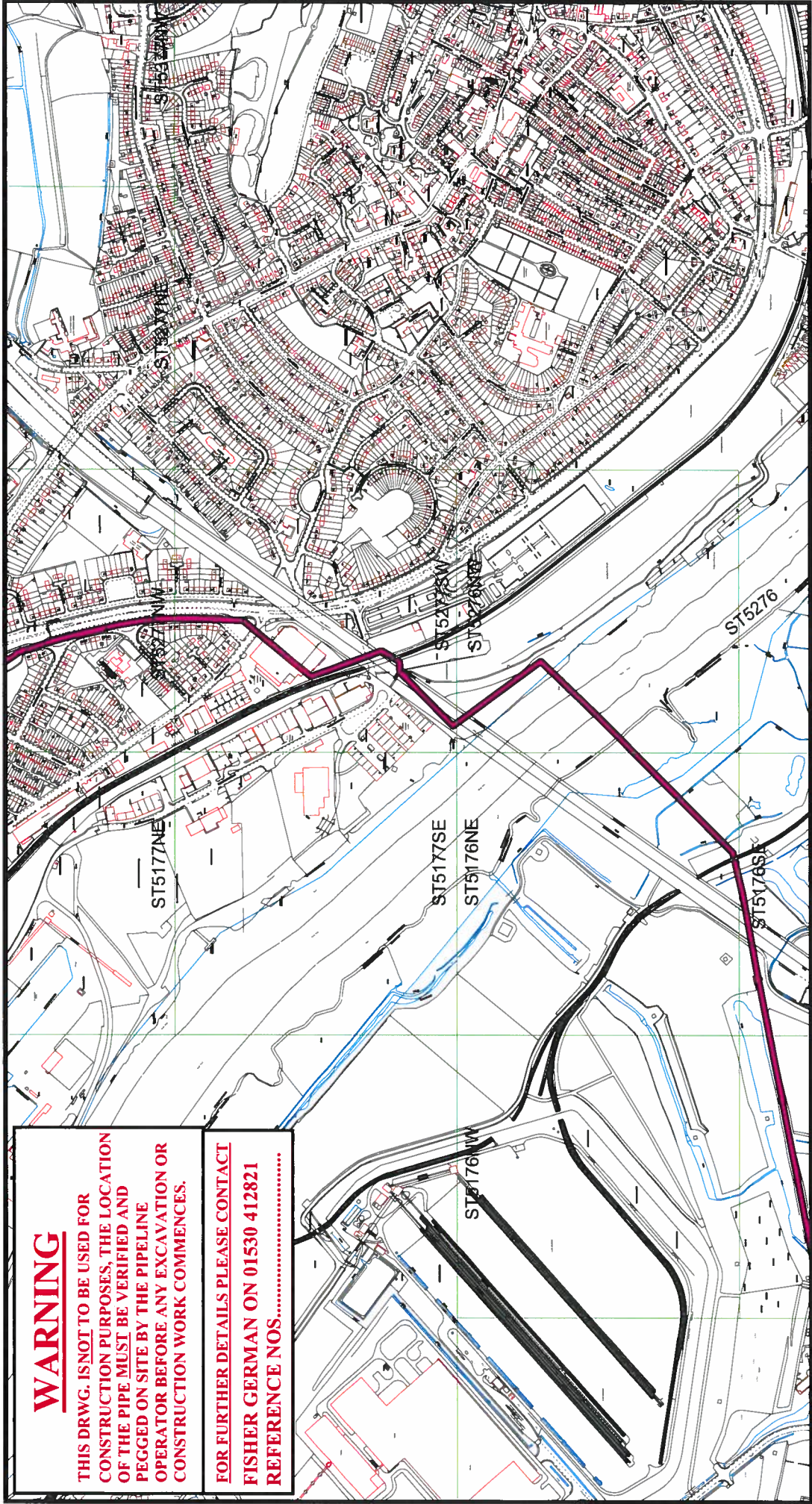

WARNING
 THIS DRWG. IS NOT TO BE USED FOR
 CONSTRUCTION PURPOSES, THE LOCATION
 OF THE PIPE MUST BE VERIFIED AND
 PEGGED ON SITE BY THE PIPELINE
 OPERATOR BEFORE ANY EXCAVATION OR
 CONSTRUCTION WORK COMMENCES.

FOR FURTHER DETAILS PLEASE CONTACT
 FISHER GERMAN ON 01530 412821
 REFERENCE NOS.....



Approximate position only
 Contact Pipeline Operator
 prior to works.

"This plan must not be
 copied or reproduced without
 prior written consent from
 the office of origin."



FISHER GERMAN

Fisher German LLP, The Grange
 80 Tamworth Road, Ashby de la Zouch,
 Leicestershire, LE65 2BW
 Fax: (01530) 413896 and Telephone: (01530) 412821

**GPSS LOCATION PLAN
 EXTRACT OF PIPELINE RW/BW**

**DATE: FEBRUARY 2011
 NOT TO SCALE**

THIS DRAWING IS PROTECTED BY COPYRIGHT. IT MAY NOT BE REPRODUCED IN
 ANY FORM OR BY ANY MEANS FOR ANY PURPOSE WITHOUT WRITTEN
 PERMISSION OF FISHER GERMAN LLP. CHARTERED SURVEYORS
 FISHER GERMAN LLP IS A LIMITED LIABILITY PARTNERSHIP
 REGISTERED IN ENGLAND AND WALES. REGISTERED NUMBER: OC17564

Reproduced from Ordnance Survey maps with the
 sanction of the Controller of HM Stationery Office
 Reference No. EP755672 Crown Copyright reserved

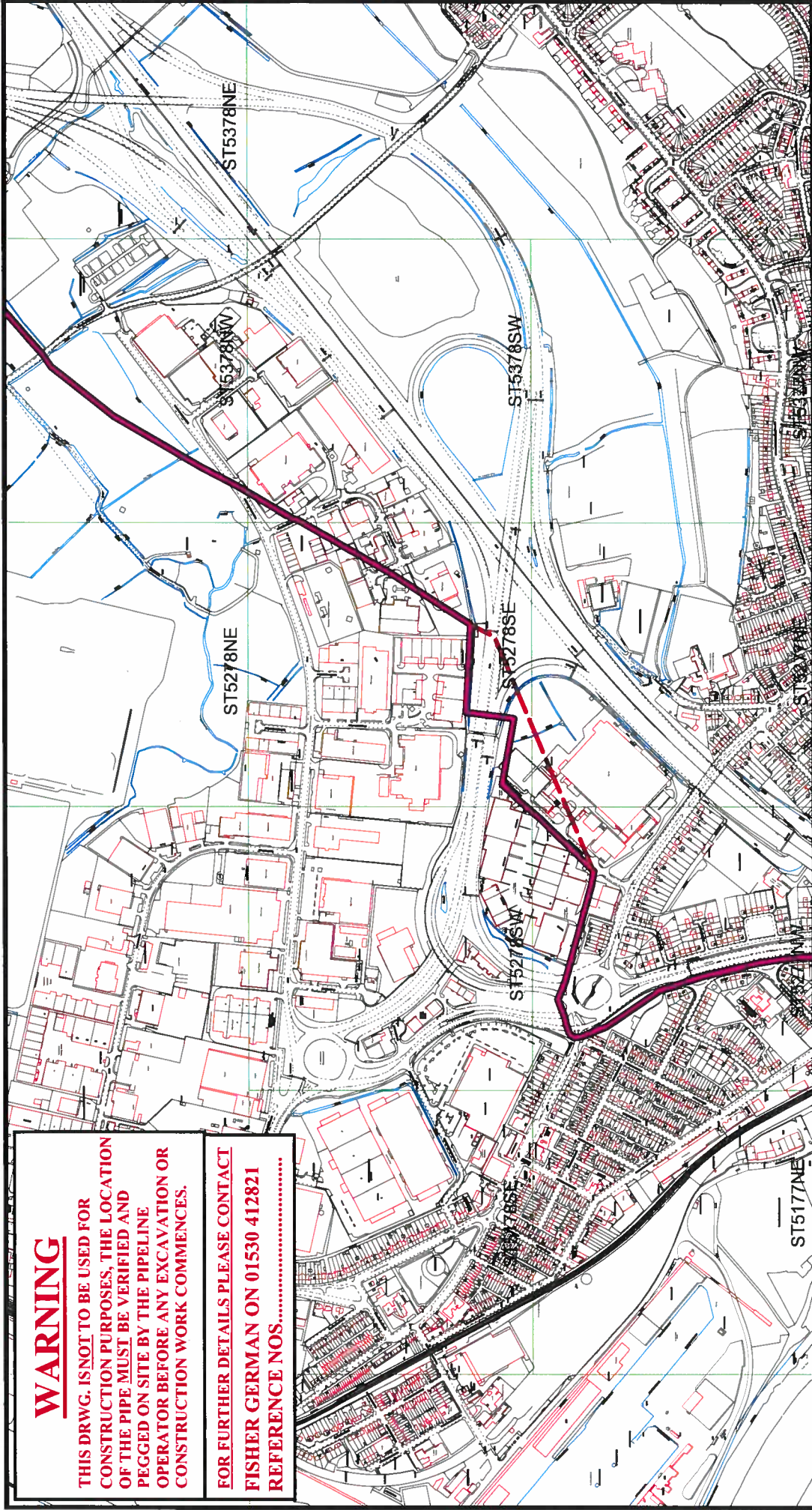

WARNING

THIS DRWG. IS NOT TO BE USED FOR CONSTRUCTION PURPOSES, THE LOCATION OF THE PIPE MUST BE VERIFIED AND PEGGED ON SITE BY THE PIPELINE OPERATOR BEFORE ANY EXCAVATION OR CONSTRUCTION WORK COMMENCES.

FOR FURTHER DETAILS PLEASE CONTACT FISHER GERMAN ON 01530 412821 REFERENCE NOS.....



Approximate position only
Contact Pipeline Operator
prior to works.

"This plan must not be copied or reproduced without prior written consent from the office of origin."

Reproduced from Ordnance Survey maps with the sanction of the Controller of HM Stationery Office Reference No. EP755672 Crown Copyright reserved



FISHER GERMAN
CHARTERED SURVEYORS

Fisher German LLP, The Grange
80 Tamworth Road, Ashby de la Zouch,
Leicestershire, LE65 2BW
Fax: (01530) 413896 and Telephone: (01530) 412821

**GPSS LOCATION PLAN
EXTRACT OF PIPELINE RW/BW**

**DATE: FEBRUARY 2011
NOT TO SCALE**

THIS DRAWING IS PROTECTED BY COPYRIGHT. IT MAY NOT BE REPRODUCED IN ANY FORM OR BY ANY MEANS FOR ANY PURPOSE WITHOUT WRITTEN PERMISSION OF FISHER GERMAN LLP. CHARTERED SURVEYORS. FISHER GERMAN LLP IS A LIMITED LIABILITY PARTNERSHIP. REGISTERED IN ENGLAND AND WALES. REGISTERED NUMBER: 06317564

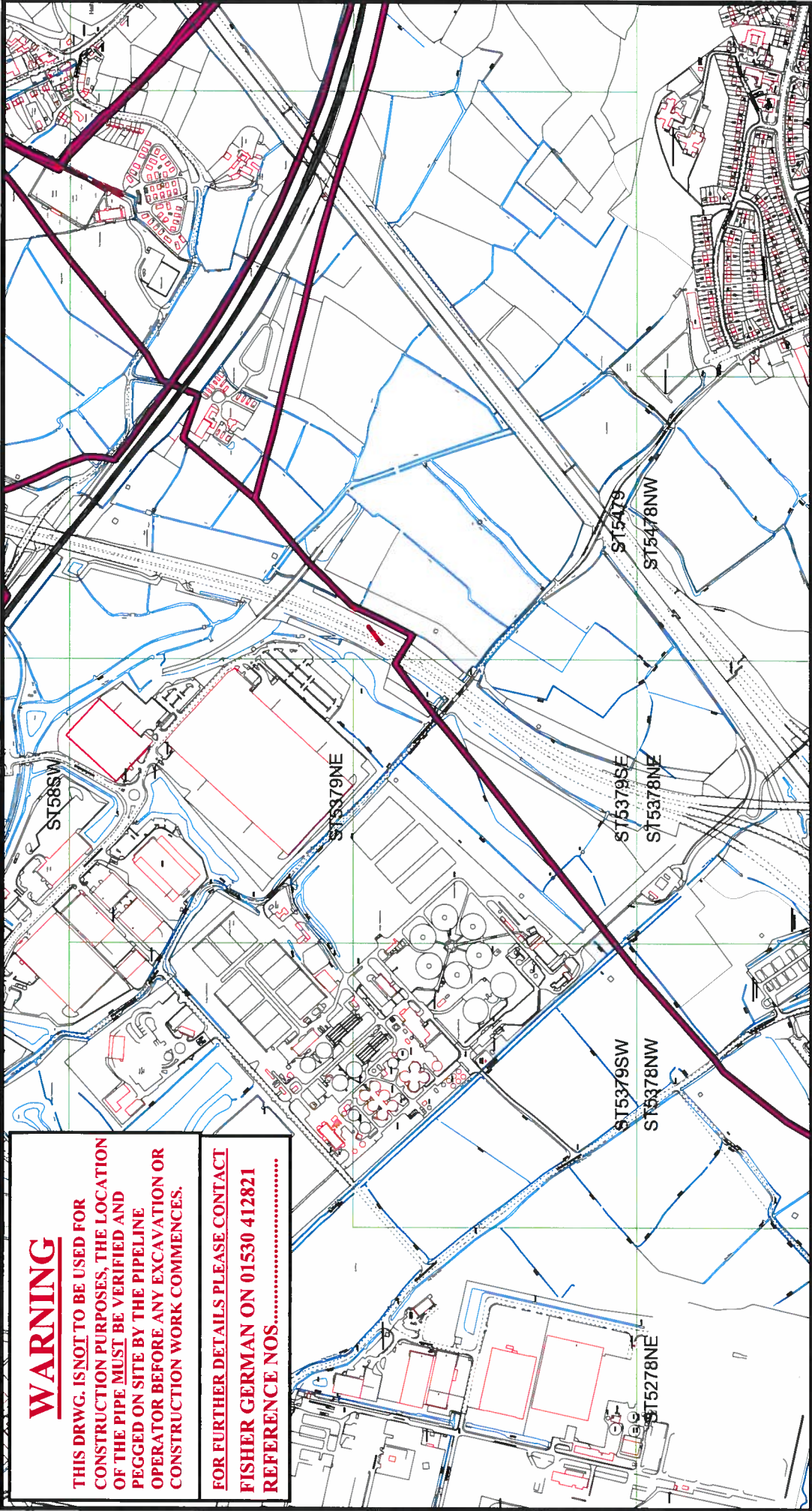

WARNING
 THIS DRWG. IS NOT TO BE USED FOR CONSTRUCTION PURPOSES, THE LOCATION OF THE PIPE MUST BE VERIFIED AND PEGGED ON SITE BY THE PIPELINE OPERATOR BEFORE ANY EXCAVATION OR CONSTRUCTION WORK COMMENCES.

FOR FURTHER DETAILS PLEASE CONTACT FISHER GERMAN ON 01530 412821 REFERENCE NOS.....



Approximate position only
 Contact Pipeline Operator
 prior to works.

"This plan must not be copied or reproduced without prior written consent from the office of origin."

Reproduced from Ordnance Survey maps with the sanction of the Controller of HM Stationery Office Reference No. EP755672 Crown Copyright reserved

FISHER GERMAN
 CHARTERED SURVEYORS

Fisher German LLP, The Grange
 80 Tamworth Road, Asby de la Zouch,
 Leicestershire, LE65 2BW
 Fax: (01530) 413896 and Telephone: (01530) 412821

GPSS LOCATION PLAN
EXTRACT OF PIPELINE RW/BW

DATE: FEBRUARY 2011
NOT TO SCALE

THIS DRAWING IS PROTECTED BY COPYRIGHT. IT MAY NOT BE REPRODUCED IN ANY FORM OR BY ANY MEANS FOR ANY PURPOSE WITHOUT WRITTEN PERMISSION OF FISHER GERMAN LLP CHARTERED SURVEYORS
 FISHER GERMAN LLP IS A LIMITED LIABILITY PARTNERSHIP.
 REGISTERED IN ENGLAND AND WALES. REGISTERED NUMBER: OC31754

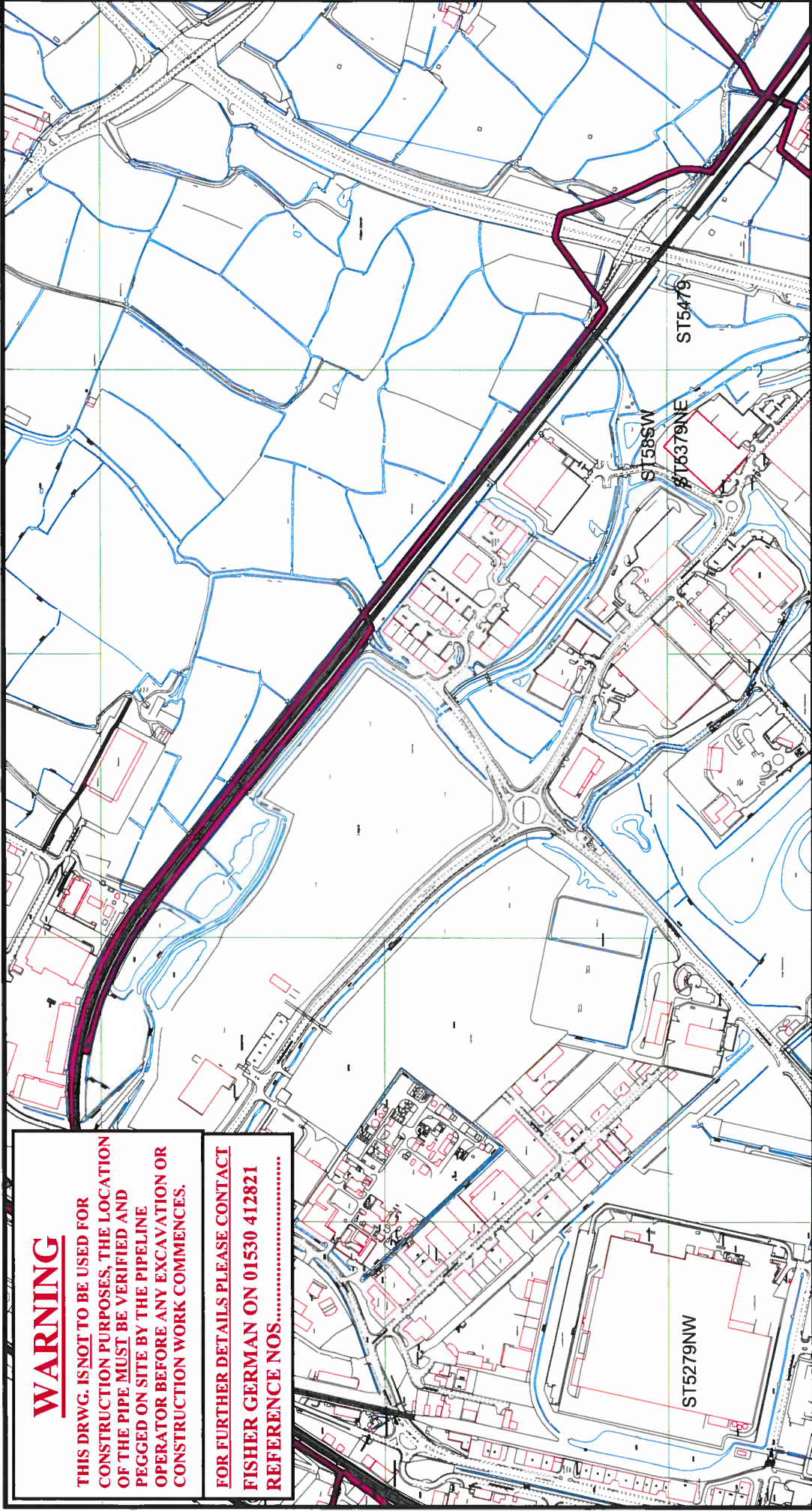

WARNING
 THIS DRWG. IS NOT TO BE USED FOR CONSTRUCTION PURPOSES, THE LOCATION OF THE PIPE MUST BE VERIFIED AND PEGGED ON SITE BY THE PIPELINE OPERATOR BEFORE ANY EXCAVATION OR CONSTRUCTION WORK COMMENCES.

FOR FURTHER DETAILS PLEASE CONTACT
FISHER GERMAN ON 01530 412821
 REFERENCE NOS.....



Approximate position only
 Contact Pipeline Operator
 prior to works.

"This plan must not be copied or reproduced without prior written consent from the office of origin."

Reproduced from Ordnance Survey maps with the sanction of the Controller of HM Stationery Office
 Reference No. EP755672 Crown Copyright reserved

FISHER GERMAN
 CHARTERED SURVEYORS

Fisher German LLP, The Grange
 80 Tamworth Road, Ashby de la Zouch,
 Leicestershire, LE65 2BW

Fax: (01530) 413896 and Telephone: (01530) 412821

**GPSS LOCATION PLAN
 EXTRACT OF PIPELINE H/A(6)**

**DATE: FEBRUARY 2011
 NOT TO SCALE**

THIS DRAWING IS PROTECTED BY COPYRIGHT. IT MAY NOT BE REPRODUCED IN ANY FORM OR BY ANY MEANS FOR ANY PURPOSE WITHOUT WRITTEN PERMISSION OF FISHER GERMAN LLP CHARTERED SURVEYORS
 FISHER GERMAN LLP IS A LIMITED LIABILITY PARTNERSHIP
 REGISTERED IN ENGLAND AND WALES. REGISTERED NUMBER: OC31754

WARNING

THIS DRWG. IS NOT TO BE USED FOR CONSTRUCTION PURPOSES, THE LOCATION OF THE PIPE MUST BE VERIFIED AND PEGGED ON SITE BY THE PIPELINE OPERATOR BEFORE ANY EXCAVATION OR CONSTRUCTION WORK COMMENCES.

FOR FURTHER DETAILS PLEASE CONTACT FISHER GERMAN ON 01530 412821 REFERENCE NOS.....

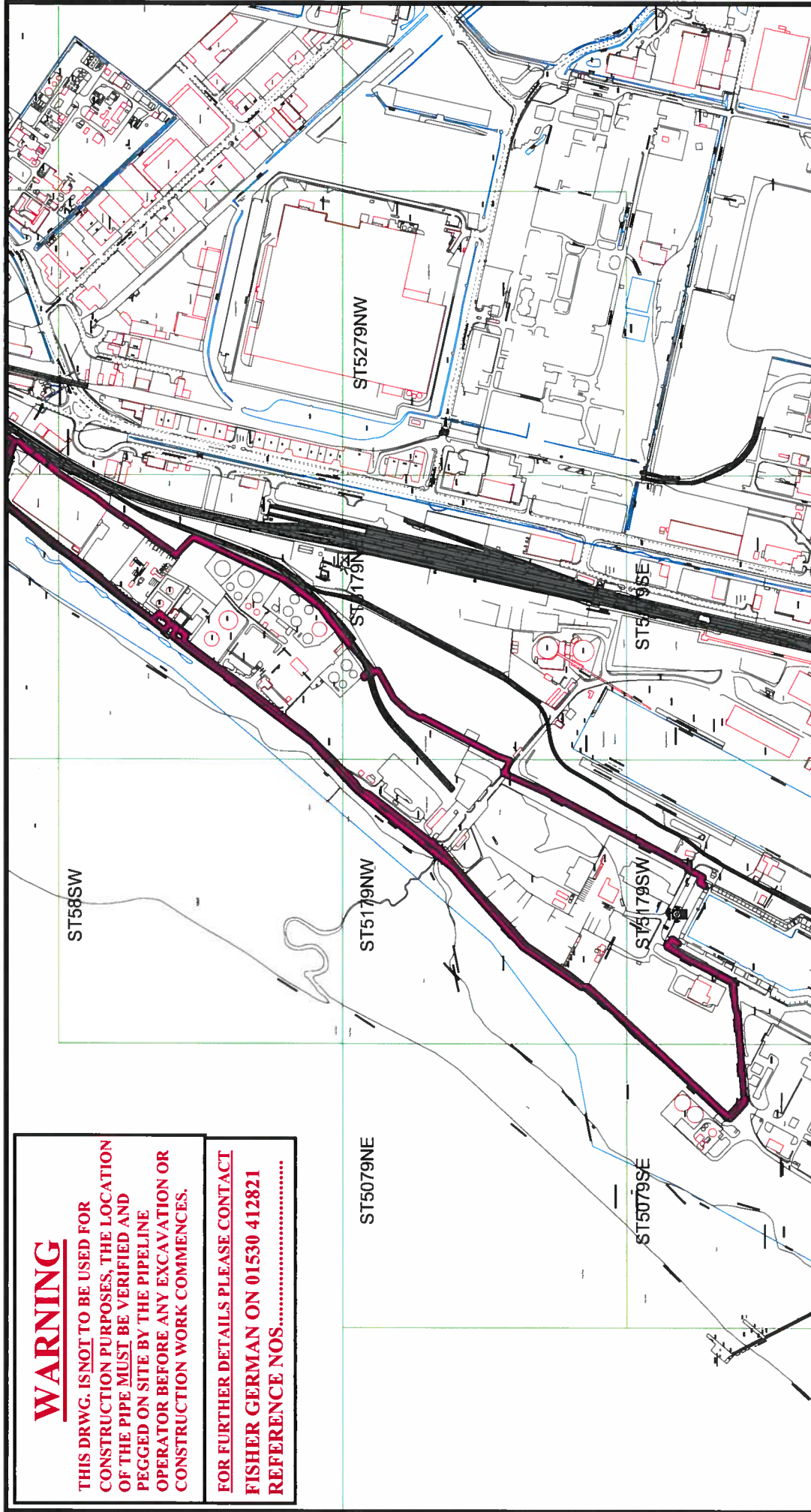

Approximate position only
Contact Pipeline Operator
prior to works.

"This plan must not be copied or reproduced without prior written consent from the office of origin."



GPSS LOCATION PLAN EXTRACT OF PIPELINE H/A(6) & B/A

Fisher German LLP, The Grange
80 Tamworth Road, Ashby de la Zouch,
Leicestershire, LE65 2BW
Fax: (01530) 413896 and Telephone: (01530) 412821

**DATE: FEBRUARY 2011
NOT TO SCALE**

Reproduced from Ordnance Survey maps with the sanction of the Controller of HM Stationery Office Reference No. EPT55672 Crown Copyright reserved

THIS DRAWING IS PROTECTED BY COPYRIGHT. IT MAY NOT BE REPRODUCED IN ANY FORM OR BY ANY MEANS FOR ANY PURPOSE WITHOUT WRITTEN PERMISSION OF FISHER GERMAN LLP CHARTERED SURVEYORS
FISHER GERMAN LLP IS A LIMITED LIABILITY PARTNERSHIP.
REGISTERED IN ENGLAND AND WALES - REGISTERED NUMBER: OC171544

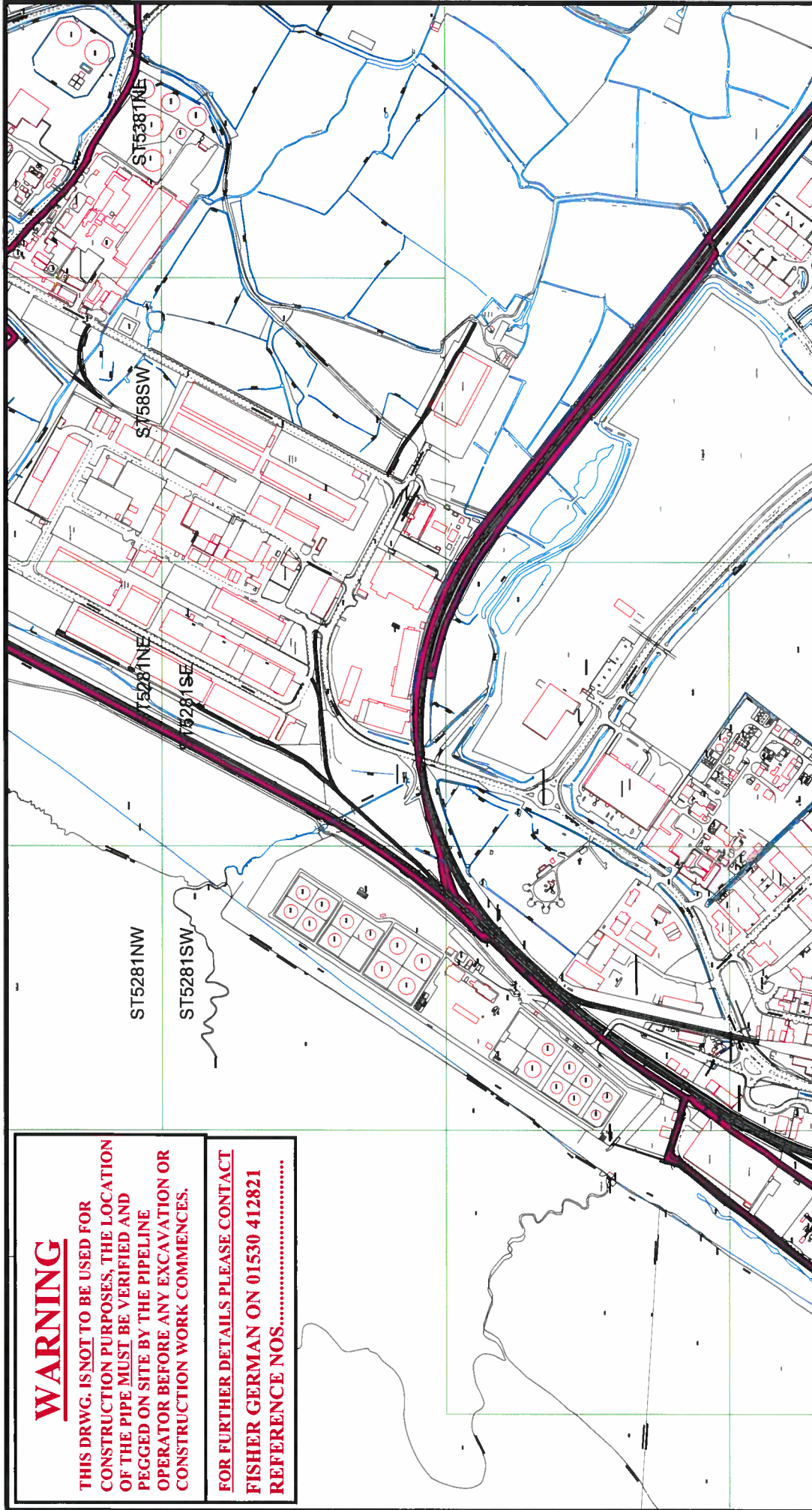

WARNING

THIS DRWG. IS NOT TO BE USED FOR CONSTRUCTION PURPOSES, THE LOCATION OF THE PIPE MUST BE VERIFIED AND PEGGED ON SITE BY THE PIPELINE OPERATOR BEFORE ANY EXCAVATION OR CONSTRUCTION WORK COMMENCES.

FOR FURTHER DETAILS PLEASE CONTACT

**FISHER GERMAN ON 01530 412821
REFERENCE NOS.....**



Reproduced from Ordnance Survey maps with the sanction of the Controller of HM Stationery Office
Reference No. EP755672 Crown Copyright reserved

**Approximate position only
Contact Pipeline Operator
prior to works.**

**"This plan must not be
copied or reproduced without
prior written consent from
the office of origin."**

**GPSS LOCATION PLAN
EXTRACT OF PIPELINE H/A(6), B/A & C/B**

**DATE: FEBRUARY 2011
NOT TO SCALE**



**Fisher German LLP, The Grange
80 Tamworth Road, Ashby de la Zouch,
Leicestershire, LE65 2BW
Fax: (01530) 413896 and Telephone: (01530) 412821**

**THIS DRAWING IS PROTECTED BY COPYRIGHT. IT MAY NOT BE REPRODUCED IN ANY FORM OR BY ANY MEANS FOR ANY PURPOSE WITHOUT WRITTEN PERMISSION OF FISHER GERMAN LLP CHARTERED SURVEYORS
FISHER GERMAN LLP IS A LIMITED LIABILITY PARTNERSHIP
REGISTERED IN ENGLAND AND WALES. REGISTERED NUMBER: OC171564**

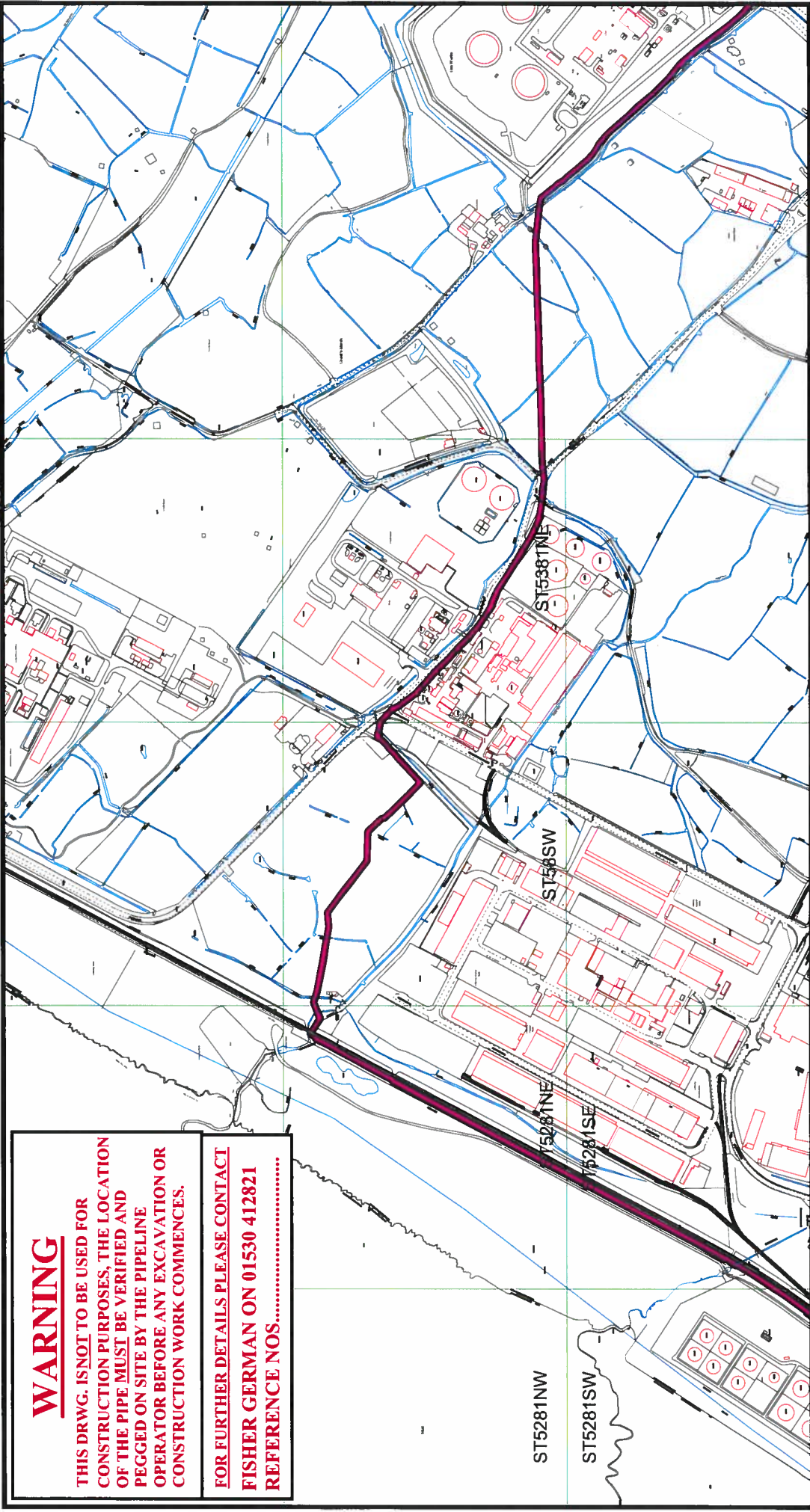

WARNING
 THIS DRWG. IS NOT TO BE USED FOR CONSTRUCTION PURPOSES, THE LOCATION OF THE PIPE MUST BE VERIFIED AND PEGGED ON SITE BY THE PIPELINE OPERATOR BEFORE ANY EXCAVATION OR CONSTRUCTION WORK COMMENCES.

FOR FURTHER DETAILS PLEASE CONTACT FISHER GERMAN ON 01530 412821 REFERENCE NOS.....



Approximate position only
 Contact Pipeline Operator
 prior to works.

"This plan must not be copied or reproduced without prior written consent from the office of origin."

Reproduced from Ordnance Survey maps with the sanction of the Controller of HM Stationery Office Reference No. EP755672 Crown Copyright reserved

FISHER GERMAN
 CHARTERED SURVEYORS

Fisher German LLP, The Grange
 80 Tamworth Road, Ashby de la Zouch,
 Leicestershire, LE65 2BW
 Fax: (01530) 413896 and Telephone: (01530) 412821

**GPSS LOCATION PLAN
 EXTRACT OF PIPELINE B/A & C/B**

**DATE: FEBRUARY 2011
 NOT TO SCALE**

THIS DRAWING IS PROTECTED BY COPYRIGHT. IT MAY NOT BE REPRODUCED IN ANY FORM OR BY ANY MEANS FOR ANY PURPOSE WITHOUT WRITTEN PERMISSION OF FISHER GERMAN LLP CHARTERED SURVEYORS
 FISHER GERMAN LLP IS A LIMITED LIABILITY PARTNERSHIP.
 REGISTERED IN ENGLAND AND WALES. REGISTERED NUMBER: 0C3Y7554

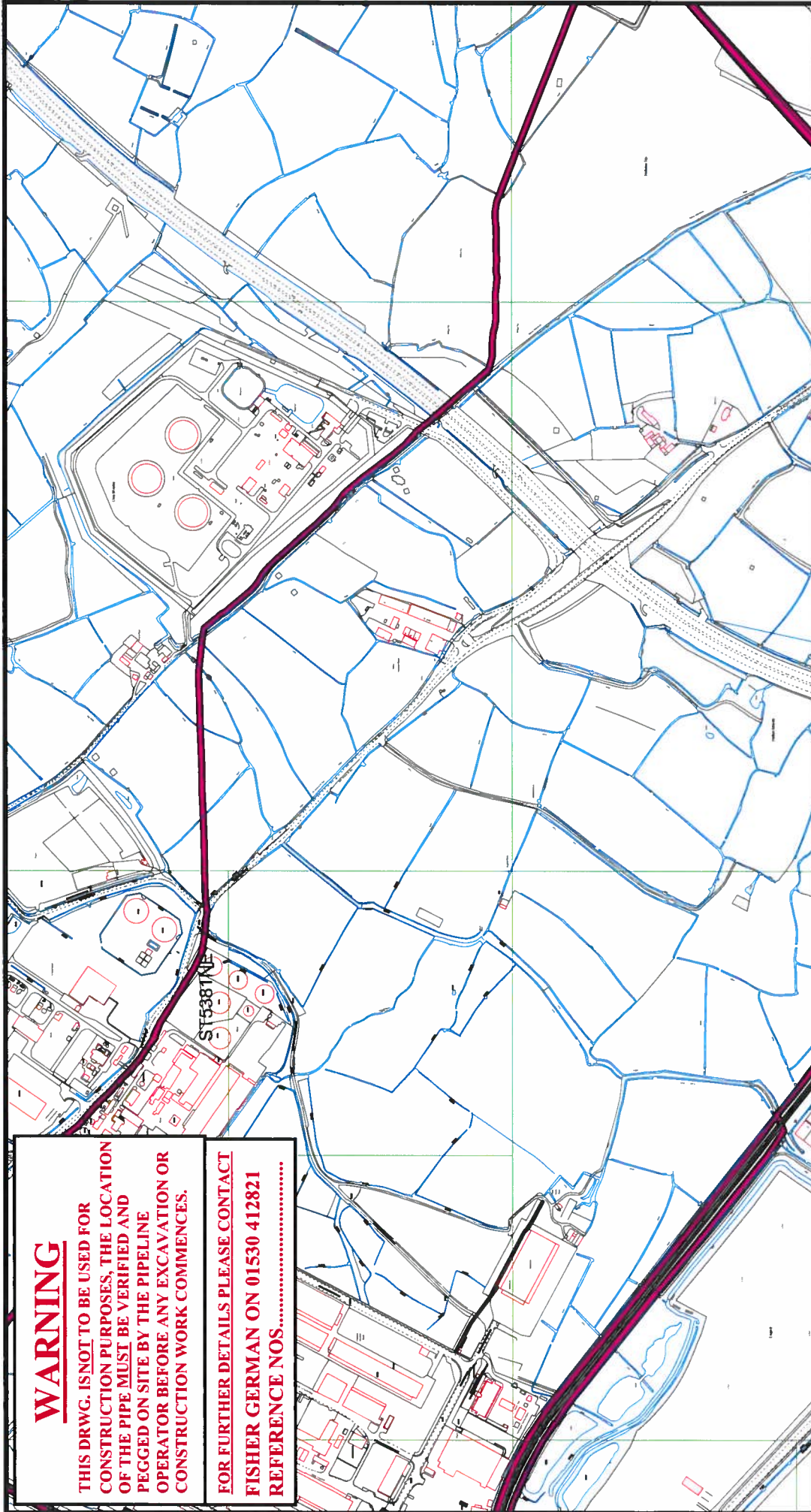

WARNING

THIS DRWG. IS NOT TO BE USED FOR CONSTRUCTION PURPOSES, THE LOCATION OF THE PIPE MUST BE VERIFIED AND PEGGED ON SITE BY THE PIPELINE OPERATOR BEFORE ANY EXCAVATION OR CONSTRUCTION WORK COMMENCES.

FOR FURTHER DETAILS PLEASE CONTACT

FISHER GERMAN ON 01530 412821

REFERENCE NOS.....



Approximate position only
Contact Pipeline Operator
prior to works.

"This plan must not be copied or reproduced without prior written consent from the office of origin."

Reproduced from Ordnance Survey maps with the sanction of the Controller of HM Stationery Office
Reference No. EP755672 Crown Copyright reserved



FISHER GERMAN
CHARTERED SURVEYORS

Fisher German LLP, The Grange
80 Tamworth Road, Ashby de la Zouch,
Leicestershire, LE65 2BW
Fax: (01530) 413896 and Telephone: (01530) 412821

**GPSS LOCATION PLAN
EXTRACT OF PIPELINE H/A(6) & C/B**

**DATE: FEBRUARY 2011
NOT TO SCALE**

THIS DRAWING IS PROTECTED BY COPYRIGHT. IT MAY NOT BE REPRODUCED IN ANY FORM OR BY ANY MEANS FOR ANY PURPOSE WITHOUT WRITTEN PERMISSION OF FISHER GERMAN LLP CHARTERED SURVEYORS
FISHER GERMAN LLP IS A LIMITED LIABILITY PARTNERSHIP
REGISTERED IN ENGLAND AND WALES. REGISTERED NUMBER: OC137364

WARNING

THIS DRWG. IS NOT TO BE USED FOR CONSTRUCTION PURPOSES, THE LOCATION OF THE PIPE MUST BE VERIFIED AND PEGGED ON SITE BY THE PIPELINE OPERATOR BEFORE ANY EXCAVATION OR CONSTRUCTION WORK COMMENCES.

FOR FURTHER DETAILS PLEASE CONTACT

FISHER GERMAN ON 01530 412821

REFERENCE NOS.....

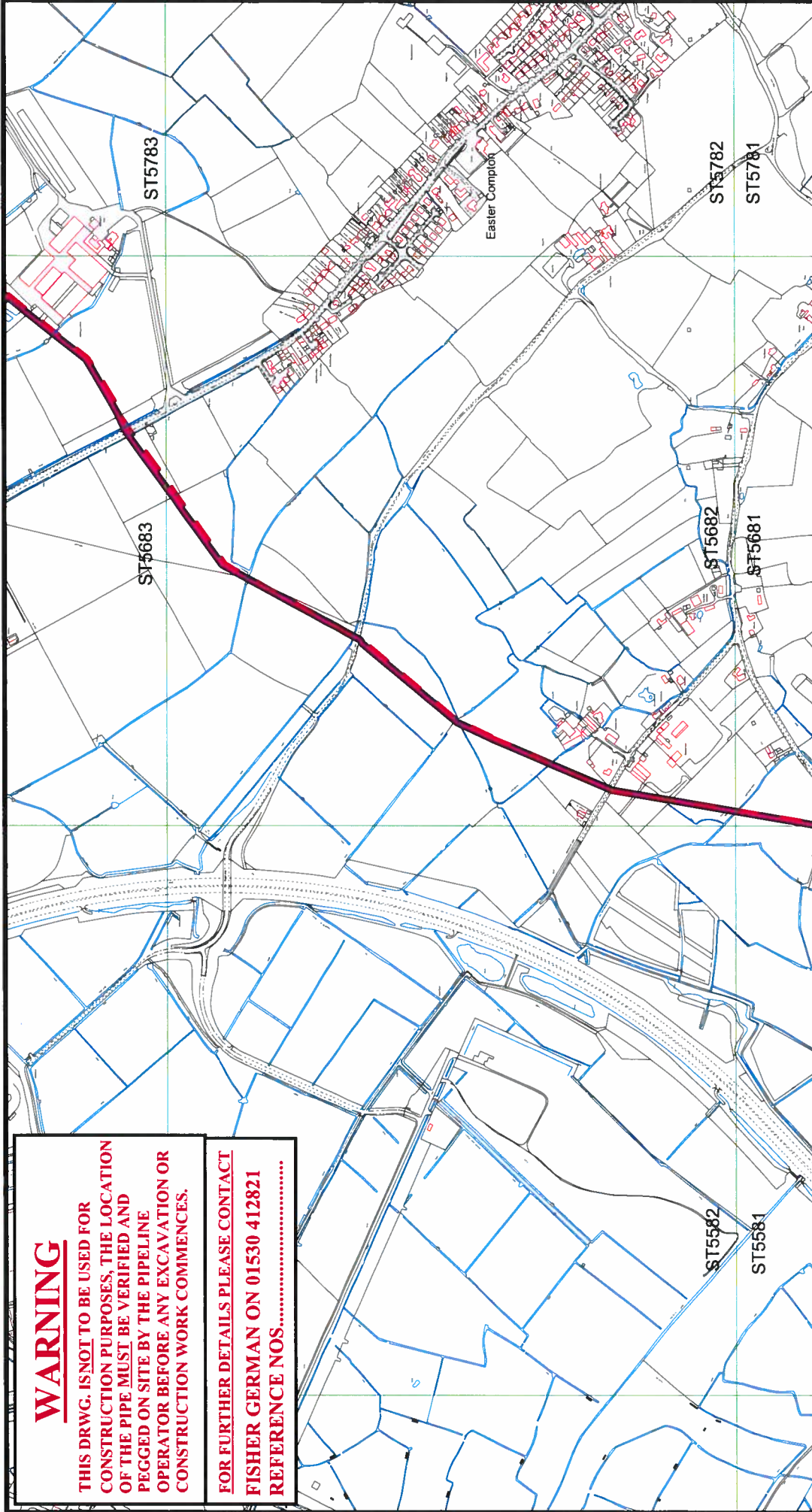

Approximate position only
Contact Pipeline Operator
prior to works.

"This plan must not be
copied or reproduced without
prior written consent from
the office of origin."

GPSS LOCATION PLAN EXTRACT OF PIPELINE N/S(S)



FISHER GERMAN
CHARTERED SURVEYORS

Fisher German LLP, The Grange
80 Tamworth Road, Ashby de la Zouch,
Leicestershire, LE65 2BW
Fax: (01530) 413896 and Telephone: (01530) 412821



















DATE: FEBRUARY 2011

NOT TO SCALE

Reproduced from Ordnance Survey maps with the
sanction of the Controller of HM Stationary Office
Reference No. EP755672 Crown Copyright reserved

THIS DRAWING IS PROTECTED BY COPYRIGHT. IT MAY NOT BE REPRODUCED IN
ANY FORM OR BY ANY MEANS FOR ANY PURPOSE WITHOUT WRITTEN
PERMISSION OF FISHER GERMAN LLP CHARTERED SURVEYORS
FISHER GERMAN LLP IS A LIMITED LIABILITY PARTNERSHIP.
REGISTERED IN ENGLAND AND WALES. REGISTERED NUMBER: 06317564





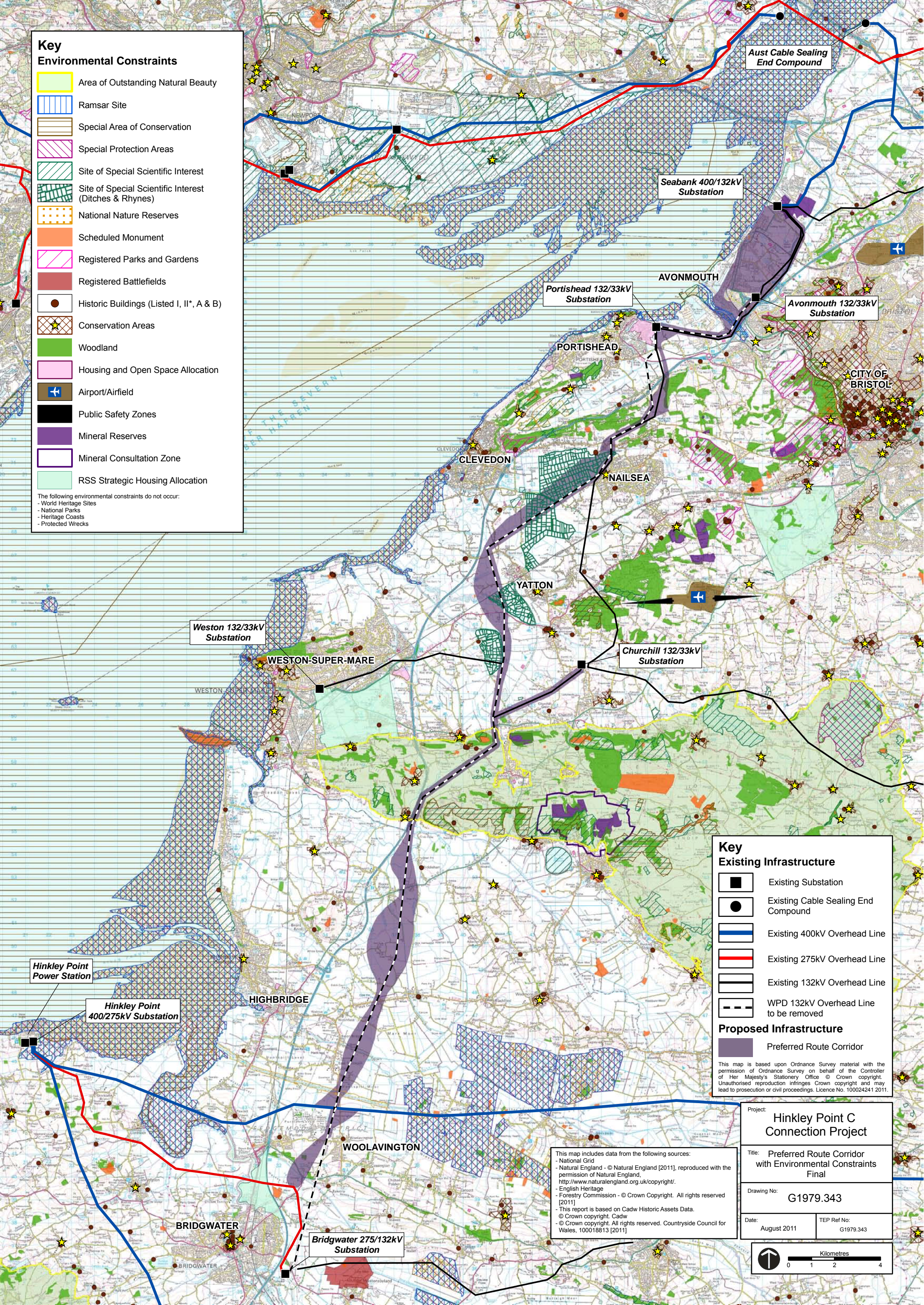

Key
Environmental Constraints

-  Area of Outstanding Natural Beauty
-  Ramsar Site
-  Special Area of Conservation
-  Special Protection Areas
-  Site of Special Scientific Interest
-  Site of Special Scientific Interest (Ditches & Rhynes)
-  National Nature Reserves
-  Scheduled Monument
-  Registered Parks and Gardens
-  Registered Battlefields
-  Historic Buildings (Listed I, II*, A & B)
-  Conservation Areas
-  Woodland
-  Housing and Open Space Allocation
-  Airport/Airfield
-  Public Safety Zones
-  Mineral Reserves
-  Mineral Consultation Zone
-  RSS Strategic Housing Allocation

The following environmental constraints do not occur:
 - World Heritage Sites
 - National Parks
 - Heritage Coasts
 - Protected Wrecks



Key
Existing Infrastructure

-  Existing Substation
-  Existing Cable Sealing End Compound
-  Existing 400kV Overhead Line
-  Existing 275kV Overhead Line
-  Existing 132kV Overhead Line
-  WPD 132kV Overhead Line to be removed

Proposed Infrastructure

-  Preferred Route Corridor

This map is based upon Ordnance Survey material with the permission of Ordnance Survey on behalf of the Controller of Her Majesty's Stationery Office © Crown copyright. Unauthorised reproduction infringes Crown copyright and may lead to prosecution or civil proceedings. Licence No. 10002424 2011.

This map includes data from the following sources:
 - National Grid
 - Natural England - © Natural England (2011), reproduced with the permission of Natural England, <http://www.naturalengland.org.uk/copyright/>.
 - English Heritage
 - Forestry Commission - © Crown Copyright. All rights reserved [2011]
 - This report is based on Cadw Historic Assets Data.
 © Crown copyright. Cadw
 © Crown copyright. All rights reserved. Countryside Council for Wales, 100018813 [2011]

Project: **Hinkley Point C Connection Project**

Title: **Preferred Route Corridor with Environmental Constraints Final**

Drawing No: **G1979.343**

Date: August 2011 TEP Ref No: G1979.343

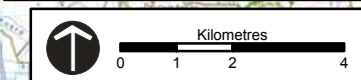

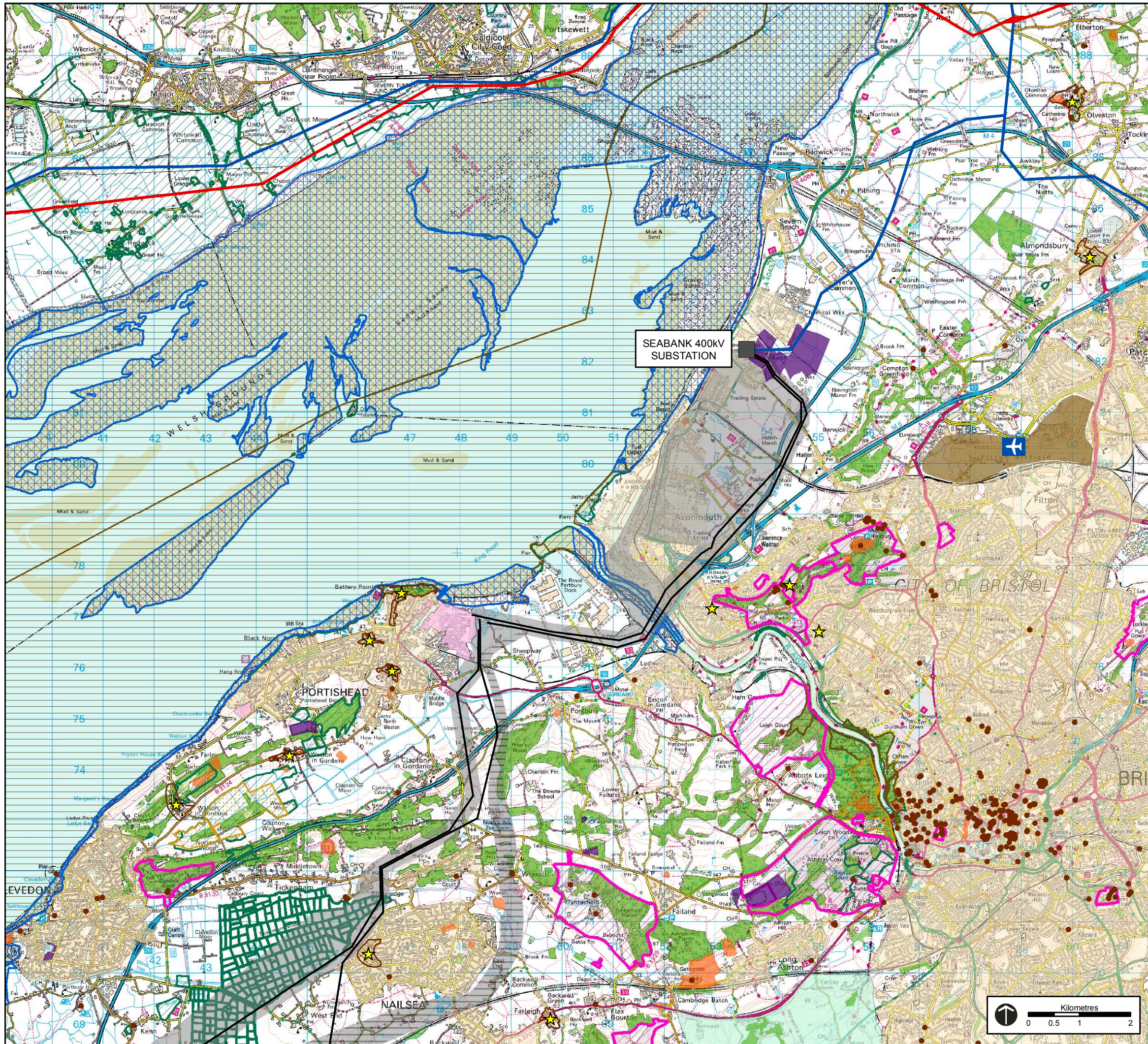

Key

Existing Infrastructure

- Existing Substation
- Existing 400kV Overhead Line
- Existing 275kV Overhead Line
- Existing 132kV Overhead Line
- Administrative Boundary
- Route Corridor 1
- Route Corridor 2

Environmental Constraints

- Area of Outstanding Natural Beauty
- Ramsar Site
- Special Protection Areas
- Special Area of Conservation
- Site of Special Scientific Interest
- Site of Special Scientific Interest (Ditches & Rhynes)
- National Nature Reserves
- Scheduled Monument
- Registered Parks and Gardens
- Registered Battlefields
- Historic Buildings (Listed I, II*, A & B)
- Conservation Areas
- Woodland
- Settlement
- Housing and Public Open Space Allocation in Development Plan
- RSS Strategic Housing Allocations
- Airport/Airfield
- Public Safety Zones
- Mineral Consultation Zone
- Mineral Reserves

NOTE 1:

The following environmental constraints considered in routing do not occur in the study area:
 - National Parks
 - Heritage Coasts

FOR PUBLIC CONSULTATION



Genesis Centre
 Birchwood Science Park
 Warrington WA3 7BH
 Tel 01925 844004
 Fax 01925 844002
 email tep@tep.uk.com

Project:	Hinkley C Connections	
Title:	Route Corridors Inset 3	
Drawing No:	Figure 5c	
Date:	28-08-09	TEP Ref No: G1979.051e
Drawn: CM	Checked: CC	Approved: CC

This map is based upon Ordnance Survey material with the permission of Ordnance Survey on behalf of the Controller of Her Majesty's Stationery Office © Crown copyright. Unauthorised reproduction infringes Crown copyright and may lead to prosecution or civil proceedings. Licence No. 10002421 2009.

Key

Study Area

Listed Buildings

Grade I

Grade II*

Grade II

Scheduled Monuments

BCC Historic Environment Record

Monuments

Events

SGC Sites & Monuments Record



Bristol City and South Gloucestershire Councils

Avonmouth and Severnside Study

Historic Environment

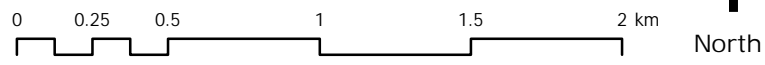
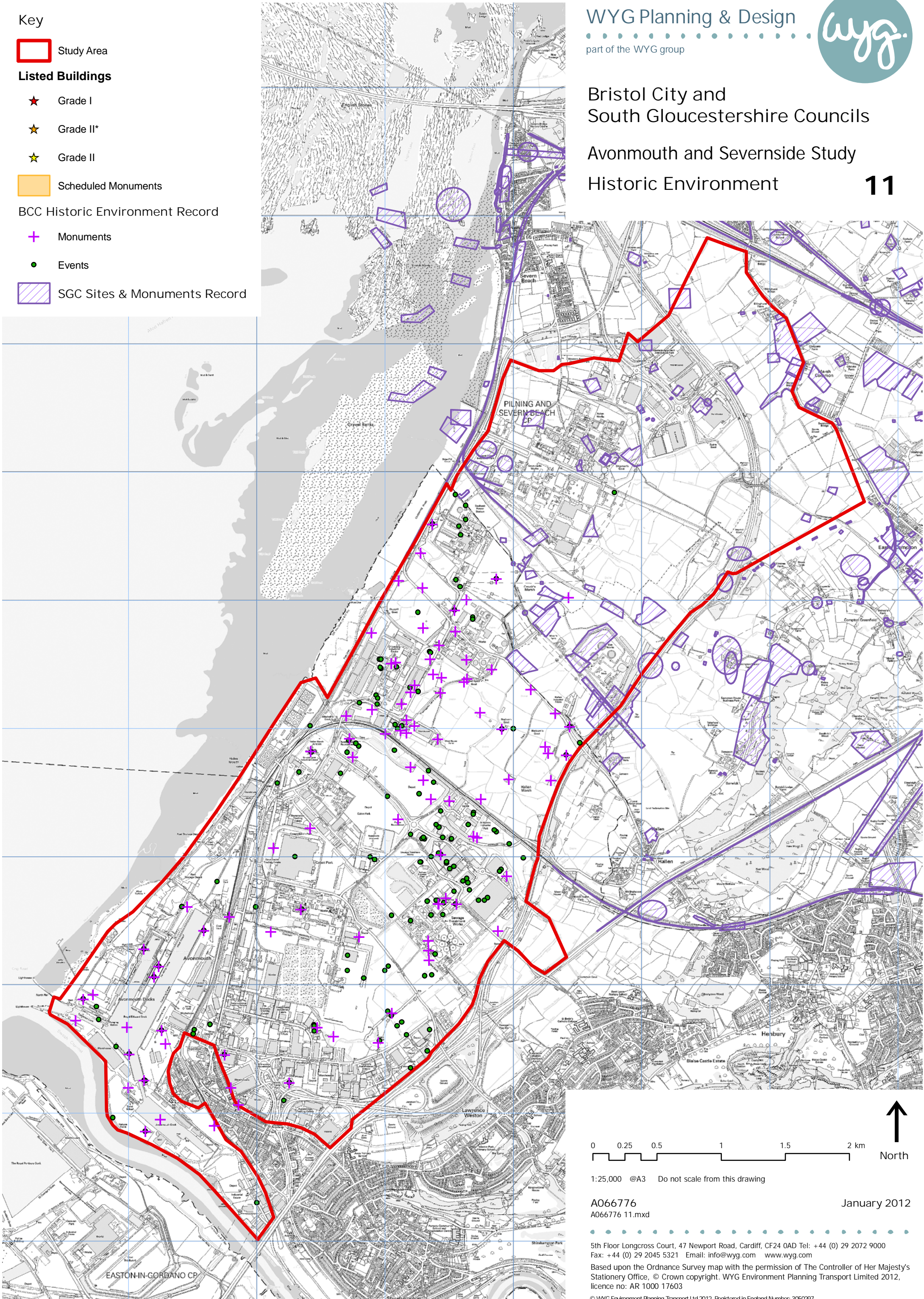









1:25,000 @A3 Do not scale from this drawing

A066776
A066776 11.mxd

January 2012

Key

-  Study Area
-  Important Bird Areas
-  Special Areas of Conservation
-  Special Protection Area and Ramsar site
-  SSSI
-  Regionally Important Geological Sites
-  Wildlife Network Sites
-  Sites of Nature Conservation Interest



Bristol City and South Gloucestershire Councils

Avonmouth and Severnside Study

Ecological / Geological Designations

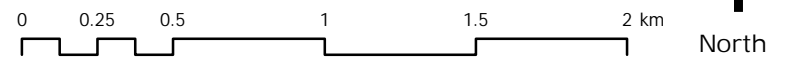
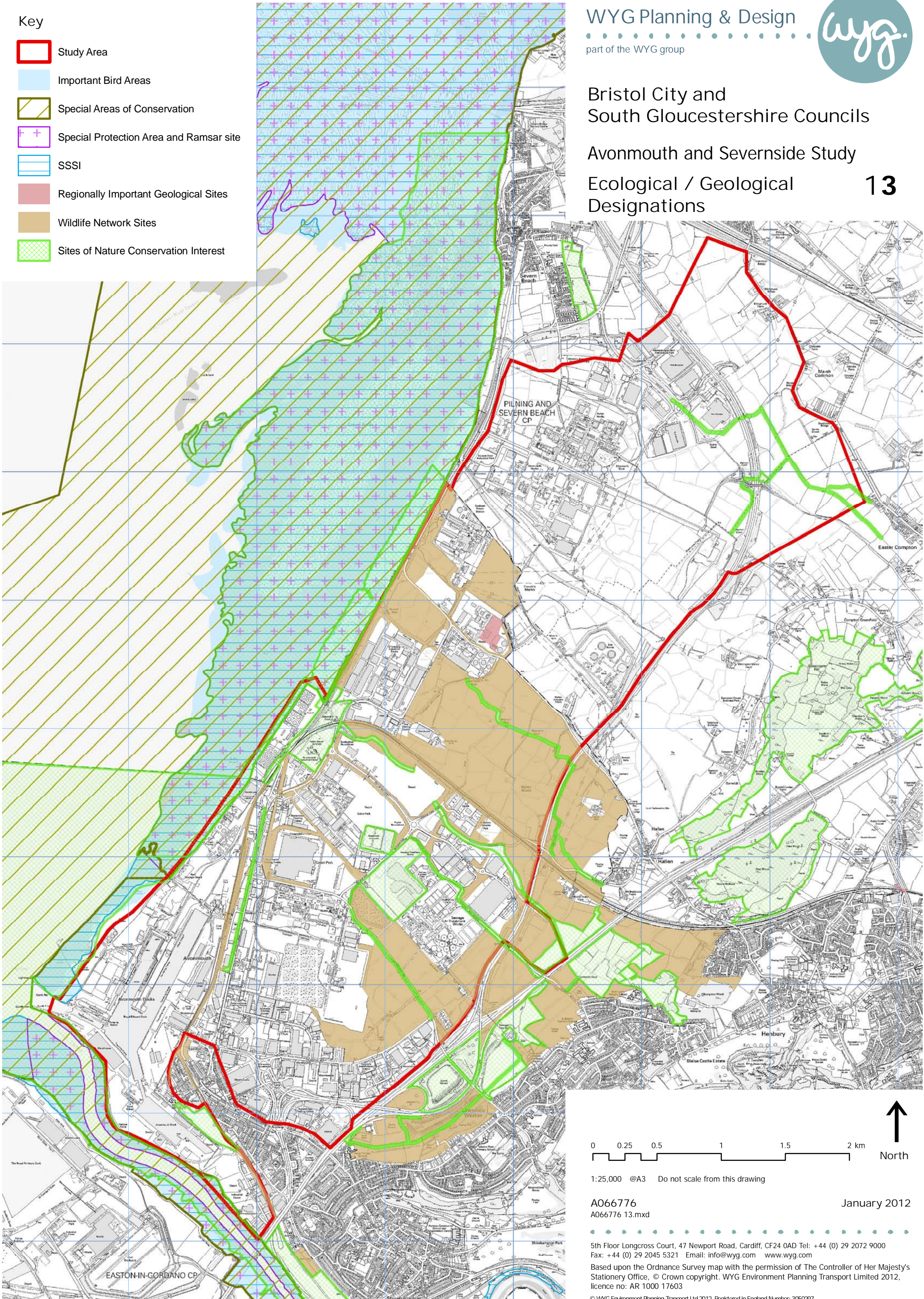

1:25,000 @A3 Do not scale from this drawing

A066776
A066776 13.mxd

January 2012

5th Floor Longcross Court, 47 Newport Road, Cardiff, CF24 0AD Tel: +44 (0) 29 2072 9000
Fax: +44 (0) 29 2045 5321 Email: info@wyg.com www.wyg.com

Based upon the Ordnance Survey map with the permission of The Controller of Her Majesty's Stationery Office, © Crown copyright. WYG Environment Planning Transport Limited 2012, licence no: AR 1000 17603

© WYG Environment Planning Transport Ltd 2012 Registered in England Number: 3050297