

SHR-5040/5080/5160 SHR-5042/5082/5162

4/8/16 Channel Standalone Digital Video Recorders

SHR-5042

- Compression : MPEG4(Video) / G.726(Audio)
- REC Speed : CIF 120/100 (N/P)
- Internal HDD (HDDX1)
*SHR-5040 : Max 2 internal HDD (HDDx2)



SHR-5082

- Compression : MPEG4(Video) / ADPCM(Audio)
- REC Speed : CIF 120/100 (N/P)
- MAX 3 Internal HDD (HDDX3)
*SHR-5080 : Max 4 internal HDD (HDDx4)



SHR-5160/5162

- Compression : MPEG4(Video) / ADPCM(Audio)
- REC Speed : CIF 120/100 (N/P)
- MAX 3 Internal HDD (HDDX3)
*SHR-5160 : Max 4 internal HDD (HDDx4)



Features

- Video recording up to 120/100ips and 4 channel audio recording
- Recording and network transmission via each codec by adopting dual codec.
- Exclusive video processor: image quality improved by more than 30% compared to existing products.
- Various backup functions through USB 2.0
: USB memory, external HDD, external CD-RW (SHR-5042), DVD-RW (SHR-5082/5162).
- Various video outputs supported.
- Simultaneous VGA and composite output.
- Watermark function for preventing video alteration.
- Remote monitoring and control through network: Ethernet, cable network, xDSL.
- Convenient IR remote controller and mouse (SHR-504x: only remote controller available).
- Smooth backup by using built-in DVD-RW (SHR-5082/5162).
- Convenient user interface

Dimensions (unit:mm)

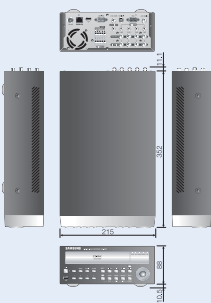

SHR-5042/5040

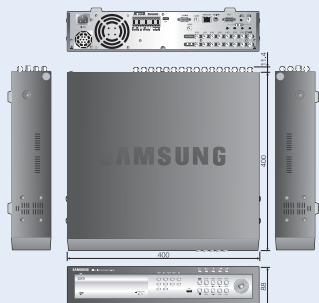

SHR-5082/5080

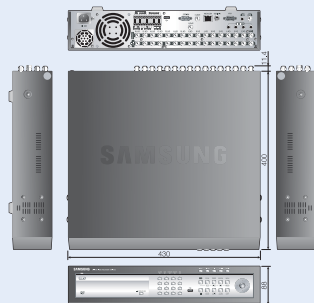

SHR-5162/5160

SHR-5040/5080/5160 SHR-5042/5082/5162

4/8/16 Channel Standalone Digital Video Recorders

Specifications

Model			SHR-5040/5042	SHR-5080/5082	SHR-5160/5162
Video	Input	Composite	4 Channels, 1Vp-p, 75 Ohm	8 Channels, 1Vp-p, 75 Ohm	16 Channels, 1Vp-p, 75 Ohm
	Output	Composite	2 channels (Normal 1 Channel, Spot 1 Channel)		
		S-Video	1 Channel	1 Channel	
		VGA	1 Channel	1 Channel	
	Loop Through	4 Channels	8 Channels	16 Channels	
Audio	Input / Output		Mono 4 Channels, RCA / 1 Channel, RCA		
Live Screen	Resolution		720 x 480		
	Display Speed		120ips / 100ips		
Recording	Display Mode		Single, 4, PIP, Sequence, Freeze, 2x Zoom		
	Compression Method		MPEG4/ADPCM		
	Video Compression Rate (Kbyte/image)	Level 8	Very High : 14.9K(B/D1), 8.8K(Half D1), 4.1K(CIF)		
		Level 7	High : 11.0K(B/D1), 6.9K(Half D1), 3.1K(CIF)		
		Level 6	Standard : 9.3K(B/D1), 4.5K(Half D1), 2.3K(CIF)		
		Level 5	Low : 9.0K(B/D1), 3.8K(Half D1), 1.6K(CIF)		
		Level 4	-		
		Level 3	-		
		Level 2	-		
	Level 1	-			
	Resolution		CIF, Half D1, Full D1		
	Max. Recording Speed(N/P)		CIF:120/100ps, Half D1:60/50ps, Full D1:30/25ps		
	Recording Mode		Events (Alarm, Motion Detection, Video Loss), Schedule Recording, Time Lapse		
Network Transmission	Compression Method		MPEG4/ADPCM		
	Video Compression Rate (Kbyte/image)	Very High	NTSC : 9.8K(Half D1), 4.9K(CIF) / PAL : 11.7K(Half D1), 5.9K(CIF)		
		High	NTSC : 7.3K(Half D1), 3.7K(CIF) / PAL : 8.8K(Half D1), 4.4K(CIF)		
		Standard	NTSC : 4.9K(Half D1), 2.4K(CIF) / PAL : 5.9K(Half D1), 2.9K(CIF)		
		Low	NTSC : 2.4K(Half D1), 1.2K(CIF) / PAL : 2.9K(Half D1), 1.5K(CIF)		
Resolution		CIF, Half D1, Full D1			
Search and Play	Search Mode		Date/Time Search, Search by Camera, Event Search (Alarm, Motion Detection, Video Loss), First/ Latest/ Backup Search		
	Display Mode		Single, 4, 9 (4 Play Screens, 4 Live Screens)		
Event	Play Mode		Play, Pause, Stop		
	Alarm Function/Alarm Input/Alarm Output		Remote Callback / 4 Channels / 2 Channels		
	Alarm Output Continuation Time		Alarm continues until it is turned off		
	Motion Detection		Area Setup (5 steps)		
	Pre Event Set Time		3, 4, 5 sec		
Water Mark	Post Event Set Time		5, 10, 20, 30 sec, 1, 3, 5 Min		
			Yes		
	HDD		Yes		
CD-RW / DVD-RW	Default	250G (SHR-5040:160G)			
	Extension	250G / 250Gx2			
Backup	Interface		CD-RW(SHR-5042) / -(SHR-5040)		
	Media		DVD-RW(SHR-5082) / -(SHR-5080)		
	File Format		DVD-RW(SHR-5162) / -(SHR-5160)		
External Port	RS-485		USB 2.0 2 Ports (1 at the front , 1 at the rear)		
			CD-RW, External HDD, USB Memory		
			AVI		
USB Mouse / Remote Controller / Network		PTZ Control			
		PTZ Control, System Keyboard			
		- / Yes / Static IP, DHCP, ADSL (PPPoE)			
Operating Temp. / Operating Humidity		0°C~ 40°C / 25% ~ 80% RH			
Power Requirement / Power Consumption		0°C~ 40°C / 20% ~ 80% RH			
		AC 100~240V, 50/60Hz / 28W			
		AC 100~230V, 50/60Hz / 60W			
Weight / Outline Dimension		4.0Kg / 215(W) x 88(H) x 352(D)mm			
		7.3Kg / 430(W) x 88(H) x 400(D)mm			



SAMSUNG ELECTRONICS CO., LTD.

Digital AV Division
VSS marketing, 416, Maetan 3 Dong, YeongTong-Gu, Suwon City, Kyeonggi-Do, Korea, 443-742
Tel: +82-31-277-3342~3347 Fax: +82-31-277-6597 <http://www.securitysamsung.com>

* Design and specifications are subject to change without notice

Distributed by



SHR-5040/5042



SHR-5080/5082

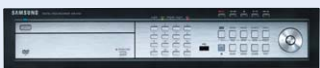

SHR-5160/5162

imagine a DVR that allows
separate recording and
transmission of field images
by using a dual codec system



Dual Codec SHR-5000 Series



The SHR-5000 Series DVR is a standalone system that can record up to 120/100 images per second from 4, 8 and 16 channels using MPEG4 compression. It is able to simultaneously record to and play from a hard drive in real time by compressing the audio of 4 channels with ADPCM (Adaptive Differential Pulse Code Modulation). Using dual codecs, the SHR-5000 Series DVR can smoothly record and transmit through a network, allowing continuous remote monitoring even in a poor network environment. It provides backup functions through its USB 2.0 interface. In addition, it maximizes user convenience by implementing ATM and POS interlocking, motion detection, various split screens a PIP function as well as various video output functions.

Dual Codec allows stabilized transmission in a low bandwidth network environment

The SHR-5000 Series DVR uses separate Codecs to record videos and to transmit them via a network. This allows high-definition video to be recorded to a HDD and continuous remote monitoring to occur in a low band network environment.

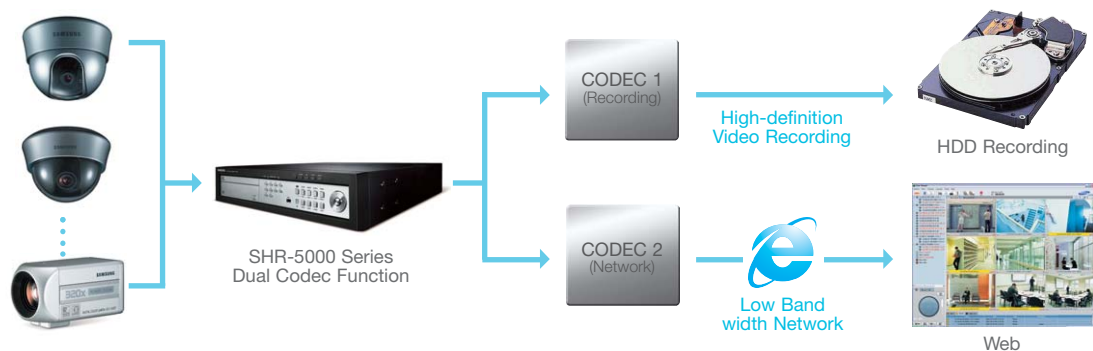

DVRs that enhance the surveillance environment by improving the network transmission of high-definition video

Maximized Compression Efficiency

The SHR-5000 Series DVRs use less storage space on HDD by approximately 35% by using an innovative integrated circuit design which maximizes video compression.



Built-in DVD-RW

The SHR-5082/5162 with a built-in DVD-RW can easily back up video recorded by the DVR. (The SHR-5042 used a built-in CD-RW)

*DVD Backup: 4.0GB / CD Backup: 700MB



Web based Monitoring & Search

The SHR-5000 Series DVR comes with a built-in web server in the DVR. This allows remote connection to the DVR through a web browser without the need of a separate program, maximizing user convenience.



Monitoring with Network-Integrated Viewer (NetI)

The SHR-5000 Series DVR can be monitored with NetI, Samsung Electronics, integrated viewing solution, allowing easy set up of a video management network.

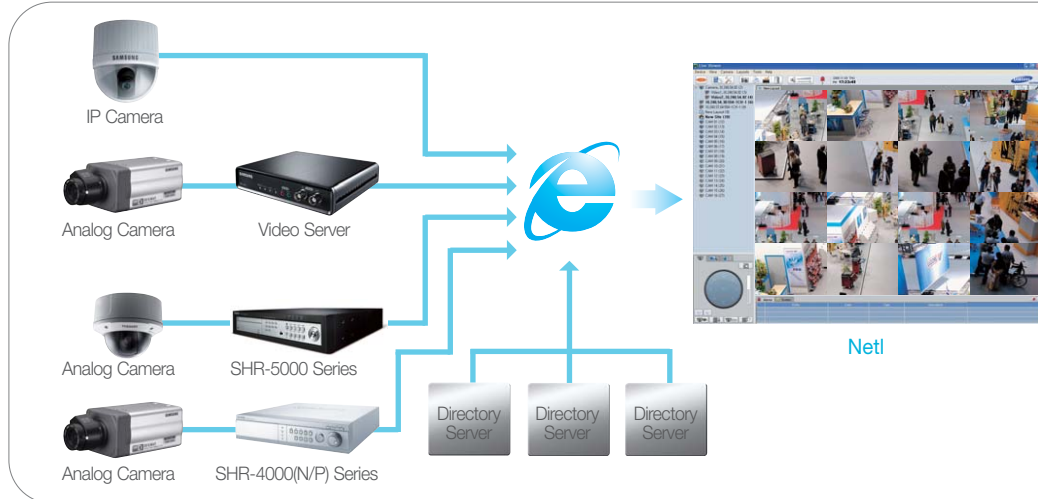

File Size by Resolution and Compression Rate

Resolution		CIF	Half D1
Compression Rate (Average)	Very High	4.9	9.8
	High	3.7	7.3
	Normal	2.4	4.9
	Low	1.2	2.4

*The file size may be changed according to the type of the input video signal.

Simultaneous BNC and VGA Output

For user convenience the SHR-5000 Series DVRs simultaneously output video for both LCD monitors and CRT monitors

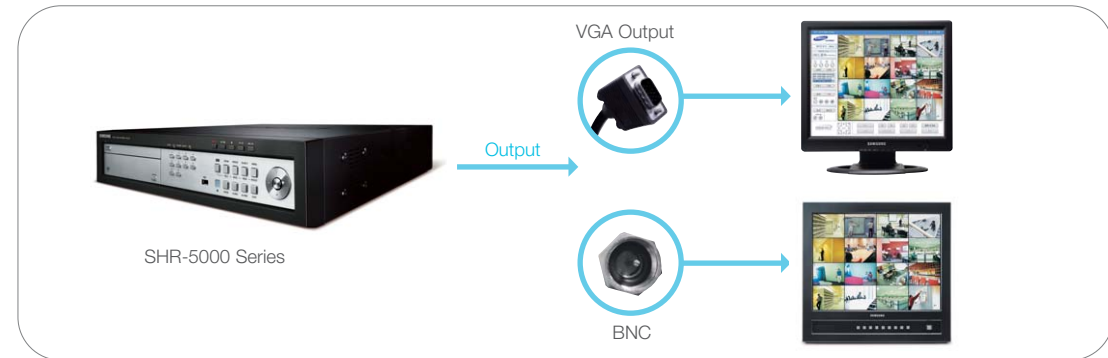

Provides UI for User Convenience



MENU SETUP SCREEN

- Monitoring and recording up to 480/400ips and 120/100ips respectively
- Live display of up to 480/400ips and recording of up to 120/100ips



SEARCH SCREEN

- Search by Calendar and Event
- Search by Time and Date or by Event



Remote Monitoring Screen

- Remote DVR management function
- Callback function
- Allowing simultaneous connection up to 3 users

